

PERMIT

SEWAGE DISPOSAL SYSTEM

DEPARTMENT OF HEALTH AND MENTAL HYGIENE

INDEXED

P57014

A 49993-P

DISTRICT _____

DATE 7/3/96

HOWARD COUNTY HEALTH DEPARTMENT

BUREAU OF ENVIRONMENTAL HEALTH

~~461-9933~~ 313-2640

DATE SYSTEM APPROVED 7/24/96

INSPECTOR ALM

K&K EXCAVATING - OLEN KETTERMAN

IS PERMITTED TO INSTALL ALTER _____

ADDRESS 14960 Route 144, Woodbine, MD 21797

PHONE 442-1336

SUBDIVISION Easternview

LOT 13

ROAD 11719 JANNEY COURT
7346 Pindell School Road

PROPERTY OWNER Mr. John Janney

ADDRESS _____

SEPTIC TANK CAPACITY 1000 GALLONS

*Existing septic tank may be used if it is outside the 100 foot well radius of all neighboring proposed existing wells.

NUMBER OF BEDROOMS 3

180 SQUARE FEET PER BEDROOM

*Existing well must be abandoned prior to septic installation. Call for inspection of abandonment procedures.

LINEAR FEET OF TRENCH REQUIRED 180

TRENCHES - Trench to be 3 feet wide. Inlet 3 feet below original grade. Bottom maximum depth 5 feet below original grade. Effective area begins at 3 feet below original grade. 2 feet of stone below distribution pipe.

LOCATION - Begin system 75' off the right lot line and 105' off the front lot line as seen when facing the lot from the original driveway. Run trenches on contour toward the left lot lines.

NOTES - No trench to exceed 100 feet in length. Provide 6" - 8" diameter cleanout and cap to grade or above on septic tank. 7/9/96 OR ALM

PLANS APPROVED BY Amy McMillen

DATE 7/9/96

COVER NO WORK UNTIL INSPECTED AND APPROVED

NEITHER THE HOWARD COUNTY COUNCIL NOR THE HEALTH DEPARTMENT IS RESPONSIBLE FOR THE SUCCESSFUL OPERATION OF ANY SYSTEM

NOTE: CLEANOUT REQUIRED EVERY 70 FEET OF SEWER LINE AND/OR AT 90° SWEEPS IN LINES FROM HOUSE TO DRAIN FIELDS, 90° ELBOWS NOT ACCEPTABLE.

NOTE: ALL PARTS OF SEPTIC SYSTEMS (I.E. TANK, DISTRIBUTION BOX TRENCHES) TO BE 100 FEET FROM WELL (UNLESS OTHERWISE SPECIFICALLY AUTHORIZED)

NOTE: IF DEEP TRENCH(ES) ARE USED CALL FOR INSPECTION BEFORE AND AFTER PLACING GRAVEL IN TRENCH(ES)

NOTE: NO DRY WELL SHALL EXCEED 15 FOOT IN DIAMETER NO ABSORPTION TRENCH TO EXCEED 100 FEET IN LENGTH

NOTE: ALL PIPE FROM HOUSE TO SEPTIC TANK MUST BE CAST IRON OR SCHEDULE 35/40 PVC OR ABS

PERMIT VOID AFTER TWO YEARS

NOTE: INSTALL STAND PIPE ON SEPTIC TANK AND DRY WELL STAND PIPES MUST BE 6 INCHES IN DIAMETER CAST IRON. CONCRETE OR TERRA COTTA OR PVA OR ABS ACCEPTED. IF TOP OF SEPTIC TANK IS DEEPER THAN 3 FEET. MANHOLE TO GRADE REQUIRED.

NOTE: DISTRIBUTION BOXES MUST HAVE BAFFLES

***INSTALLER IS RESPONSIBLE FOR OBTAINING FINAL APPROVAL ON THIS PERMIT**

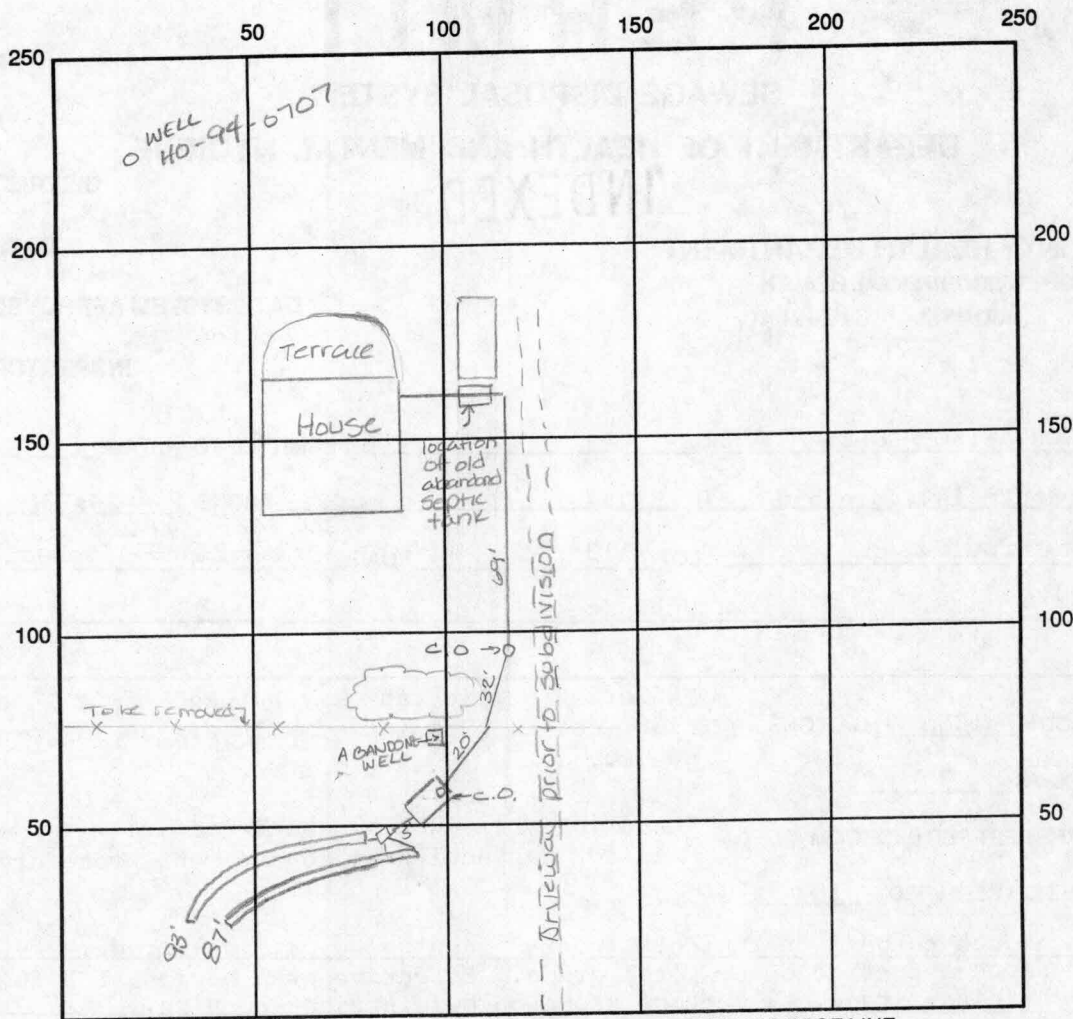

INDICATE NORTH - NAME ADJOINING ROADWAY AS BASE LINE

SEPTIC TANK LEVEL OK 1500 gal CLEANOUTS OK

DISTRIBUTION BOX LEVEL OK baffle is in

DRAIN FIELD/TITLE DEPTH 5'6" FT. TRENCH WIDTH 3.0 FT. INLET DEPTH 3.0 to 4.0 FT.

EFFECTIVE GRAVEL DEPTH 2.0 FT. TOTAL LENGTH 180 FT.

NUMBER OF TRENCHES 2 ONE SIDEWALL/BOTTOM AREA 540 SQ. FT. 480
0/100

DRYWALL INSIDE DIAMETER FT. EFFECTIVE DEPTH BELOW INLET FT.

ABSORBENT AREA SQ. FT.

REMARKS: 7/24/96 old septic tank was pumped and filled - OK to cover
all work - well was also properly abandoned ALM

DATE SYSTEM APPROVED 7/24/96 INSPECTOR Amy McMullen