

LAYOUT 5/30/08 INSP 4 _____
INSP 2 _____ INSP 5 _____
INSP 3 _____ INSP 6 _____

ISSUE DATE: _____

PERMIT *(Log 2nd)*

P 528908

APPROVAL DATE: 6/12/08

A _____

TAX ID # 04371275

ON-SITE SEWAGE DISPOSAL SYSTEM HOWARD COUNTY HEALTH DEPARTMENT BUREAU OF ENVIRONMENTAL HEALTH

SK Plumbing IS PERMITTED TO INSTALL ALTER

ADDRESS: _____ PHONE NUMBER: _____

SUBDIVISION: The Chase At Storey Brook LOT NUMBER: 4

ADDRESS: 1832 Irish Eyes Lane PROPERTY OWNER: Trinity Quality Homes

SEPTIC TANK CAPACITY (GALLONS): 2000 OUTLET BAFFLE FILTER REQUIRED

PUMP CHAMBER CAPACITY (GALLONS): _____ COMPARTMENTED TANK REQUIRED

NUMBER OF BEDROOMS: 4

Trench 2' wide

SQUARE FEET PER BEDROOM: _____

Inlet @ 3' 8'E.T.F

LINEAR FEET OF TRENCH REQUIRED: ~~200~~ 210'

Bottom @ 7'

TRENCHES:	Trench to be 3.0 feet wide. Inlet 3.5 feet below original grade. Bottom maximum depth 5.5 feet below original grade. Effective area begins at 4.5 feet below original grade. 2.0 feet of stone below distribution pipe.
LOCATION:	Install distribution box on top right corner of SDA as shown on plan.
NOTES:	Install per plan unless directed by HCHD. Layout inspection required prior to installation. 45' herd needed between house and tank. Tank no deeper than 3' below grade.

PLANS APPROVED: Sara Sappington DATE: 2/25/08

- NOTE: PERMIT VOID AFTER 2 YEARS
- NOTE: CONTRACTOR RESPONSIBLE FOR SCHEDULING A PRE-CONSTRUCTION INSPECTION FOR ALL INSTALLATIONS
- NOTE: WATERTIGHT SEPTIC TANKS REQUIRED
- NOTE: ALL PARTS OF SEPTIC SYSTEM SHALL BE 100 FEET FROM ANY WATER WELL
- NOTE: MANHOLE RISERS REQUIRED ON ALL SEPTIC TANKS AND PUMP CHAMBERS UNLESS SPECIFICALLY AUTHORIZED

NEITHER THE HOWARD COUNTY COUNCIL NOR THE HEALTH DEPARTMENT IS RESPONSIBLE FOR THE SUCCESSFUL OPERATION OF ANY SYSTEM PERMITTEE RESPONSIBLE FOR OBTAINING FINAL APPROVAL ON THIS PERMIT CALL 410-313-1771 FOR INSPECTION OF SEPTIC SYSTEM

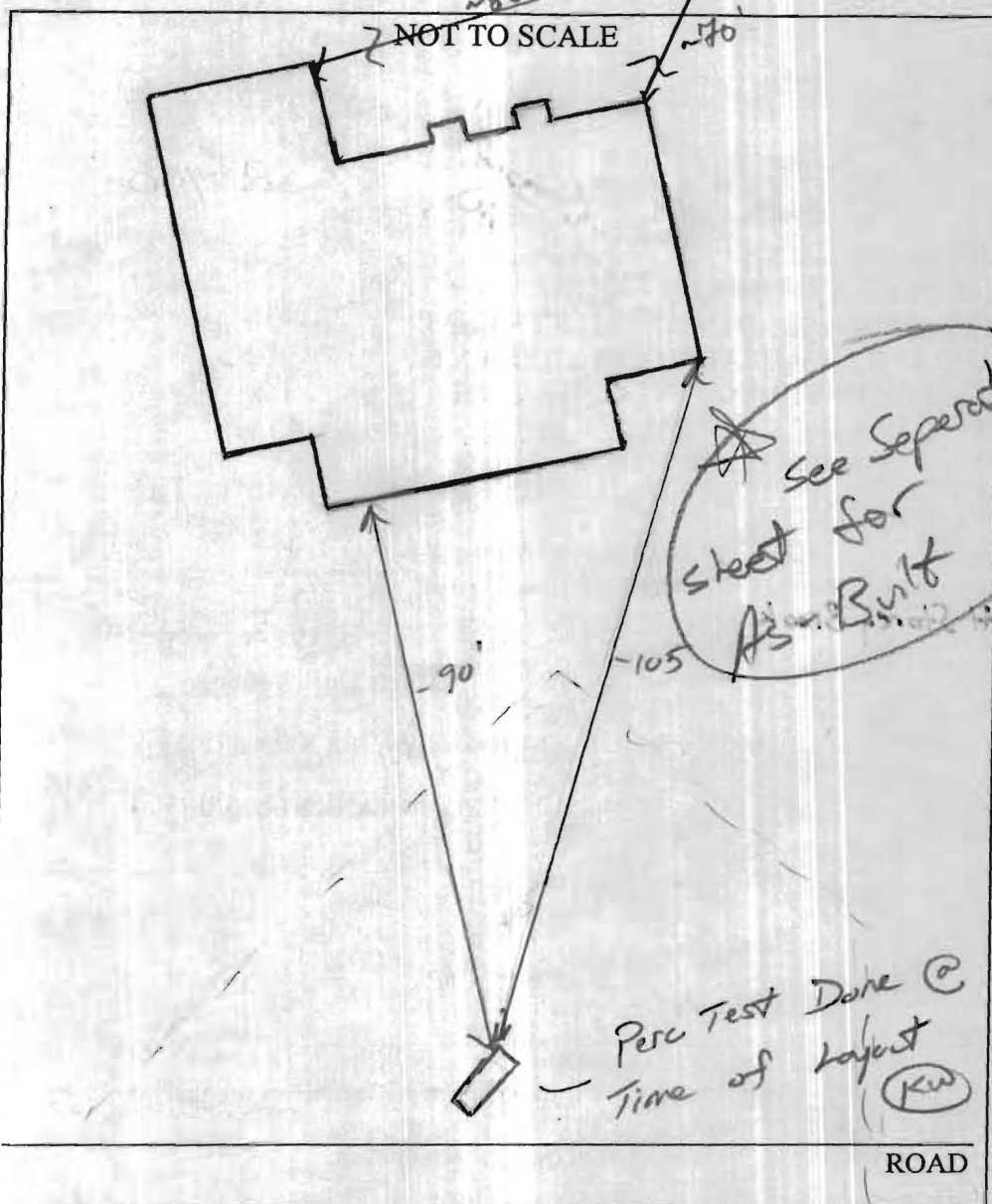

TRENCH/DRAINFIELD DATA		
WIDTH	INLET	BOTTOM
2'	3'	7'
NUMBER OF TRENCHES		3
TOTAL LENGTH		214'
ABSORPTION AREA		434 + SW
DISTRIBUTION BOX LEVEL		Level to
DISTRIBUTION BOX BAFFLE		Yes
DISTRIBUTION BOX PORT		Yes

SEPTIC TANK DATA		
SEPTIC TANK 1 LEVEL		Yes
CAPACITY	2000	GAL
SEAM LOC	Top	
TANK LID DEPTH	2'-2.5'	
BAFFLES	Yes	
BAFFLE FILTER		
MANHOLE LOC	Front/Back	
6" PORT LOC	None	
WATERTIGHT TEST		
SEPTIC TANK 2 LEVEL		
CAPACITY		GAL
SEAM LOC		
TANK LID DEPTH		
BAFFLES		
BAFFLE FILTER		
MANHOLE LOC		
6" PORT LOC		
WATERTIGHT TEST		

Babylon Slotted

See Separat sheet for As-Built

Perc Test Done @ Time of layout (KW)

PRE-CONSTRUCTION 5/30/08 Perc test hole dug as shown above in support of new spec's for system. Contractor to install 3x 40' trenches on INSTALLATION contour running away from house. OK to start 80' or so out of SDA to avoid dip @ btm right corner of SDA. Tank may be set < 20' to house if builder accepts responsibility of extent. Call for inspection (KW) 6/12/08 System completed. S.T. set < 20' from house. Builder OK'd and shall send letter along w/ file for approval. OK to backfill. (KW)

FINAL INSPECTOR Ku Wolf DATE OF APPROVAL 6/12/08

Prop.
Drive

1832 Irish Eyes Ln.

Lot (4)

~88'

~70'



NOT TO SCALE

1832 Irish Eyes Ln

120'

8' ETE

8' ETE

74'

72'

70'

