

3/28/78  
9:30 AM  
Final check  
3/30/78

02-214768

Final 3/28/78 0/ See below

# PERMIT

P 27717

A REPAIR

② P.C.O

SEWAGE DISPOSAL SYSTEM  
MARYLAND STATE DEPARTMENT OF HEALTH\*

HOWARD COUNTY

## INDEX

ELLICOTT CITY

DISTRICT 2nd

DATE 3/27/78

Raw-Con Plumbing & Heating

IS PERMITTED TO INSTALL \_\_\_\_\_ ALTER X

ADDRESS Maplewood Drive, Ellicott City, Md.

PHONE \_\_\_\_\_

SUBDIVISION Maplewood

ROAD 101<sup>49</sup> Maplewood Drive

LOT \_\_\_\_\_

PROPERTY OWNER Mr. Hansen

2nd house on st.

off Rt 99

ADDRESS same as above

SPECIFICATIONS 3 bedrooms

SEPTIC TANK CAPACITY 1000 GALLONS

DRAIN FIELD \_\_\_\_\_ DEPTH \_\_\_\_\_ FEET, BOTTOM AREA \_\_\_\_\_ SQ. FT.

DEEP TRENCH \_\_\_\_\_ DEPTH \_\_\_\_\_ FEET, BOTTOM AREA \_\_\_\_\_ SQ. FT.

SEEPAGE PITS \_\_\_\_\_ ABSORBENT SIDE-WALL AREA \_\_\_\_\_ SQ. FT.

INLET PIPE \_\_\_\_\_ FT. BELOW ORIGINAL GRADE. MAXIMUM DEPTH \_\_\_\_\_ FT. BELOW ORIGINAL GRADE

EFFECTIVE DEPTH AT \_\_\_\_\_ FT. BELOW ORIGINAL GRADE.

LOCATE DISPOSAL AREA \_\_\_\_\_ FT. FROM \_\_\_\_\_ LOT LINE AND \_\_\_\_\_ FT. FROM \_\_\_\_\_ LOT LINE AS SEEN WHEN  
FACING LOT FROM

REPAIR-CALL FOR INSPECTION WHEN GROUND IS OPENED UP SO SANITARIAN CAN

RECOMMEND REPAIR.

give tentative spec of eff. 2 1/2 - 6' 0  
water at 9'9" get as much trench as possible F.F.  
To stay 3'4" off water Public water → across front of house  
old system unless clogged or clogged to use new pipe  
to tie in with

PLANS APPROVED BY \_\_\_\_\_

DATE \_\_\_\_\_

COVER NO WORK UNTIL INSPECTED AND APPROVED.

NEITHER THE HOWARD COUNTY COUNCIL NOR THE HEALTH DEPARTMENT IS RESPONSIBLE FOR THE SUCCESSFUL OPERATION OF ANY SYSTEM.

NOTE: IF TRENCH IS USED CALL FOR INSPECTION BEFORE PLACING GRAVEL IN TRENCH.

NOTE: NO DRY WELL SHALL EXCEED 15 FOOT IN DIAMETER.

NOTE: ALL PIPE FROM HOUSE TO DISPOSAL AREA MUST BE CAST IRON.

PERMIT VOID AFTER THREE YEARS.

NOTE: INSTALL STAND PIPE ON SEPTIC TANK AND DRY WELL. STAND PIPES MUST BE 6 INCHES IN DIAMETER. CAST IRON, CONCRETE OR TERRA  
COTTA ACCEPTED.

\*INSTALLER IS RESPONSIBLE FOR OBTAINING FINAL APPROVAL ON THIS PERMIT.

A 27717

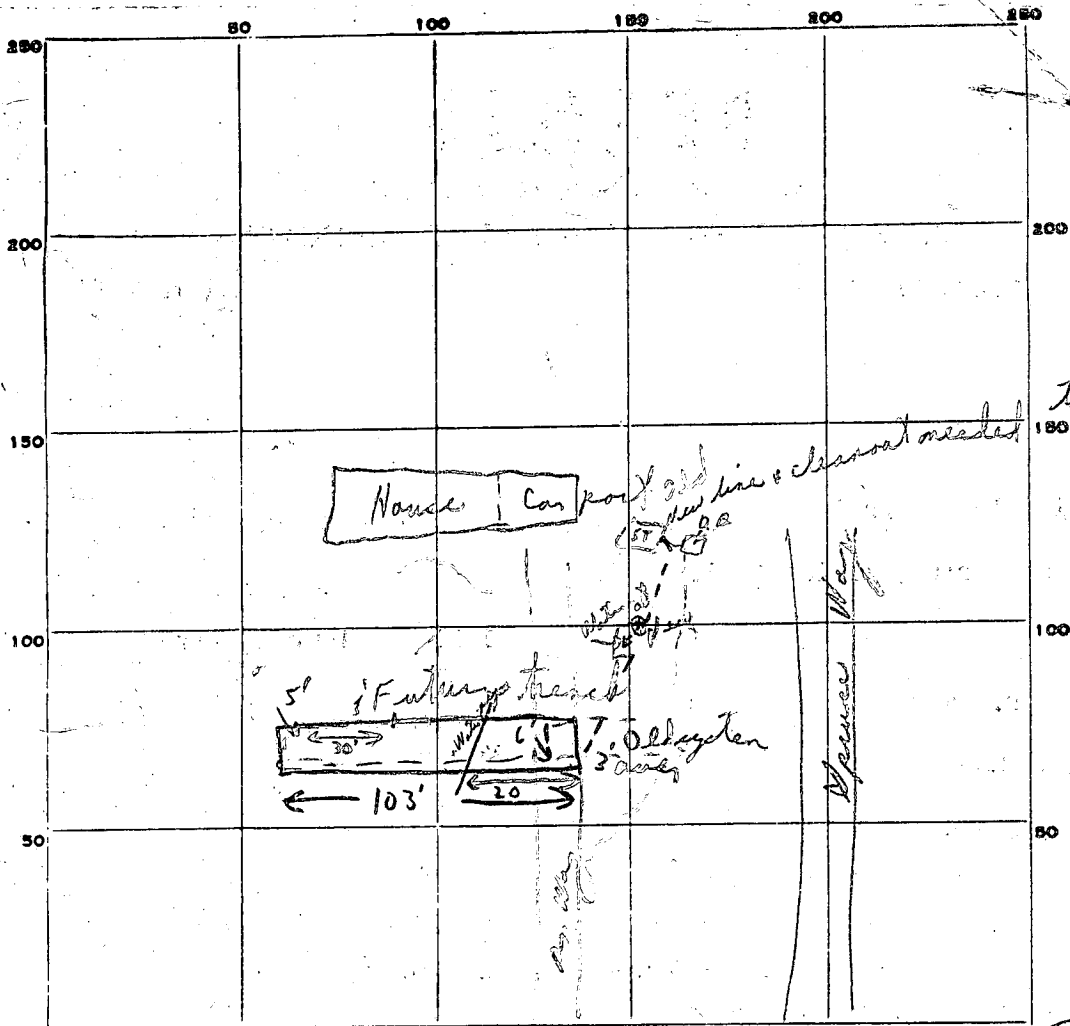

INDICATE NORTH. - NAME ADJOINING ROADWAY AS BASE LINE.

Rd - Maplewood Dr.

PERMIT CARD 0 Not seen

SEPTIC TANK, LEVEL N/A

CLEANOUTS N/A ST. DW N/A

DISTRIBUTION BOX, LEVEL N/A

TRENCH, DEPTH 5'-6" FT. TRENCH WIDTH — FT.

GRAVEL DEPTH 1 IN. TOTAL LENGTH 103 FT.

NUMBER OF TRENCHES 1 TOTAL BOTTOM AREA —

SEEPAGE PITS, INSIDE DIAMETER — FT. DEPTH BELOW INLET — FT.

ABSORBENT AREA — SQ. FT.

REMARKS  
 ① Saw water at 9'-9 1/2'; suggested follow F.F. recommendations  
 ② Trench 6' deep - some water at left end of trench when facing lot from road. (last 30') recommended 1' of soil be put back to stay above water table and a 10' section of cast iron under water pipe area to leave uncovered for inspection ③ also new pipe from septic tank to trench be cast iron. Old lines appear to be stopped up. Put cleanout <sup>at</sup> ~~at~~ grade near tank!

DATE SYSTEM-APPROVED \_\_\_\_\_ INSPECTOR \_\_\_\_\_

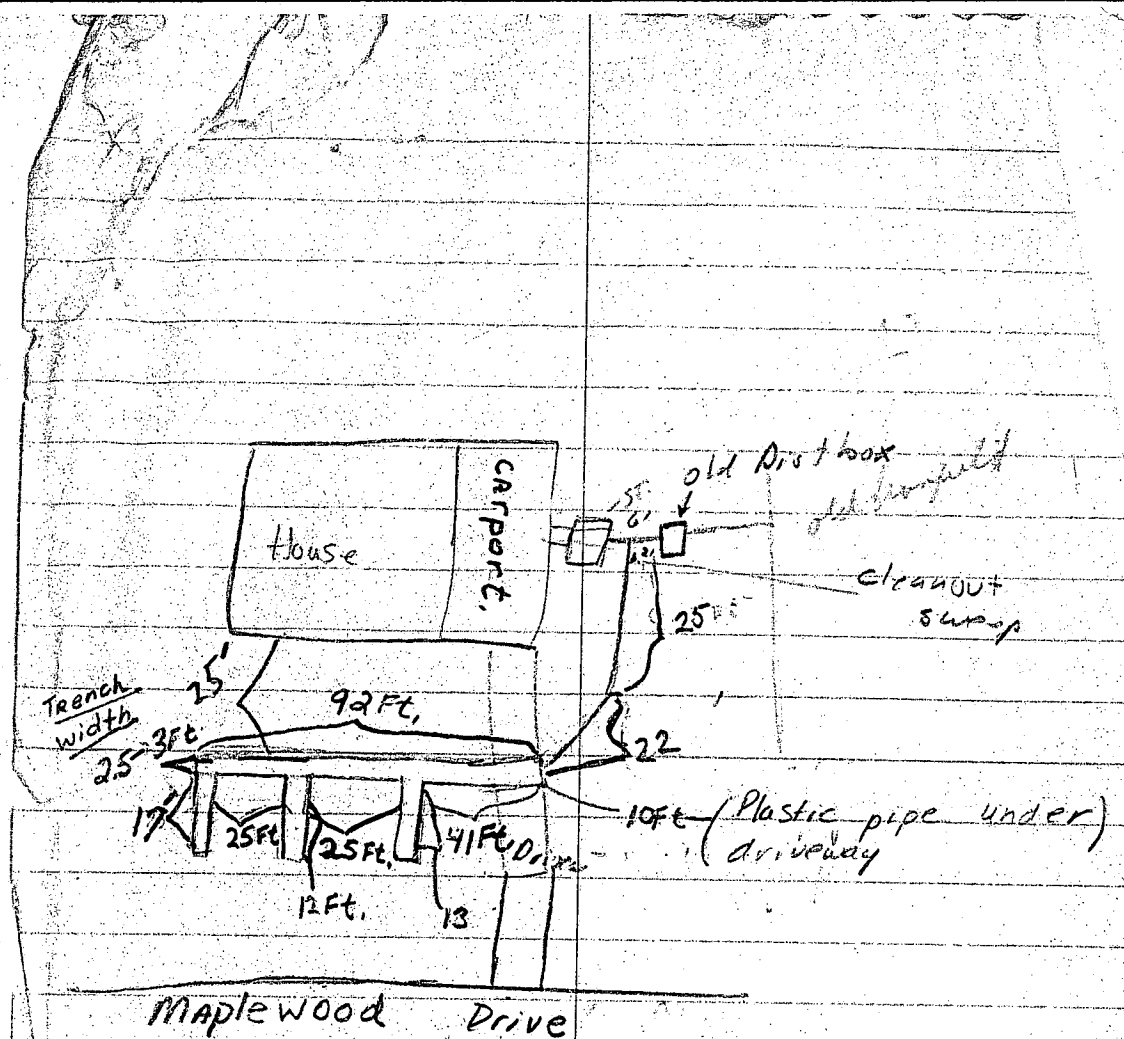

- DAVID O'Neil and M. Borgoyan.

- Suggested to replace plastic pipe under driveway with iron pipe. Didn't demand since not in original specifications.

- told okay to cover system  
 3/30/78 DAVID O'Neil & M. Borgoyan.  
 OMB.