

PERMIT

P 26138

A 25393

SEWAGE DISPOSAL SYSTEM

MARYLAND STATE DEPARTMENT OF HEALTH

HOWARD COUNTY

6/28/77

ELLICOTT CITY

DISTRICT 5th

DATE 6/20/77

INDEXED

05-420105

Floyd Seiss _____ IS PERMITTED TO INSTALL ALTER _____

ADDRESS Frederick, Md. _____ PHONE _____

A SEWAGE DISPOSAL SYSTEM LOCATED AT _____

SUBDIVISION _____ ROAD 12422 Lime Kiln Road _____ LOT _____

PROPERTY OWNER Walter Beck _____

ADDRESS Holly House Farm, Lime Kiln Road, Fulton, Md. _____

SPECIFICATIONS 3 bedrooms

DRAIN FIELD _____ DEPTH _____ FEET, BOTTOM AREA _____ SQ. FT.

SEEPAGE PITS _____ ABSORBENT SIDE-WALL AREA _____ SQ. FT.

SEPTIC TANK CAPACITY 1000 _____ GALLONS

FOR GARBAGE GRINDER, INCREASE DISPOSAL AREA 22% & TANK CAPACITY 50%.

OTHER DRY WELL AND/OR TRENCH-system to have 200 sq. ft. effective sidewall absorption area per bedroom to begin below the first 3 ft. of non-porous soil. Maximum depth permitted for dry well or trench is 10 ft. below original grade. Place the dry well (or part of the trench) 15 ft. from the right property side line and 40 ft. from the fence which encloses this pasture on the high side of lot and is roughly parallel to Lime Kiln Road. NOTE: CALL FOR INSPECTION OF TRENCH BEFORE GRAVEL IS INSTALLED.

NOTE: ALL PIPE FROM HOUSE TO DISPOSAL AREA MUST BE CAST IRON. PERMIT EXPIRES AFTER 5 YEARS.

NOTE: INSTALL STAND PIPES ON SEPTIC TANK AND DRY WELL. STAND PIPES MUST BE 6 INCHES IN DIAMETER. CAST IRON, CONCRETE OR TERRA COTTA ACCEPTED.

PLANS APPROVED BY Frank Skinner _____ DATE 4/25/77 _____

FILL SEPTIC TANK AND DISTRIBUTION BOX WITH WATER BEFORE CALLING FOR AN INSPECTION. COVER NO WORK UNTIL INSPECTED AND APPROVED.

NEITHER THE HOWARD COUNTY COMMISSIONERS NOR THE HEALTH DEPARTMENT IS RESPONSIBLE FOR THE SUCCESSFUL OPERATION OF ANY SYSTEM.

A 25393

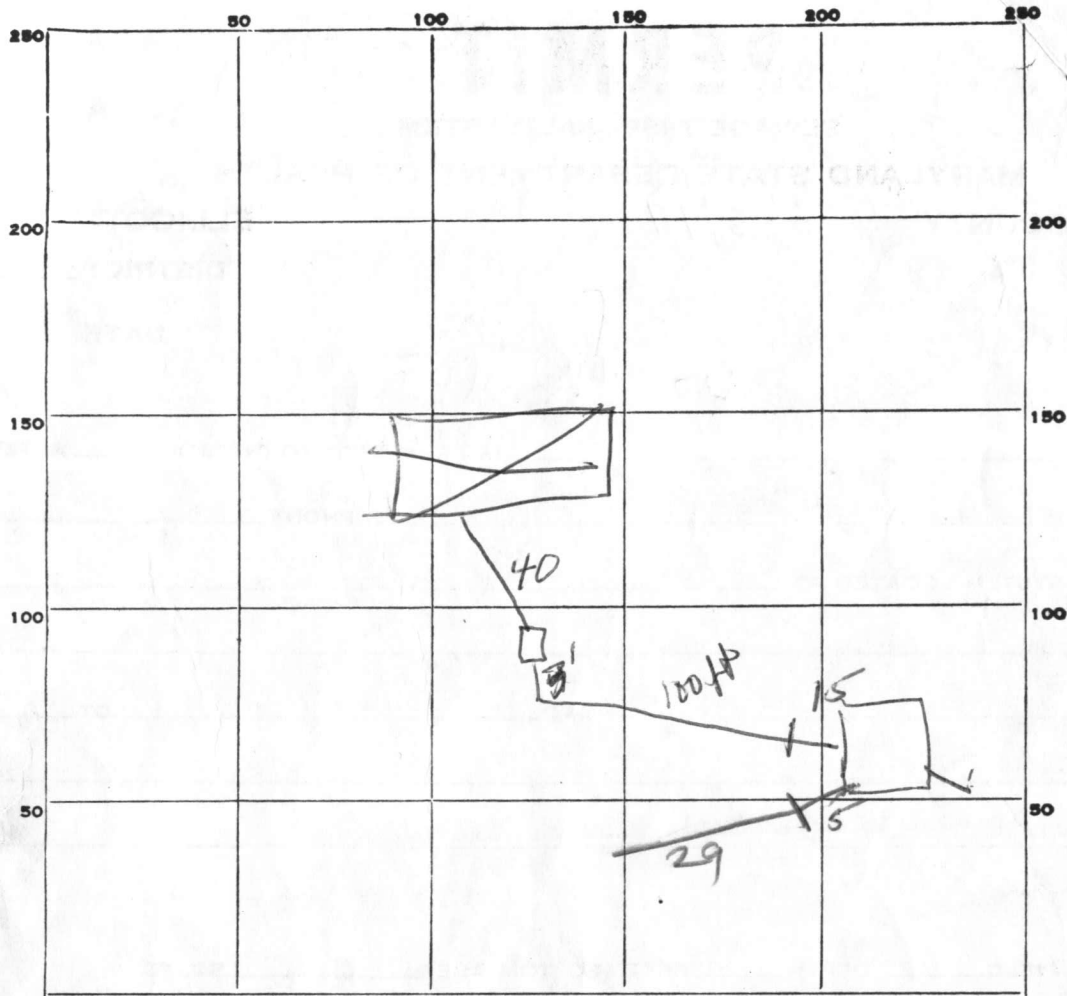

INDICATE NORTH. - NAME ADJOINING ROADWAY AS BASE LINE.

PERMIT CARD _____

SEPTIC TANK, LEVEL ✓

CLEANOUTS

ST	DW
OK	NO 6/27/77

DISTRIBUTION BOX, LEVEL NA

DITCH TILE FIELD, DEPTH 11 FT. TRENCH WIDTH 2 FT.

GRAVEL DEPTH 8 ^{feet} IN. TOTAL LENGTH 29 FT.

NUMBER OF TRENCHES 1 TOTAL BOTTOM AREA 232

SEEPAGE PITS, INSIDE DIAMETER Perimeter 49 FT. DEPTH BELOW INLET 8 FT.

ABSORBENT AREA 392 SQ. FT.

REMARKS OK to cover from elbow at DW side of trench to within 30ft of DW and from 5 ft of the house to 3 ft from the DW RAB 24 June 77

6/27/77 - Perimeter of DW is 49 FT Inlet & Cleanout not installed Could not measure depth of DW. RAB Partial need to see house connection RAB 27 June 77

DATE SYSTEM APPROVED 27 June 77

INSPECTOR [Signature]

Line connected. House occupied. Conditionally approved.

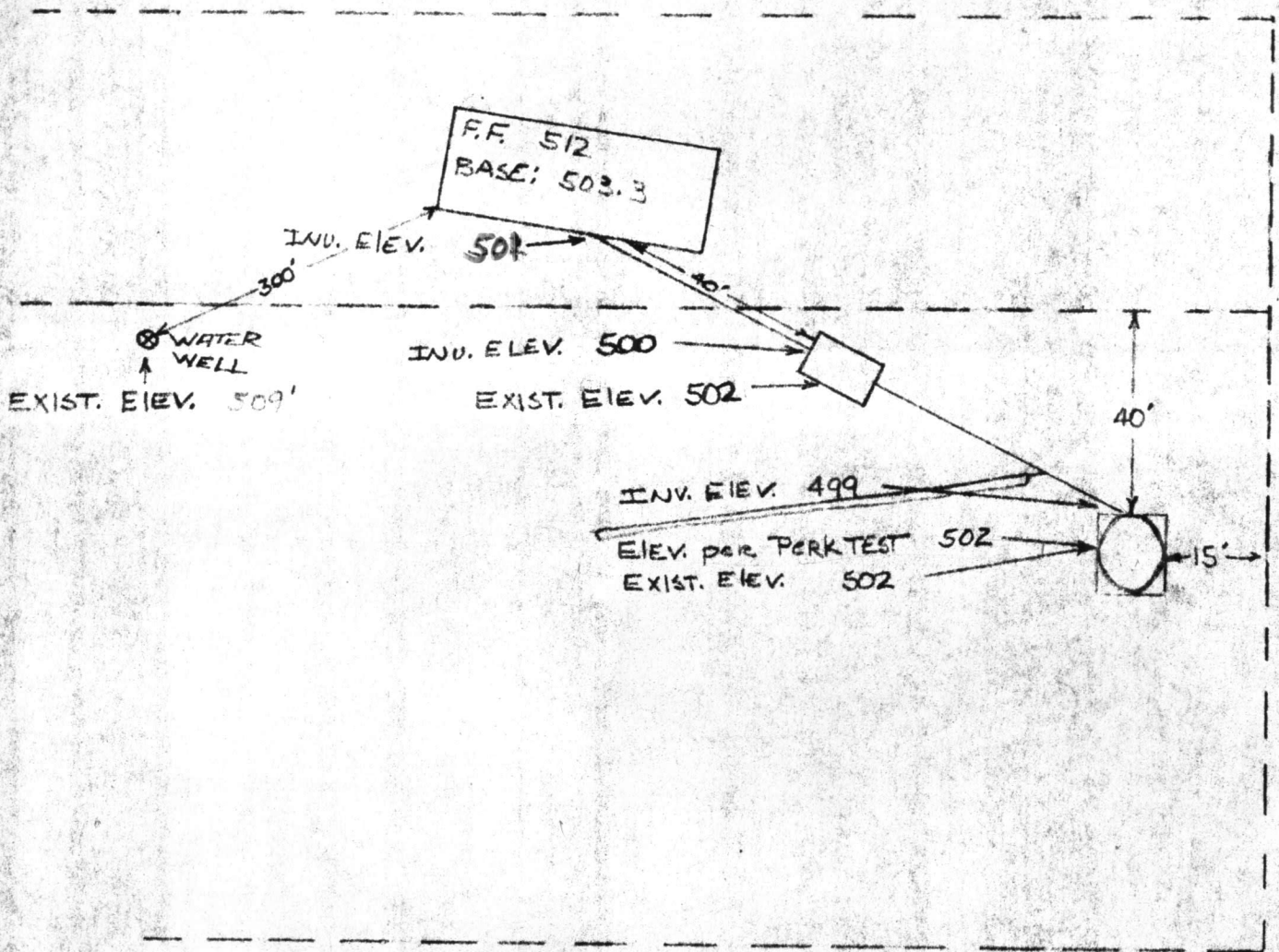

WALTER BECK
12422 LIME KILN RD. FULTON MD.

RECORDED

APPLICATION

A 25393

P _____

SEWAGE DISPOSAL TESTING

STATE OF MARYLAND - DEPARTMENT OF HEALTH AND MENTAL HYGIENE

HOWARD COUNTY HEALTH DEPARTMENT
ENVIRONMENTAL HEALTH SERVICES

3 B.R. 1000 gal. Septic tank
4 B.R. 1250 gal. Septic tank

DISTRICT 5th

DATE 3/14/77

P. O. BOX 476, ELLICOTT CITY, MARYLAND 21043
TELEPHONE: 465-5000, EXT. 356

4/22/77
1:30 P.M.

*Drywell and/or trench system to have 200 SQ. FT. effective sidewall absorption area per bedroom to begin below the first 3 ft. of non-porous soil. Maximum depth permitted for drywell or trench is 10 ft. below original grade. Place the drywell (or part of the trench) 15 ft. from the right property side line and 40 ft. from the fence which encloses this pasture on the highside of lot and is roughly parallel to Lime Kiln Road.
NOTE: Call for inspection of trench before gravel is installed.*

TO: THE COUNTY HEALTH OFFICER
ELLICOTT CITY, MARYLAND

I, HEREBY, APPLY FOR THE NECESSARY TEST IN ORDER TO CONSTRUCT (OR RECONSTRUCT) A SEWAGE DISPOSAL SYSTEM.

PROPERTY OWNER Walter Beck

ADDRESS Holly House Farm, Lime Kiln Road, Fulton, Md. 20759 PHONE 792-0243

PROPERTY LOCATION:

SUBDIVISION _____ LOT NO. _____

ROAD AND DESCRIPTION 12422 Lime Kiln Road

SIZE OF LOT 68 acres TYPE BLDG. Existing House 3 bedrooms
NUMBER OF BEDROOMS

IF NOT SINGLE RESIDENCE DESCRIBE _____

THE SYSTEM INSTALLED UNDER THIS APPLICATION IS ACCEPTABLE ONLY UNTIL PUBLIC FACILITIES BECOME AVAILABLE.

SIGNATURE OF APPLICANT Walter Beck BLDG. PERMIT SIGNED AND RETURNED 5/2/77

APPROVED BY Frank Skinner FOR Drywell &/or trench DATE 4/25/77
(KIND OF SYSTEM)

REJECTED BY _____ FOR _____ DATE _____
(KIND OF SYSTEM)

HOLD PENDING FURTHER TESTS _____ DATE _____

REASONS FOR REJECTION OR HOLDING _____

THIS IS NOT A PERMIT

House site

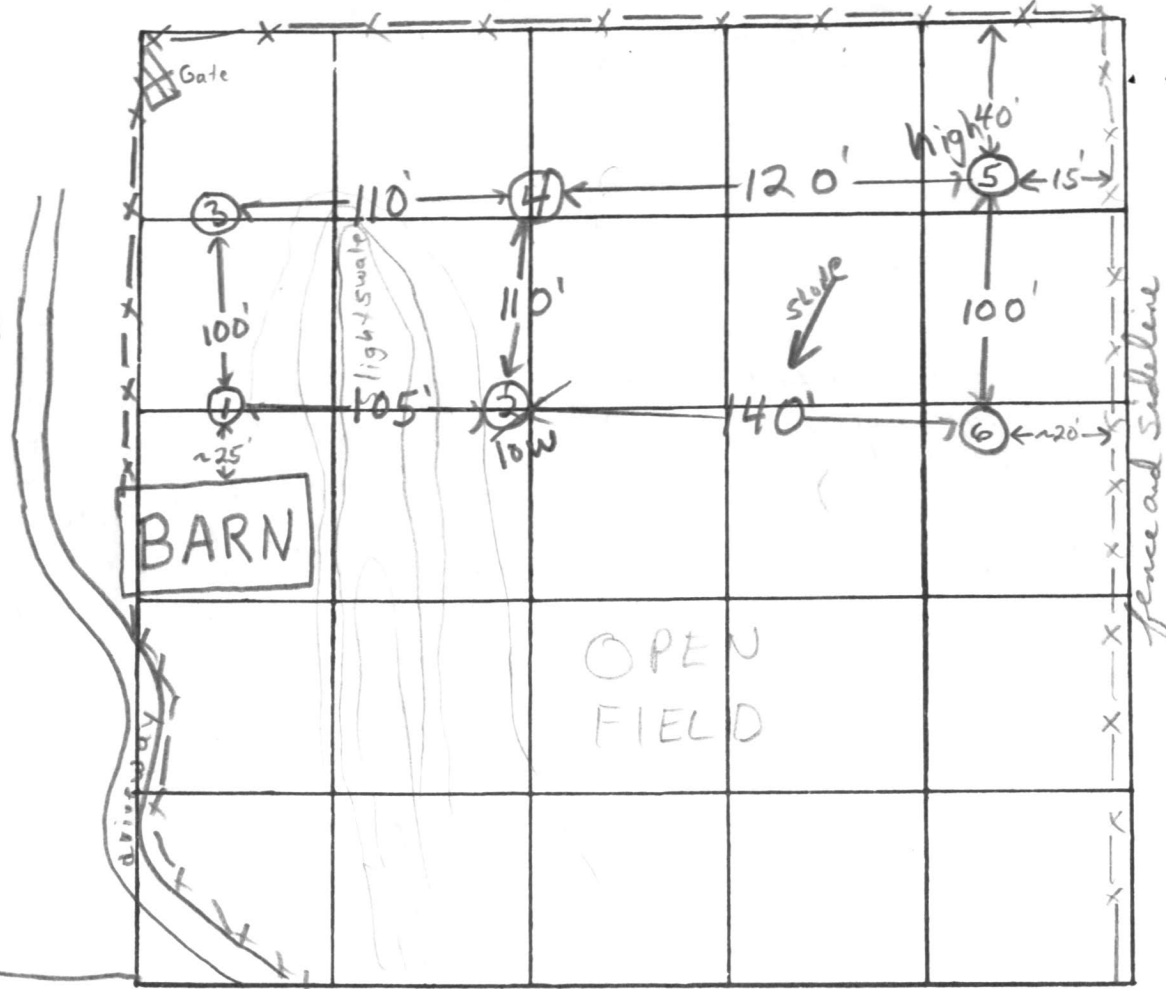

INDICATE NORTH. - NAME ADJOINING ROADWAY AS BASE LINE

Lime Kiln Road

DATE	TEST NO.	DEPTH	PRE-WET		TEST - 1" DROP		TIME	
			START	STOP	START	STOP		
4/22/77	1	4'	1:40	1:42	1:42	1:50	8min	
	1A	11 1/2'	1:40	2:03	2:03	2:29	26min	
	②	5'	1:52	pulled peg 2:30 1" drop				
	2A	11 1/2'	1:52	2:06	2:06	2:27	21min	
	3	12'	Clayey to 4' silty loam below					
	④	4 1/2'	2:28	2:54	2:54	3:30	36min clayey to 5'	
	4A	12 1/2'	2:28	2:33	2:33	2:42	9min	
	②A	5 1/2'	2:43	3:07	3:07	3:50	43min clayey to 6'	
	5 high	13'	Clayey to 3' mica loam below					
	6	13'	Clayey to 3 1/2' mica loam below					

REMARKS ⑤ is ~2' higher than ④

TYPE OF SOIL mica silt loam below top 3-6' clayey soil

TESTED BY F.S.

ALSO PRESENT: W. Beck & family

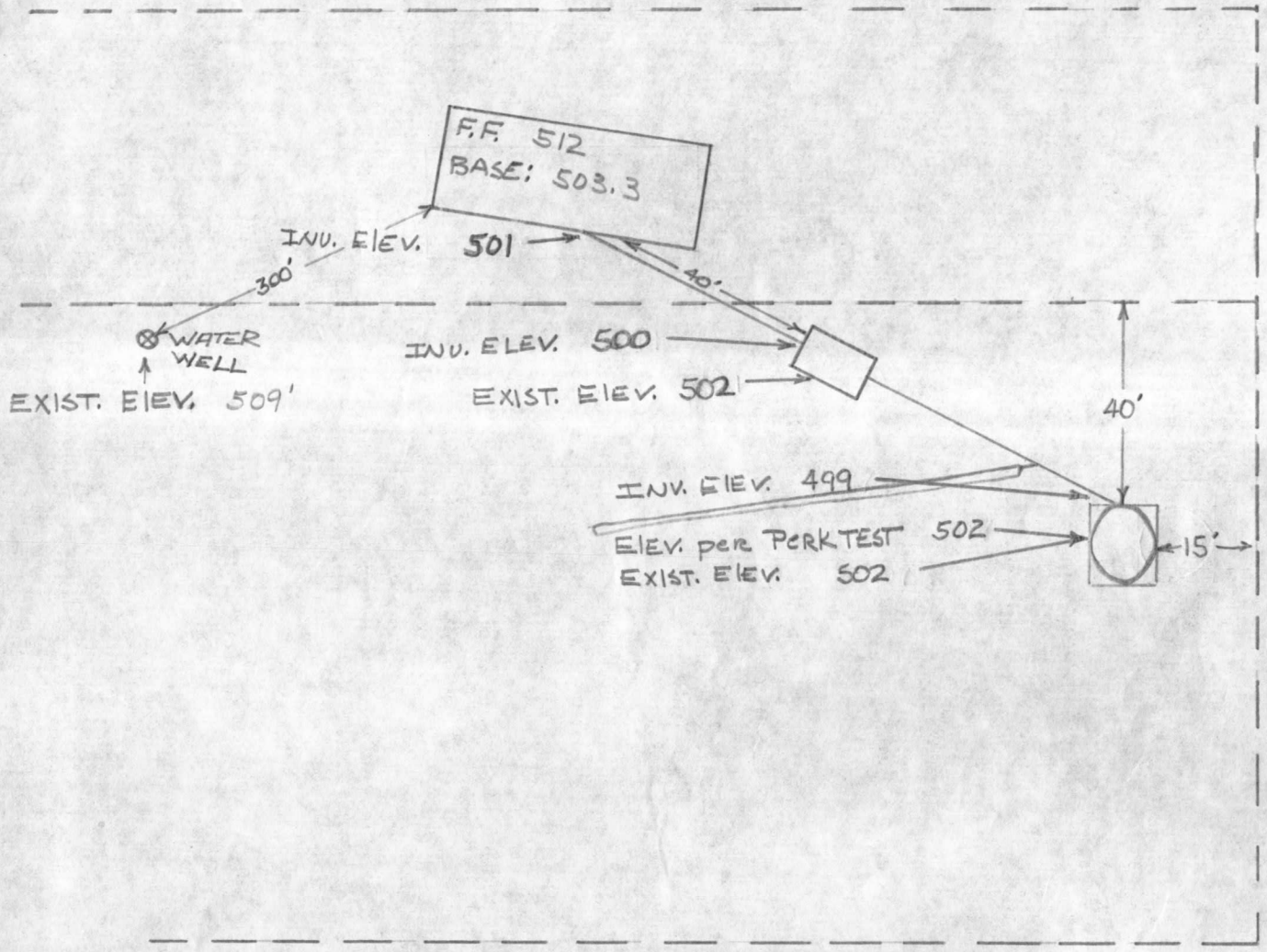

WALTER BECK
 12422 LIME KILN Rd. Fulton Md.

6-15-77

Walter Beck