

7/23/79

app. 7-23-79
D
P 30012

PERMIT

SEWAGE DISPOSAL SYSTEM

MARYLAND STATE DEPARTMENT OF HEALTH*

HOWARD COUNTY

ELLICOTT CITY

DISTRICT _____

INDEXED

DATE 7/23/79

Olen Ketterman IS PERMITTED TO INSTALL _____ ALTER

ADDRESS _____ PHONE _____

SUBDIVISION _____ ROAD 11461 Johns Hopkins Road LOT _____

PROPERTY OWNER Gene German

ADDRESS 11461 Johns Hopkins Road, Laurel, Md.

SPECIFICATIONS 3 bedrooms

SEPTIC TANK CAPACITY 1000 GALLONS

DRAIN FIELD _____ DEPTH _____ FEET. BOTTOM AREA _____ SQ. FT.

DEEP TRENCH _____ DEPTH _____ FEET. BOTTOM AREA _____ SQ. FT.

SEEPAGE PITS _____ ABSORBENT SIDE-WALL AREA _____ SQ. FT.

INLET PIPE _____ FT. BELOW ORIGINAL GRADE. MAXIMUM DEPTH _____ FT. BELOW ORIGINAL GRADE

EFFECTIVE DEPTH AT _____ FT. BELOW ORIGINAL GRADE.

LOCATE DISPOSAL AREA _____ FT. FROM _____ LOT LINE AND _____ FT. FROM _____ LOT LINE AS SEEN WHEN FACING LOT FROM

REPAIR-CALL FOR INSPECTION WHEN GROUND IS OPENED UP SO SANITARIAN CAN

RECOMMEND REPAIR. *Trench 70 ft long - 9 ft deep
5 ft stone. Done*

PLANS APPROVED BY Palmer F. Wine DATE 7/23/79

COVER NO WORK UNTIL INSPECTED AND APPROVED.

NEITHER THE HOWARD COUNTY COUNCIL NOR THE HEALTH DEPARTMENT IS RESPONSIBLE FOR THE SUCCESSFUL OPERATION OF ANY SYSTEM.

NOTE: IF TRENCH IS USED CALL FOR INSPECTION BEFORE PLACING GRAVEL IN TRENCH.

NOTE: NO DRY WELL SHALL EXCEED 15 FOOT IN DIAMETER.

NOTE: ALL PIPE FROM HOUSE TO DISPOSAL AREA MUST BE CAST IRON.

PERMIT VOID AFTER THREE YEARS.

NOTE: INSTALL STAND PIPE ON SEPTIC TANK AND DRY WELL. STAND PIPES MUST BE 6 INCHES IN DIAMETER. CAST IRON, CONCRETE OR TERRA COTTA ACCEPTED.

***INSTALLER IS RESPONSIBLE FOR OBTAINING FINAL APPROVAL ON THIS PERMIT.**

P 30012

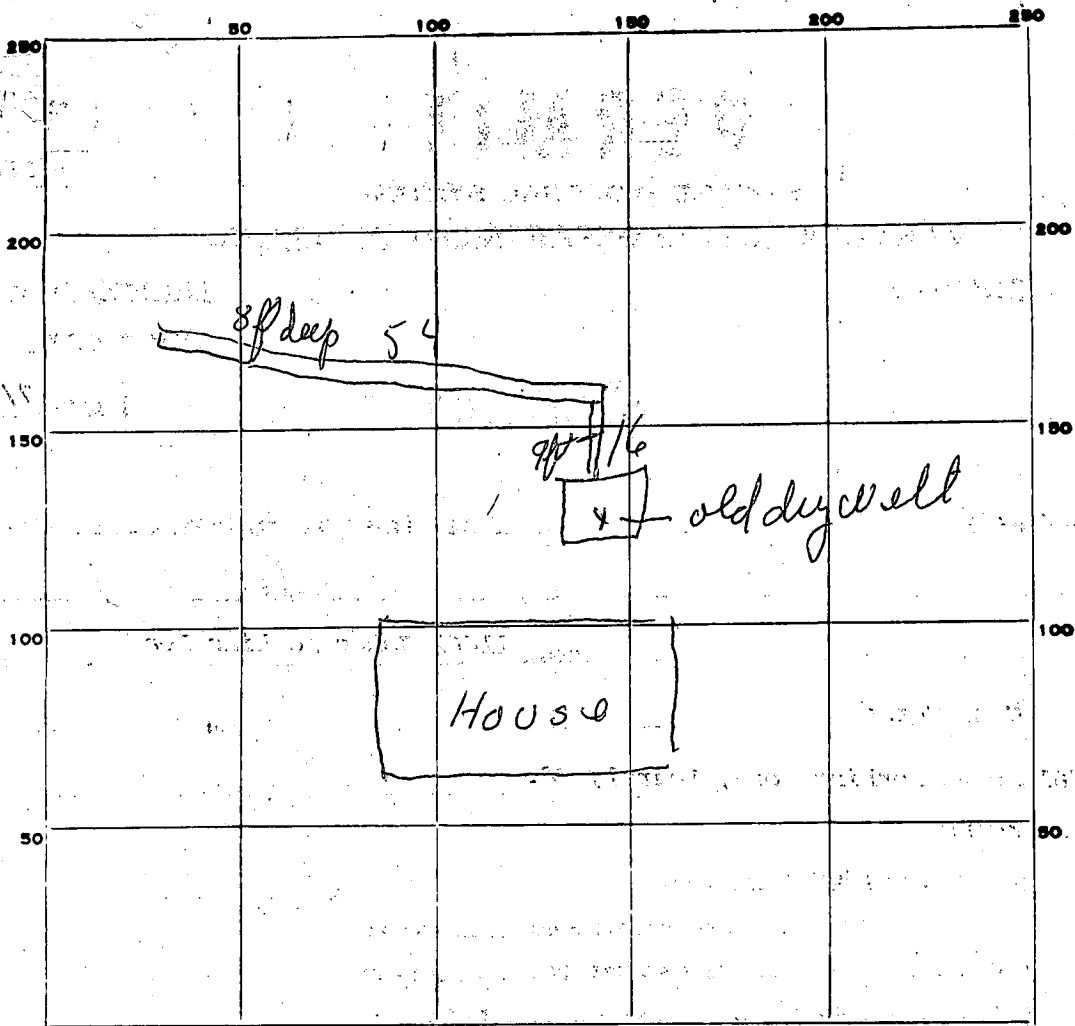

INDICATE NORTH. - NAME ADJOINING ROADWAY AS BASE LINE.

PERMIT CARD NP

SEPTIC TANK, LEVEL _____

CLEANOUTS NP

DISTRIBUTION BOX, LEVEL _____

TILE FIELD, DEPTH 8 to 9' FT. TRENCH WIDTH 2 FT.

GRAVEL DEPTH 60" IN. TOTAL LENGTH 70 FT.

NUMBER OF TRENCHES 1 TOTAL BOTTOM AREA 120

SEEPAGE PITS, INSIDE DIAMETER _____ FT. DEPTH BELOW INLET _____ FT.

ABSORBENT AREA 370 SQ. FT.

REMARKS _____

DATE SYSTEM APPROVED 7-23-79

INSPECTOR Old Manager

July 23, 1979

To: Mr. Monahan

This is to certify that I, Eugene Germann, owner and occupant of 11461 Johns Hopkins Road, Laurel, MD 20810, was present while work was being done on my property by Olen Ketterman on July 23, 1979. I certify that the gravel and pipe were installed correctly and papered down in my presence.

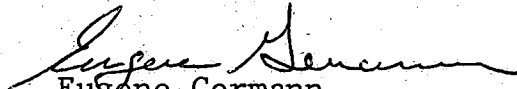

Eugene Germann
11461 Johns Hopkins Road
Laurel, MD 20810

776-4670