

AVP
(36E)
 Red Br Heavy Loam 3'-3.5'
 Red Br Loam ~10% Rock 5.5'
 Red Br Loam and Si Loam ~10% Rock 7.5'+
 Or Br Sa Loam 10-15% Rock and Saprofite 13'

(36D)
 Red Br Heavy Loam 3.5'
 Red Br Loam and Si Loam ~10% Rock 7'
 Red Br Sa Loam Turning Or Br with Depth ~15% Rock 12.5'

(36A)
 Red Br Loam and Heavy Loam 4.5'-5'
 Dense Or Br Sa Loam ~20% Rock 13'

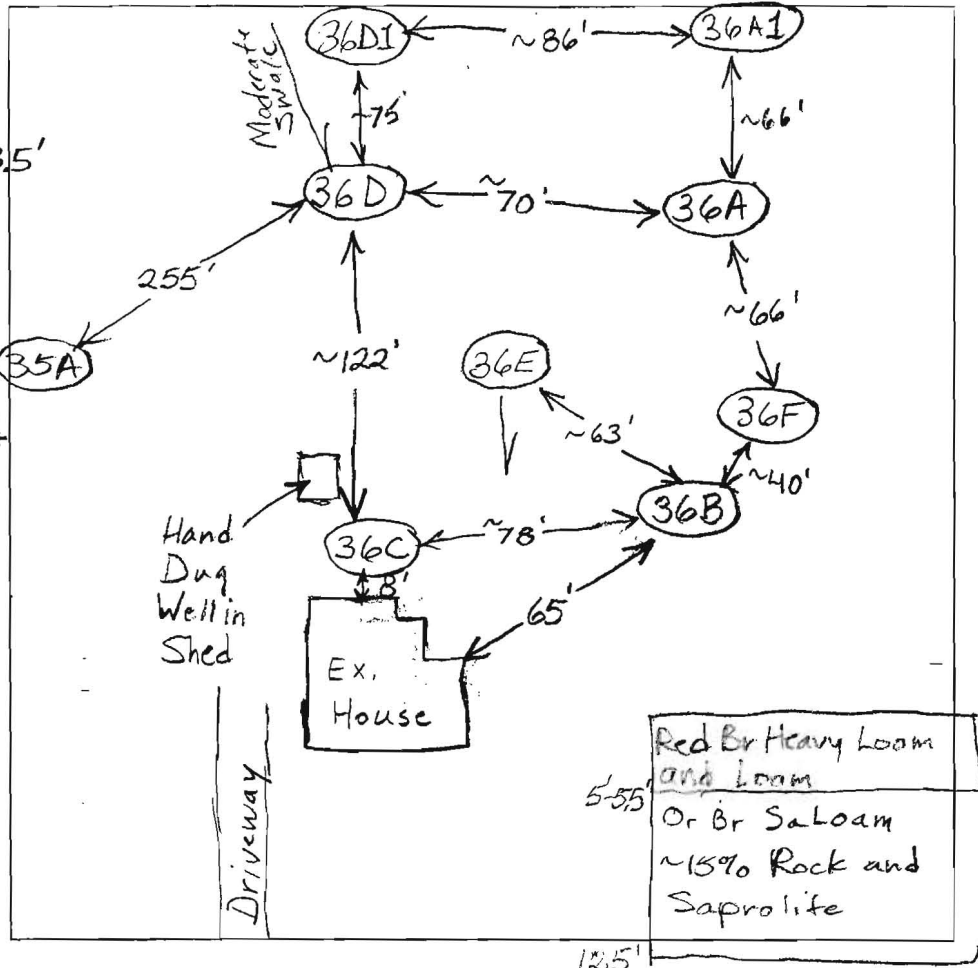

(36B)
 Red Br Heavy Loam 5'-6'
 Red Br Loam with Quartz Boulders ~40% Rock 8'
 Or Br Sa Loam ~35% Rock 13'

(36F)
 Red Br Loam Very Silty ~20% Rocks 8'
 Red Br and Or Br Sa Loams Getting Sandier with Depth ~15% Rock

(36D1)
 Red Br Loam 11.5'-12.5'
 Red Br Si Loam ~10% Rock 6'-7'
 Or Br Sa Loam ~15% Rock and Saprofite 12.5'

DATE	TEST #	DEPTH	START	BREAK 1" DROP	STOP 2" DROP	TIME OF 2nd INCH	P/F/H	
10/21/03	36E	5'10"/13'V	10:49	11:03	11:03	~1/2" in 30	Slow	
	36D	5'10"/12.5'V	11:10	11:30	11:30	~7/8" in 30	Slow	
	36A	6'3"/13'V	11:35:30	11:39:30	11:39:30	11:48	8 1/2	
	36B	13'V	Not Tested					
	36F	6.5'/12.5'V	12:08	~1/4" in 10 minutes			Slow	
	36D	7'	3:19:30	3:26:30	3:26:30	3:35	8 1/2	
	36E	7.5'	3:27	Less than 1/2" in 20 minutes			Slow	
	36D1	6'4"/12.5'V	3:31	3:36	3:36	3:43	7	
	36A1	7'/12.5'V	3:44	3:47	3:47	3:52	5	

REMARKS 36E, D1 + A1 Not Staked
 SANITARIAN BB BACKHOE _____ OTHERS _____
 TEST HOLES USED IN SDA _____ AVG. PERC TIME _____ SQ. FT/BR _____
 TRENCH WIDTH _____ INLET DEPTH _____ MAX. BOT DEPTH _____ EFFECTIVE SW _____

20' RIGHT-OF-WAY
ELECTRIC POWER COMPANY
IS SUBJECT TO A REVIEW OF HOLES NO. 3887
PRIOR TO APPROVAL AT BUILDING PERMIT.

