

AVP (38D)

Red Br Loam 2.5'-3.5'  
Br Sa Loam ~30% Rock  
Hard Bottom 9.5'

(38F)  
Red Br Heavy Loam 4.5'-5'  
Or Br Si Loam Very Little Rock 6.5'

Med Br Sa Loam ~10% Rock  
Hard Bottom 11.5'

(38A-1)  
Red Br Heavy Loam 4'-4.5'  
Red Br Sa Loam ~15% Rock 6'  
Med Br Sa Loam ~15% Rock  
Hard Bottom 11'

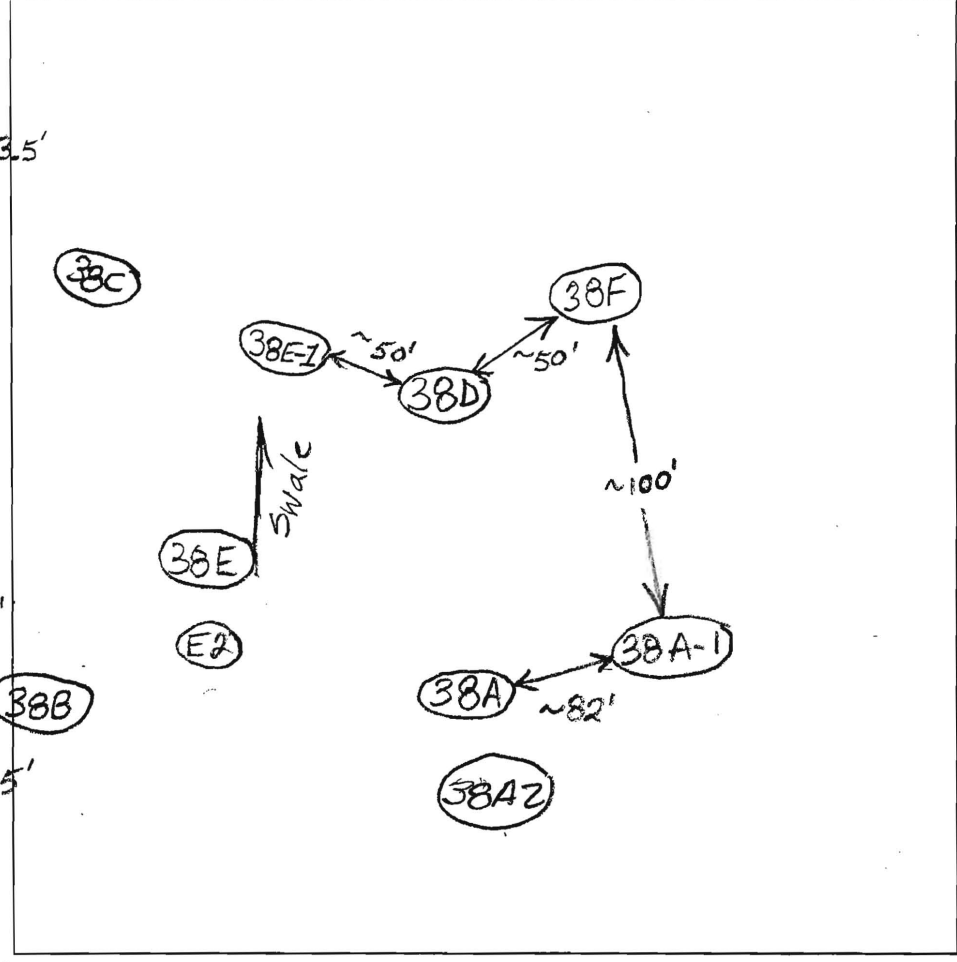

(38E-1)  
Red Br Loam 4'-5'  
Med Br Br Sa Loam ~20% Rock  
Hard Bottom 10'

DATE	TEST #	DEPTH	START	BREAK 1" DROP	STOP 2" DROP	TIME OF 2nd INCH	P/F/H
10/21/03	38D	3.5'/9.5'V	1:42:30	1:52:30	1:52:30	2:16	23/2
	38F	6'/11.5'V	1:55	2:23	2:23	~7/8" in 30	Slow
	38A-1	6'/11'V	2:27	2:31	2:31	2:38	7

Easement Shifted Out of Swale - Will Be Difficult to Install

REMARKS Holes Dug Off Stake Except 38D  
SANITARIAN B. Baker BACKHOE OTHERS  
TEST HOLES USED IN SDA \_\_\_\_\_ AVG. PERC TIME \_\_\_\_\_ SQ. FT/BR \_\_\_\_\_  
TRENCH WIDTH \_\_\_\_\_ INLET DEPTH \_\_\_\_\_ MAX. BOT DEPTH \_\_\_\_\_ EFFECTIVE SAW \_\_\_\_\_

AP

38C  
Brown loam 1'  
Yellow Brown Clay loam 3'  
Red Brown Silty Clay loam 5 1/2'  
Yellow Brown Silty loam 13'

38A2  
Brown loam 1'  
Yellow Brown Clay loam 2 1/2'  
Red Brown Red Silty loam  
Yellow Brown Silty loam 11'  
Yellow Brown Silty loam 11'  
15% Rock  
Bottom

38E2  
Brown loam 1 1/2'  
Yellow Clay loam 3 1/2'  
Red Silty loam  
Silty loam  
15% Rock

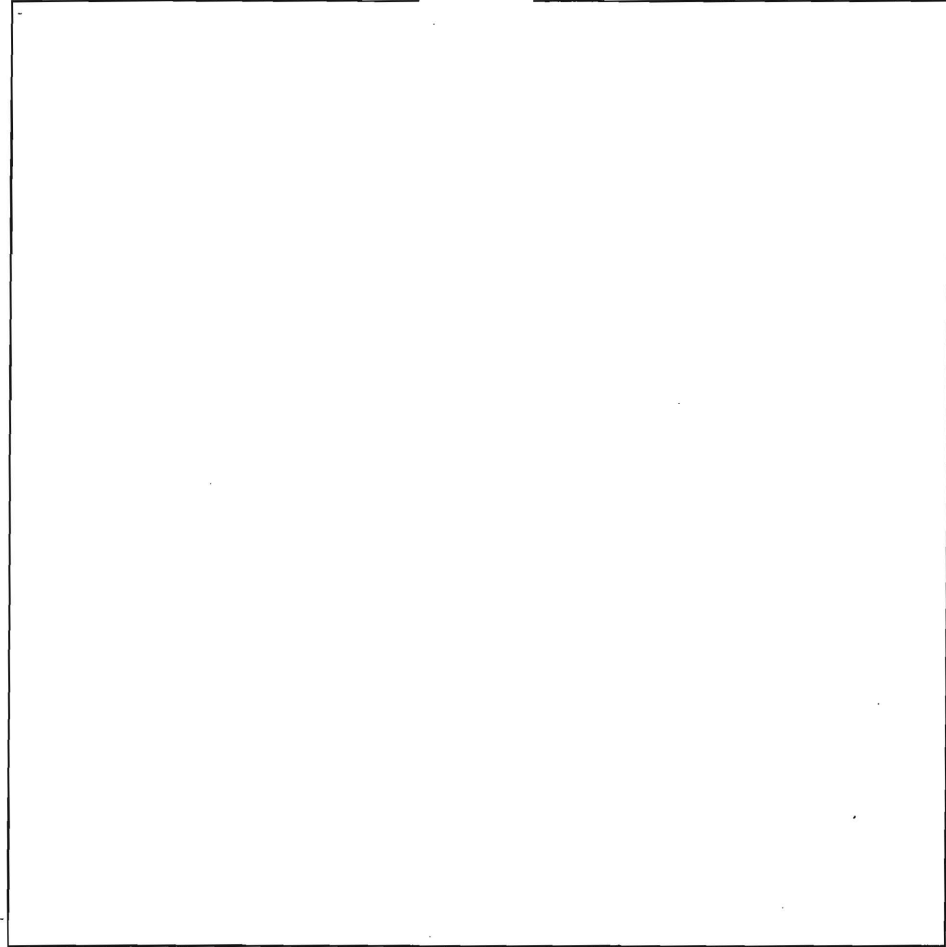

DATE	TEST #	DEPTH	START	BREAK 1" DROP	STOP 2" DROP	TIME OF 2nd INCH	P/F/H
10/21/03	38C	6' 13'	2:06	2:08	2:13	5min	D
10/21/03	38A2	5 1/2' 11'	2:25	2:28	2:34	6min	P
10/21/03	38E2	5 1/2' 11'	2:51	2:56	3:00	4min	P

REMARKS \_\_\_\_\_  
 SANITARIAN FR BACKHOE \_\_\_\_\_ OTHERS Brian Baker, Bob Shestler, Mark Johnson  
 TEST HOLES USED IN SDA \_\_\_\_\_ AVG. PERC TIME \_\_\_\_\_ SQ. FT/BR \_\_\_\_\_  
 TRENCH WIDTH \_\_\_\_\_ INLET DEPTH \_\_\_\_\_ MAX. BOT DEPTH \_\_\_\_\_ EFFECTIVE SW \_\_\_\_\_

AP

38D2  
 Flou...  
 4" fill  
 pieces of  
 asphalt  
 3'  
 4"  
 Yellow  
 Brown  
 Silcom  
 n. 7/2  
 Yellow  
 Brown  
 Silcom  
 1540  
 Rock  
 12'

38A3  
 Brown Lm  
 1'  
 tan brown  
 sil  
 3'  
 Red Brown  
 sil  
 4'  
 Brown/Red  
 tan micas  
 sil  
 11'  
 >10%  
 Saprolite

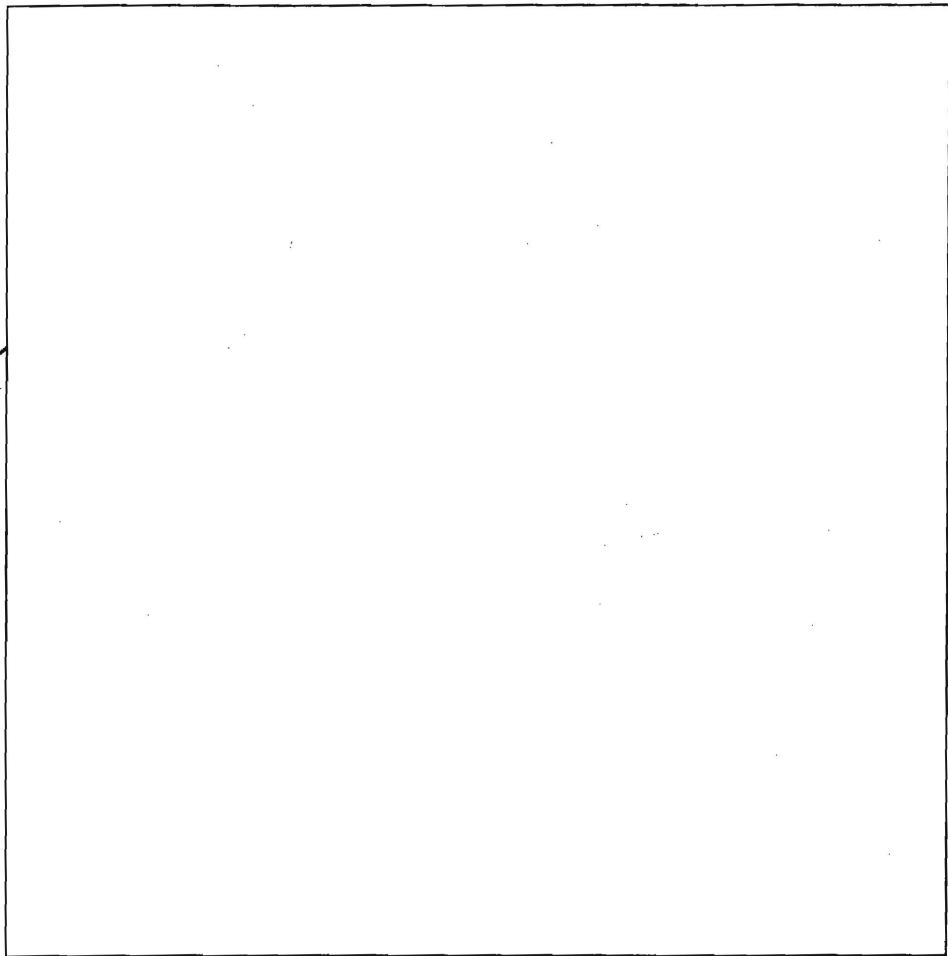

DATE	TEST #	DEPTH	START	BREAK 1" DROP	STOP 2" DROP	TIME OF 2nd INCH	P/F/H
12/16/03	38D2	6' 12"	9:24	9:45	10:15	- Pulled -	F
	38A3	6' 11"	9:25	9:28	9:31	3min	P
	38AB	7' 11"	10:20	10:27	10:36	9 min	P

REMARKS \_\_\_\_\_ Willie \_\_\_\_\_  
 SANITARIAN FA/KB BACKHOE Straight OTHERS \_\_\_\_\_  
 TEST HOLES USED IN SDA \_\_\_\_\_ AVG. PERC TIME \_\_\_\_\_ SQ. FT/BR \_\_\_\_\_  
 TRENCH WIDTH \_\_\_\_\_ INLET DEPTH \_\_\_\_\_ MAX. BOT DEPTH \_\_\_\_\_ EFFECTIVE SW \_\_\_\_\_

Bob Schooley  
 Paul Johnson  
 Dale Johnson

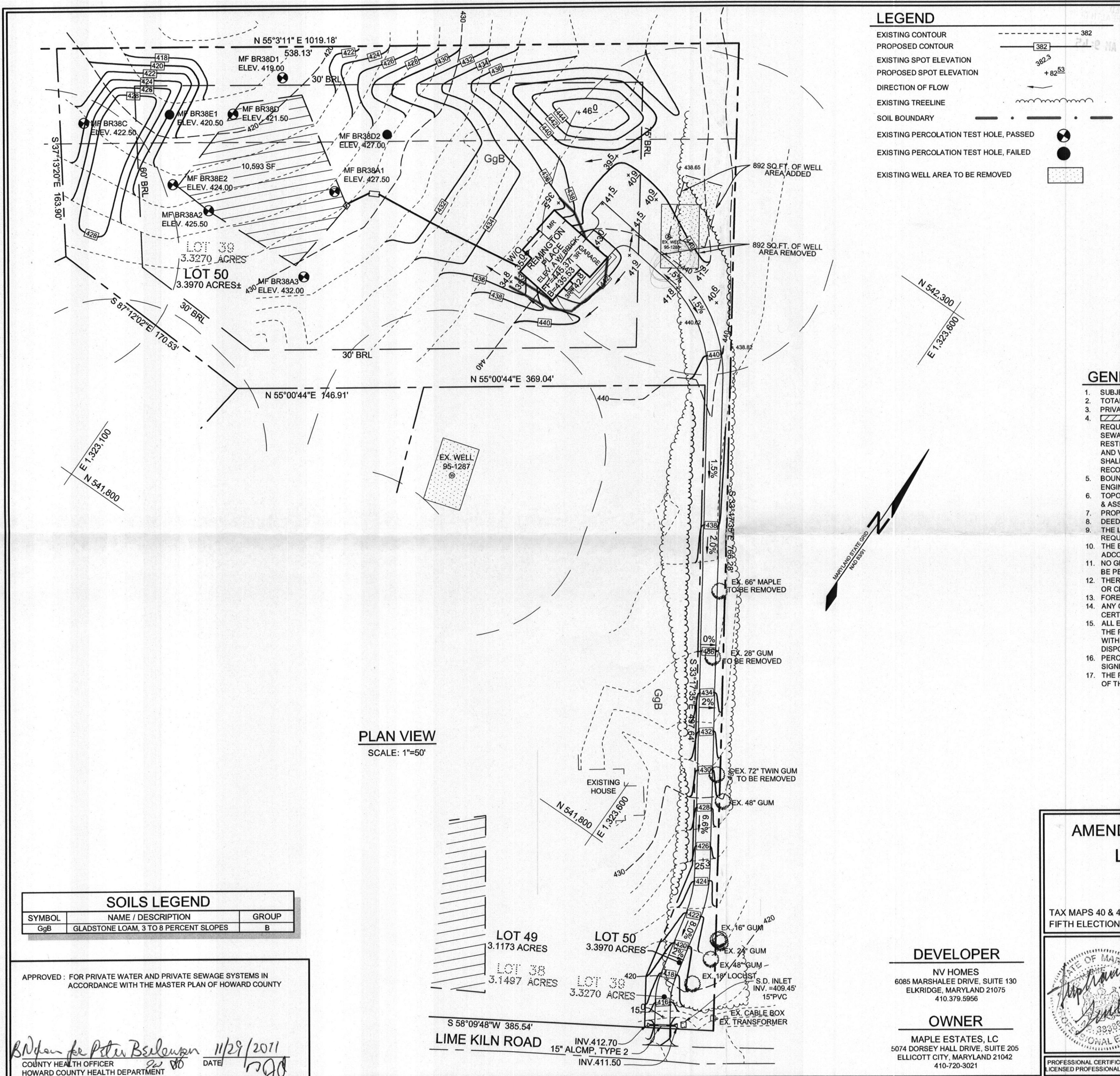

**LEGEND**

- EXISTING CONTOUR
- PROPOSED CONTOUR
- EXISTING SPOT ELEVATION
- PROPOSED SPOT ELEVATION
- DIRECTION OF FLOW
- EXISTING TREELINE
- SOIL BOUNDARY
- EXISTING PERCOLATION TEST HOLE, PASSED
- EXISTING PERCOLATION TEST HOLE, FAILED
- EXISTING WELL AREA TO BE REMOVED

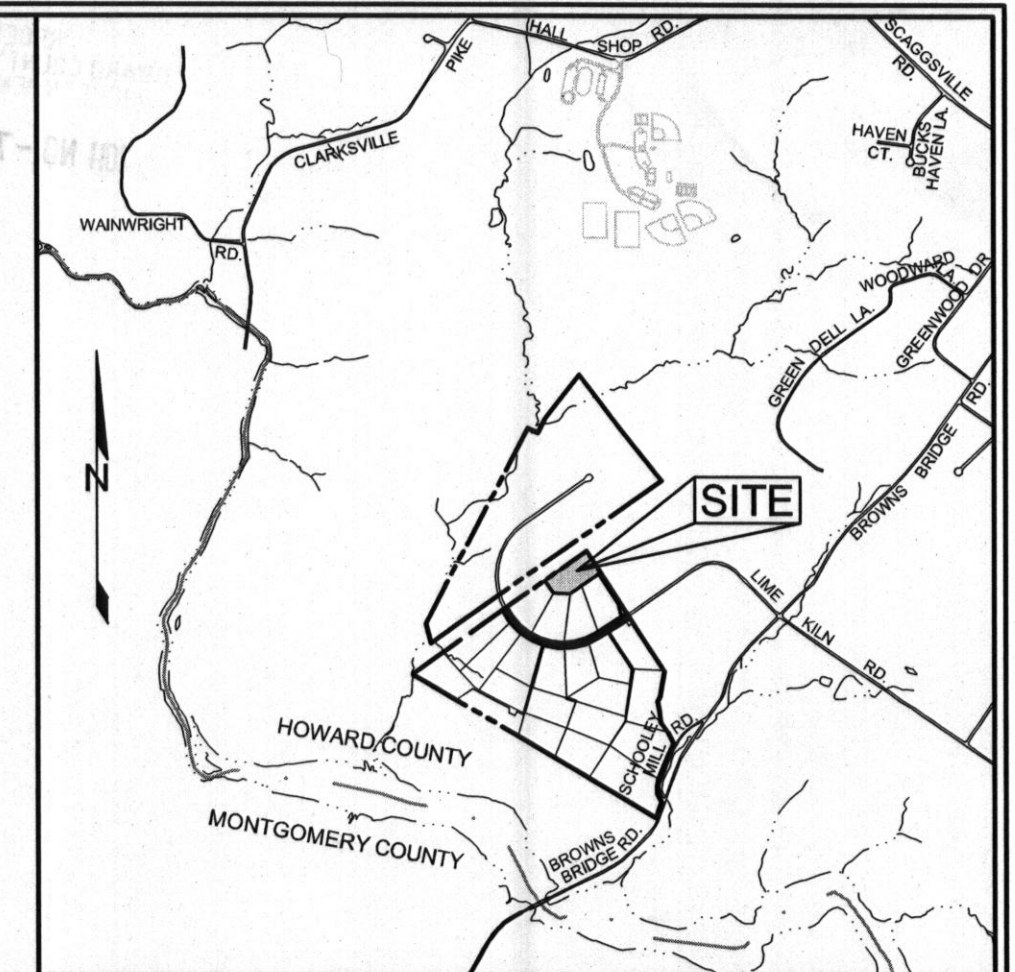

**VICINITY MAP**  
SCALE: 1"=2000'

**GENERAL NOTES**

1. SUBJECT PROPERTY ZONED RR-DEO PER 02/02/04 COMPREHENSIVE ZONING PLAN.
2. TOTAL AREA OF LOT = 3.3970 AC.
3. PRIVATE WATER AND PRIVATE SEWER WILL BE USED WITHIN THIS SITE.
4. THIS AREA DESIGNATES A PRIVATE SEWAGE EASEMENT, OF AT LEAST 10,000 SF AS REQUIRED BY THE MARYLAND STATE DEPARTMENT OF THE ENVIRONMENT FOR INDIVIDUAL SEWAGE DISPOSAL (COMAR 26.04.03). IMPROVEMENTS OF ANY NATURE IN THIS AREA ARE RESTRICTED UNTIL PUBLIC SEWERAGE IS AVAILABLE. THESE EASEMENTS SHALL BECOME NULL AND VOID UPON CONNECTION TO A PUBLIC SEWERAGE SYSTEM. THE COUNTY HEALTH OFFICER SHALL HAVE THE AUTHORITY TO GRANT ADJUSTMENTS TO THE PRIVATE SEWAGE EASEMENT. RECORDATION OF A MODIFIED SEWAGE EASEMENT SHALL NOT BE NECESSARY.
5. BOUNDARY SHOWN HEREON IS BASED ON A BOUNDARY SURVEY PREPARED ROBERT H. VOGEL ENGINEERING, INC., DATED AUGUST 2005.
6. TOPOGRAPHY IS BASED ON A FIELD RUN TOPOGRAPHICAL SURVEY PERFORMED BY SILL, ADCOCK & ASSOCIATES, LLC DATED SEPTEMBER 2010.
7. PROPERTY ADDRESS: 12780 LIME KILN ROAD.
8. DEED REFERENCE: LIBER 12581, FOLIO 00082.
9. THE LOTS SHOWN HEREON COMPLY WITH THE MINIMUM OWNERSHIP, WIDTH AND LOT AREA AS REQUIRED BY THE MARYLAND DEPARTMENT OF THE ENVIRONMENT.
10. THE EXISTING WELLS SHOWN ON THIS PLAN, WELL TAG #95-1287 HAS BEEN FIELD LOCATED BY SILL, ADCOCK & ASSOCIATES, LLC IN SEPTEMBER 2010 AND IS ACCURATELY SHOWN.
11. NO GRADING, REMOVAL OF VEGETATIVE COVER OR TREES, PAVING AND NEW STRUCTURES SHALL BE PERMITTED WITHIN THE REQUIRED FOREST CONSERVATION EASEMENT AREAS.
12. THERE ARE NO FLOODPLAINS, WETLANDS, STREAMS, OR THEIR BUFFERS, HISTORIC STRUCTURES OR CEMETERIES LOCATED ON-SITE.
13. FOREST CONSERVATION HAS BEEN PROVIDED FOR THIS LOT UNDER F-06-107.
14. ANY CHANGES TO A PRIVATE SEWAGE EASEMENT SHALL REQUIRE A REVISED PERC CERTIFICATION PLAN.
15. ALL EXISTING WELLS, SEPTIC SYSTEMS AND SEWAGE DISPOSAL EASEMENTS WITHIN 100 FEET OF THE PROPERTY BOUNDARIES AND ALL EXISTING AND PROPOSED WELLS THAT ARE LOCATED WITHIN 200 FEET DOWN-GRADIENT OF EXISTING OR PROPOSED SEPTIC SYSTEMS AND SEWAGE DISPOSAL EASEMENTS HAVE BEEN FIELD LOCATED.
16. PERC HOLE LOCATIONS AND ELEVATIONS SHOWN BASED ON PERCOLATION CERTIFICATION PLAN SIGNED ON OCTOBER 1, 2007.
17. THE PURPOSE OF THIS AMENDED PERCOLATION CERTIFICATION PLAN IS TO REVISE THE LOCATION OF THE WELL BOX ON LOT 50.

**PLAN VIEW**  
SCALE: 1"=50'

SOILS LEGEND		
SYMBOL	NAME / DESCRIPTION	GROUP
GgB	GLADSTONE LOAM, 3 TO 8 PERCENT SLOPES	B

APPROVED: FOR PRIVATE WATER AND PRIVATE SEWAGE SYSTEMS IN ACCORDANCE WITH THE MASTER PLAN OF HOWARD COUNTY

*B. Nolan for Peter Beselmann* 11/29/2011  
COUNTY HEALTH OFFICER DATE  
HOWARD COUNTY HEALTH DEPARTMENT

LOT 49 3.1173 ACRES  
LOT 38 3.1497 ACRES  
LOT 39 3.3270 ACRES  
LOT 50 3.3970 ACRES  
LIME KILN ROAD INV. 412.70 15" ALCMP, TYPE 2 INV. 411.50

**DEVELOPER**

NV HOMES  
6085 MARSHALEE DRIVE, SUITE 130  
ELK RIDGE, MARYLAND 21075  
410.379.5956

**OWNER**

MAPLE ESTATES, LC  
5074 DORSEY HALL DRIVE, SUITE 205  
ELLCOTT CITY, MARYLAND 21042  
410-720-3021

**AMENDED PERCOLATION CERTIFICATION PLAN**

**LIME KILN VALLEY, PHASE I & II**

LOT 50 (FORMERLY LOT 39)  
12780 LIME KILN ROAD

TAX MAPS 40 & 45 GRIDS 21 & 4  
FIFTH ELECTION DISTRICT

PARCELS 114 & 12  
HOWARD COUNTY, MARYLAND

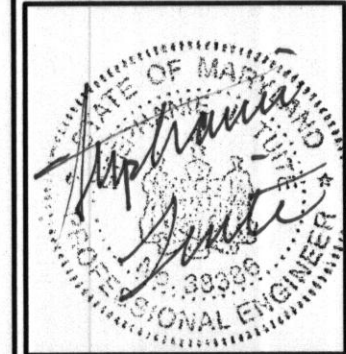

**Sill · Adcock & Associates · LLC**

Engineers · Surveyors · Planners  
3300 North Ridge Road, Suite 160  
Ellicott City, Maryland 21043  
Phone: 443.325.7682 Fax: 443.325.7685  
Email: info@saaland.com

DESIGN BY: SJT  
DRAWN BY: SJT  
CHECKED BY: PS  
SCALE: AS SHOWN  
DATE: NOVEMBER 4, 2011  
PROJECT #: 10-041  
SHEET #: 1 of 1

PROFESSIONAL CERTIFICATION: I HEREBY CERTIFY THAT THESE DOCUMENTS WERE PREPARED OR APPROVED BY ME, AND THAT I AM A DULY LICENSED PROFESSIONAL ENGINEER UNDER THE LAWS OF THE STATE OF MARYLAND, LICENSE NO. 38386, EXPIRATION DATE: JANUARY 12, 2012

E 1322755  
N 542367

Signed perc cert  
10-1-07

HEET 3 OF 3

BR33A1  
ELEV. = 409.50

EXISTING 150' RIGHT-OF-WAY  
POTOMAC ELECTRIC POWER COMPANY

LOT 38 IS SUBJECT TO A DEED OF 1957 AND 3884  
AT 7' 30" BRL  
POTOMAC ELECTRIC POWER COMPANY

LOT 39  
3.33 AC.

N 55°03'11"E 1069.73'

MF BR 38D1  
ELEV. = 419.00

MF BR38D2  
ELEV. = 427.90

MF BR38D  
ELEV. = 421.50

MF BR38A1  
ELEV. = 427.50

MF BR38C  
ELEV. = 422.50

MF 38E1 10593SF  
ELEV. = 420.50

MF BR38E2  
ELEV. = 424.00

MF BR38A2  
ELEV. = 425.50

MF BR38A3  
ELEV. = 432.00

N 52°33'20"W 165.90'

S 87°12'02"E 170.53'

N 55°00'44"E 369.04'  
222.13'

S 35°17'35"E 816.28'

BUILDING SETBACK LINE

GIB2

MIC3

30' BRL

S 55°00'44"W 146.90'

60' BRL

442.

GIB2

S 35°17'35"E 497'

30' BRL

GIB2

425

MIC3

GIB2

441.

GIB2

MIC3

440.

75' BRL

GIB2

442.

GIB2

425

E 1323615

N 542367