

# APPLICATION

PERCOLATION TESTING

A 516084

P \_\_\_\_\_

HOWARD COUNTY HEALTH DEPARTMENT  
BUREAU OF ENVIRONMENTAL HEALTH  
3525-H ELLICOTT MILLS DRIVE/ELLICOTT CITY, MARYLAND 21043  
TELEPHONE: 313-2640

DISTRICT \_\_\_\_\_

DATE \_\_\_\_\_

TO: THE COUNTY HEALTH OFFICER  
ELLICOTT CITY, MARYLAND

I HEREBY APPLY FOR THE NECESSARY TEST PRIOR TO APPLICATION FOR PERMIT TO CONSTRUCT (OR RECONSTRUCT) A SEWAGE DISPOSAL SYSTEM.

PROPERTY OWNER Security Development

ADDRESS P.O. Box 417, Ellicott City, MD PHONE (410) 465-4244  
21041

AGENT OR PROSPECTIVE BUYER \_\_\_\_\_

ADDRESS \_\_\_\_\_ PHONE \_\_\_\_\_

PROPERTY LOCATION:

SUBDIVISION Homewood LOT NO. \_\_\_\_\_

ROAD AND DESCRIPTION Homewood Road

TAX MAP 23+29 PARCEL # 20+86

SIZE OF LOT 1 Acre ± TYPE BLDG. SFD  
(SINGLE FAMILY DWELLING OR COMMERCIAL)

THE SYSTEM INSTALLED UNDER THIS APPLICATION IS ACCEPTABLE ONLY UNTIL PUBLIC FACILITIES BECOME AVAILABLE. I FULLY UNDERSTAND THE FEE CONNECTED WITH THE FILING OF THIS PERC TEST APPLICATION IS NON-REFUNDABLE UNDER ANY CIRCUMSTANCES. I ALSO AGREE TO COMPLY WITH ALL M.O.S.H.A. REQUIREMENTS IN TESTING THIS LOT.

(SIGNATURE OF APPLICANT)

APPROVED BY \_\_\_\_\_ FOR \_\_\_\_\_ DATE \_\_\_\_\_

DISAPPROVED BY \_\_\_\_\_ FOR \_\_\_\_\_ DATE \_\_\_\_\_

HOLD PENDING FURTHER TESTS \_\_\_\_\_

REASONS FOR REJECTION OR HOLDING \_\_\_\_\_

PERCOLATION TEST PLAT/PRELIMINARY PLAT - TITLE OR I.D. # \_\_\_\_\_ DATE \_\_\_\_\_

SITE DEVELOPMENT PLAN/FINAL PLAT - TITLE OR I.D. # \_\_\_\_\_ DATE \_\_\_\_\_

# THIS IS NOT A PERMIT

COUNTY #

SOIL PROFILE

(407)

Red Or  
Cherty  
Si'Cl Loam

1.5'

Red Or  
Cl Loam

2.5'

Red Or  
Loam

15-20%

Coarse Cherty  
Rock

4.5'

Red Or Mica  
Loam

SL

14'

(406)

Heavy Red  
Cl Loam

2'

Or Sa  
Cl Loam

6'

Or Red  
Sa Loam

5-10%

Cherty  
Slate

14'

SOIL PROFILE

0'

INDICATE NORTH - NAME ADJOINING ROADWAY AS BASE LINE.

DATE	TEST NO.	DEPTH	PRE-WET		TEST - 1" DROP		TIME	
			START	STOP	START	STOP		
3/26/03	(407)	6.5'/14'	1:29:45	1:39:30	1:39:30	2:05:30	26	O.K.
	406	7'/14'	1:43	1:47	1:47	1:52	5	O.K.

REMARKS \_\_\_\_\_

TYPE OF SOIL \_\_\_\_\_

TESTED BY John Boris ALSO PRESENT \_\_\_\_\_

TRENCH DESIGN DATA: AVERAGE PERCOLATION TIME \_\_\_\_\_ TRENCH WIDTH \_\_\_\_\_

INLET DEPTH \_\_\_\_\_ MAXIMUM BOTTOM DEPTH \_\_\_\_\_ SQ. FT./BEDROOM \_\_\_\_\_

# APPLICATION

PERCOLATION TESTING

A 516084

P \_\_\_\_\_

HOWARD COUNTY HEALTH DEPARTMENT  
BUREAU OF ENVIRONMENTAL HEALTH  
3525-H ELLICOTT MILLS DRIVE/ELLICOTT CITY, MARYLAND 21043  
TELEPHONE: 313-2640

DISTRICT \_\_\_\_\_

DATE \_\_\_\_\_

TO: THE COUNTY HEALTH OFFICER  
ELLICOTT CITY, MARYLAND

I HEREBY APPLY FOR THE NECESSARY TEST PRIOR TO APPLICATION FOR PERMIT TO CONSTRUCT (OR RECONSTRUCT) A SEWAGE DISPOSAL SYSTEM.

PROPERTY OWNER SECURITY DEVELOPMENT, L.L.C.  
P.O. BOX 417  
ADDRESS ELLICOTT CITY, MD 21041 PHONE 410-465-4244

AGENT OR PROSPECTIVE BUYER \_\_\_\_\_  
ADDRESS \_\_\_\_\_ PHONE \_\_\_\_\_

PROPERTY LOCATION:

SUBDIVISION HOMEWOOD LOT NO. 49

ROAD AND DESCRIPTION HOMEWOOD ROAD

TAX MAP 23 & 29 PARCEL # 20 & 86

SIZE OF LOT 1 ACRE ± TYPE BLDG. SINGLE FAMILY DETACHED  
(SINGLE FAMILY DWELLING OR COMMERCIAL)

THE SYSTEM INSTALLED UNDER THIS APPLICATION IS ACCEPTABLE ONLY UNTIL PUBLIC FACILITIES BECOME AVAILABLE. I FULLY UNDERSTAND THE

FEE CONNECTED WITH THE FILING OF THIS PERC TEST APPLICATION IS NON-REFUNDABLE UNDER ANY CIRCUMSTANCES. I ALSO AGREE TO

COMPLY WITH ALL M.O.S.H.A. REQUIREMENTS IN TESTING THIS LOT. By: [Signature] MEMBER  
(SIGNATURE OF APPLICANT) STEVE W. K. BIRFORD

APPROVED BY \_\_\_\_\_ FOR \_\_\_\_\_ DATE \_\_\_\_\_

DISAPPROVED BY \_\_\_\_\_ FOR \_\_\_\_\_ DATE \_\_\_\_\_

HOLD PENDING FURTHER TESTS \_\_\_\_\_

REASONS FOR REJECTION OR HOLDING \_\_\_\_\_

PERCOLATION TEST PLAT/PRELIMINARY PLAT - TITLE OR I.D. # \_\_\_\_\_ DATE \_\_\_\_\_

SITE DEVELOPMENT PLAN/FINAL PLAT - TITLE OR I.D. # \_\_\_\_\_ DATE \_\_\_\_\_

# THIS IS NOT A PERMIT

516084  
COUNTY #

SOIL PROFILE

49E

Red Br Heavy Loam Possible Fill

Non-Virgin Soil Altered Structure

8'?

14'

49C

Red Br Heavy Loam

Red Br Loam Transition

Beige Sa Loam ~5% Rock

5'

6.5'

49D

Red Br Heavy Loam

Red Br Loam Transition Layer

~10% Rock

15'

4.5'

5.0'

Tan Sa Loam

10-15% Rock

14.5'

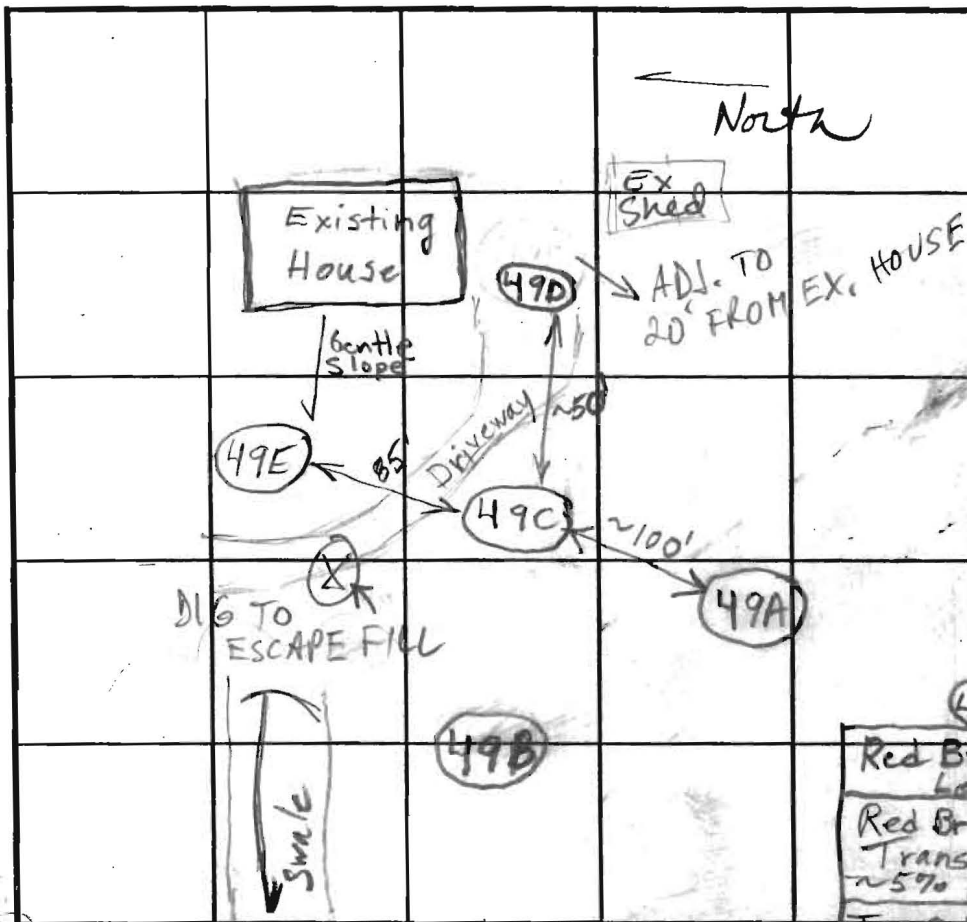

SOIL PROFILE

49A

Red Br Heavy Loam

Red Br Loam Transition Layer

Beige Sa Loam ~5% Rock

4'

7'

12.5'

49B

Red Br Heavy Loam

Red Br Loam Transition ~5% Rock

Tan Sa Loam 5-10% Rock

5.5-6'

6.5'

3.5'

INDICATE NORTH - NAME ADJOINING ROADWAY AS BASE LINE.

Homewood Road

DATE	TEST NO.	DEPTH	PRE-WET		TEST - 1" DROP		TIME	
			START	STOP	START	STOP		
4/17/02	49E	7' / 14'	3:40:26	3:43:28	3:43	3:57	8min	(F)
4/18/02	49C	6.5-7' / 15'	10:37	10:41	10:41	10:48	7	OK
	49D	6.5' / 14.5'	10:27:15	10:28:15	10:28:15	10:30:15	2	OK
		4.5'	10:39	~1/4" in 10 minutes			Slow	
	49C	5'	10:42	11:10	11:10	~1/4" in 20 min		Slow
	49D	5' 0" S	10:56	11:26	11:26		Slow	
	49A	6.5' / 12.5'	11:05	11:09	11:09	11:17:30	8 1/2	OK
		5'	11:15	~3/16" in 10 minutes			Slow	
	49B	6' 10" / 13.5'	11:31:30	11:35	11:35	12:41	6	OK
		5'		~1/4" in 10 minutes			Slow	

REMARKS 49D to 49C in field 50'; on plan 80'. Holes Per plan  
 DRIVEWAY area not suitable for SDA  
 TESTED BY BB/KG ALSO PRESENT HATFIELD'S  
 TRENCH DESIGN DATA: AVERAGE PERCOLATION TIME \_\_\_\_\_ TRENCH WIDTH \_\_\_\_\_  
 INLET DEPTH \_\_\_\_\_ MAXIMUM BOTTOM DEPTH \_\_\_\_\_ SQ. FT./BEDROOM \_\_\_\_\_

**NOTES:**

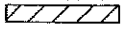
1. THE LOT SHOWN HEREON WAS RECORDED ON THE PLAT FOR RIVERWOOD, PHASE 1, PLAT Nos. 18031 - 18045 OR PHASE 2, PLAT Nos. 19720 - 19726. REFER TO THE PLAT FOR LOT DIMENSIONS, LOT AREAS AND ALL EASEMENTS.
2.  THIS AREA DESIGNATES A PRIVATE SEWERAGE EASEMENT OF 10,000 SQUARE FEET AS REQUIRED BY THE STATE DEPARTMENT OF THE ENVIRONMENT FOR INDIVIDUAL SEWERAGE DISPOSAL. IMPROVEMENTS OF ANY NATURE IN THIS AREA IS RESTRICTED UNTIL PUBLIC SEWER IS AVAILABLE. THIS EASEMENT SHALL BECOME NULL AND VOID UPON CONNECTION TO A PUBLIC SEWERAGE SYSTEM. THE COUNTY HEALTH OFFICER SHALL HAVE THE AUTHORITY TO GRANT ADJUSTMENTS TO THE PRIVATE SEWERAGE EASEMENT. ANY CHANGES TO A PRIVATE SEWERAGE EASEMENT SHALL REQUIRE A REVISED PERCOLATION CERTIFICATION PLAN. RECORDATION OF A MODIFIED SEWERAGE EASEMENT PLAT SHALL NOT BE NECESSARY.
3. TOPOGRAPHY SHOWN HEREON IS TAKEN FROM THE APPROVED ROAD CONSTRUCTION PLANS.
4. SEPTIC TANK FOR THIS LOT TO BE 2,000 GALLONS.
5. THE EXISTING WELL SHOWN ON THIS PLAN, HO-95-0014, HAS BEEN FIELD LOCATED BY BENCHMARK ENGINEERING, INC. AND IS ACCURATELY SHOWN.

I CERTIFY THAT THE INFORMATION SHOWN HEREON IS BASED ON FIELD WORK PERFORMED BY ME OR UNDER MY DIRECT SUPERVISION, AND IS CORRECT, TO THE BEST OF KNOWLEDGE AND BELIEF.







*John M. Carney* 7/15/08

PLAN PREPARER  
JOHN M. CARNEY FOR BENCHMARK ENGINEERING, INC.

APPROVED:  
FOR PRIVATE WATER AND PRIVATE SEWERAGE SYSTEMS  
HOWARD COUNTY HEALTH DEPARTMENT

*Richard J. Davis* 8/6/08  
COUNTY HEALTH OFFICER DATE

**LEGEND**

-  EXISTING CONTOURS ESTABLISHED UNDER F-04-082
-  FIELD SURVEYED WELL LOCATION
-  7001A PASSED PERCOLATION TEST PER CERTIFICATION PLANS
-  402.8 FAILED PERCOLATION TEST PER CERTIFICATION PLANS
-  62-A 397.1 FAILED SAND MOUND TEST PER CERTIFICATION PLANS
-  SM-32 397.1 FAILED SAND MOUND TEST PER CERTIFICATION PLANS

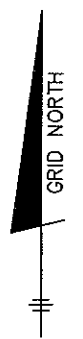

**BENCHMARK**  
ENGINEERS ▲ LAND SURVEYORS ▲ PLANNERS  
**ENGINEERING, INC.**

8480 BALTIMORE NATIONAL PIKE ▲ SUITE 418  
ELLICOTT CITY, MARYLAND 21043  
PHONE: 410-465-6105 FAX: 410-465-6644  
www.bei-civilengineering.com

**RIVERWOOD**  
**LOT 29**

11200 KINSALE COURT, ELLICOTT CITY, MD 21042  
TAX MAP 29, GRIDS 3, 4, 9 & 10 - PARCEL 20  
3rd ELECTION DISTRICT  
HOWARD COUNTY, MARYLAND

BUILDER:  
CAMBERLEY HOMES, INC.  
6905 ROCKLEDGE DRIVE  
SUITE 800  
BETHESDA, MARYLAND 20817  
301-803-4929

<b>REVISED PERCOLATION CERTIFICATION PLAN</b>	
DATE: JULY 15, 2008	PROJECT NO. 1950
SCALE: 1" = 50'	DRAWING 1 OF 1



