

APPLICATION

FOR PERCOLATION TESTING AND SITE EVALUATION

TEST DATE(S) _____ TEST TIME _____ A/P _____

AGENCY REVIEW: _____ DATE _____

DO NOT WRITE ABOVE THIS LINE

I HEREBY APPLY FOR THE NECESSARY TESTING/EVALUATION PRIOR TO ISSUANCE OF SEWAGE DISPOSAL SYSTEM PERMIT(S) TO:

CHECK AS NEEDED:

- CONSTRUCT NEW SEPTIC SYSTEM(S)
- REPAIR/ADD TO AN EXISTING SEPTIC SYSTEM
- REPLACE AN EXISTING SEPTIC SYSTEM

CHECK AS NEEDED:

- NEW STRUCTURE(S)
- ADDITION TO AN EXISTING STRUCTURE
- REPLACE AN EXISTING STRUCTURE

CHECK ONE:

- CREATE NEW LOT(S)
- BUILD ON AN EXISTING LOT IN A SUBDIVISION
- BUILD ON AN EXISTING PARCEL OF RECORD

IS THE PROPERTY WITHIN 2500' OF ANY RESERVOIR?

- YES
- NO

THE TYPE OF STRUCTURE IS:

- RESIDENTIAL WITH _____ PROPOSED BEDROOMS IN THE COMPLETED STRUCTURE (NOTE **UNKNOWN** IF APPROPRIATE)
- COMMERCIAL (PROVIDE DETAIL OF NUMBERS AND TYPES OF EMPLOYEES/ CUSTOMERS ON ACCOMPANYING PLAN)
- INSTITUTIONAL/GOVERNMENT (PROVIDE DETAIL OF NUMBERS AND TYPES OF EMPLOYEES/USERS ON ACCOMPANYING PLAN)

PROPERTY OWNER(S) Cindy Porter

DAYTIME PHONE 301 854 6671 CELL _____ FAX _____

MAILING ADDRESS 3760 Jennings Chapel Rd Woodbine
STREET CITY/TOWN STATE ZIP

APPLICANT Fogle's Septic Clean, Inc / Kurt Cassell

DAYTIME PHONE 410 795-5670 CELL 410 984-5211 FAX 410 795-3432

MAILING ADDRESS 580 Obrecht Rd Sykesville, MD 21784
STREET CITY/TOWN STATE ZIP

APPLICANT'S ROLE: DEVELOPER BUILDER BUYER RELATIVE/FRIEND REALTOR **CONSULTANT**

PROPERTY LOCATION

SUBDIVISION/PROPERTY NAME _____ LOT NO. _____

PROPERTY ADDRESS 3760 Jennings Chapel Rd Woodbine
STREET TOWN/POST OFFICE

TAX MAP PAGE(S) 20 GRID 11 PARCEL(S) 13 PROPOSED LOT SIZE 5.3

AS APPLICANT, I UNDERSTAND THE FOLLOWING: THE SYSTEM INSTALLED SUBSEQUENT TO THIS APPLICATION IS ACCEPTABLE ONLY UNTIL PUBLIC SEWERAGE IS AVAILABLE. THIS APPLICATION IS COMPLETE WHEN ALL APPLICABLE FEES AND A SUITABLE SITE PLAN HAVE BEEN RECEIVED. I ACCEPT THE RESPONSIBILITY FOR COMPLIANCE WITH ALL M.O.S.H.A. AND "MISS UTILITY" REQUIREMENTS. APPROVAL IS BASED UPON SATISFACTORY REVIEW OF A PERC CERTIFICATION PLAN.

TEST RESULTS WILL BE MAILED TO APPLICANT.

Kurt A. Cassell
SIGNATURE OF APPLICANT

HOWARD COUNTY HEALTH DEPARTMENT, BUREAU OF ENVIRONMENTAL HEALTH, WELL AND SEPTIC PROGRAM
7178 COLUMBIA GATEWAY DRIVE COLUMBIA, MARYLAND 21046 (410) 313-1771 FAX (410) 313-2648
TDD (410) 313-2323 TOLL FREE 1-877-4MD-DHMH

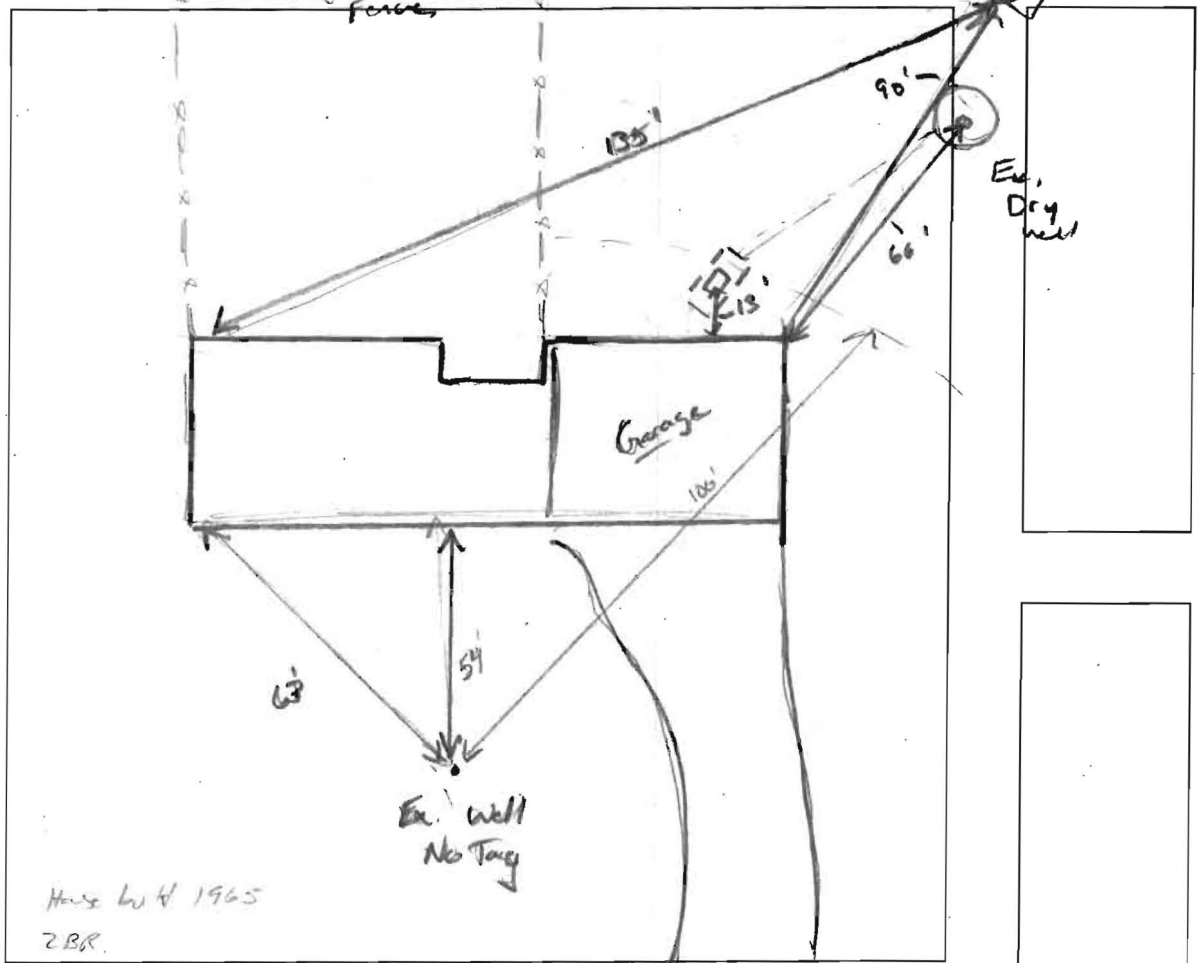

(A)

8' OM MCBK
many fine roots

CL Red/or
SBK, CW

3' many roots
FSL, Frimb

7' om. roots
15% splintery
shale,
SL, Frimb

↓
15% separate
masses.

↓

15'

| DATE | TEST # | DEPTH | START | BREAK 1" DROP | STOP 2" DROP | TIME OF 2ND INCH | P/F/H |
|---------|--------|------------|-------|------------------|-----------------|---------------------|-------|
| 5/20/10 | (A) | 4'8" / 15' | 11:16 | 11:18 | 11:21 | 3 | P |
| | | Repair | 11:23 | 11:28 | 11:31 | 3 | P |
| | | | | | | | |
| | | | | | | | |
| | | | | | | | |
| | | | | | | | |
| | | | | | | | |
| | | | | | | | |
| | | | | | | | |
| | | | | | | | |
| | | | | | | | |
| | | | | | | | |

ZBR

REMARKS System sized for ZBR.

SANITARIAN K. Wolf BACKHOE Jerry (Eugene) OTHERS _____

TEST HOLES USED IN SDA 1 AVG. PERC TIME 3 SQ. FT/BR _____

TRENCH WIDTH 2 INLET DEPTH 4 MAX. BOT DEPTH 8 EFFECTIVE S/W 4'

(150) 3 = 450