

LAYOUT 6/2/2011 INSP 4 _____
 INSP 2 6/3/2011 INSP 5 _____
 INSP 3 6/6/2011 INSP 6 _____

ISSUE DATE: 6-1-11

PERMIT

P 535231

APPROVAL DATE: 6/7/2011

A _____

Tax ID # 05-443199

**ON-SITE SEWAGE DISPOSAL SYSTEM
 HOWARD COUNTY HEALTH DEPARTMENT
 BUREAU OF ENVIRONMENTAL HEALTH**

Fogles Septic Clean Inc IS PERMITTED TO INSTALL ALTER

ADDRESS: 580 Obrecht Rd Sykesville MD 21784 PHONE NUMBER: 410-795-5870

SUBDIVISION: Homewood Crossing LOT NUMBER: 56

ADDRESS: 11259 Independence Way PROPERTY OWNER: Toll MD III LP

SEPTIC TANK CAPACITY (GALLONS): 2000 OUTLET BAFFLE FILTER REQUIRED

PUMP CHAMBER CAPACITY (GALLONS): _____ COMPARTMENTED TANK REQUIRED

NUMBER OF BEDROOMS: 5 APPLICATION RATE: 0.8

SQUARE FOOTAGE OF HOUSE: _____

LINEAR FEET OF TRENCH REQUIRED: 207.5

TRENCHES:	Trenches to be 3.0 feet wide. Inlet 4.0 feet below original grade. Bottom maximum depth 6.0 feet below original grade. Effective area begins at 5.0 feet below original grade with 2.0 feet of stone below distribution pipe.
LOCATION:	Set septic tank per layout inspection. Set distribution box at the highest point in the center at the top of the easement per layout inspection. Install 207.5 feet of trench on contour per layout inspection
NOTES:	Do not order the septic tank until after layout inspection and Sanitarian approval. Stake easement corners. Call for layout inspection. Mark utilities. Gravel tickets must be available for Environmental Sanitarians. Stone must be approved by the Howard County Health Department. A written variance request is required for tanks deeper than 3 feet. A traffic bearing lid is required for tanks deeper than 4 feet.

PLANS APPROVED: Dana Bernard DATE: 2/14/2011

- NOTE: PERMIT VOID AFTER 2 YEARS
- NOTE: CONTRACTOR RESPONSIBLE FOR SCHEDULING A PRE-CONSTRUCTION INSPECTION FOR ALL INSTALLATIONS
- NOTE: WATERTIGHT SEPTIC TANKS REQUIRED
- NOTE: ALL PARTS OF SEPTIC SYSTEM SHALL BE 100 FEET FROM ANY WATER WELL
- NOTE: MANHOLE RISERS REQUIRED ON ALL SEPTIC TANKS AND PUMP CHAMBERS

NEITHER THE HOWARD COUNTY COUNCIL OR THE HEALTH DEPARTMENT IS RESPONSIBLE FOR THE SUCCESSFUL OPERATION OF ANY SYSTEM
PERMITTEE RESPONSIBLE FOR OBTAINING FINAL APPROVAL ON THIS PERMIT
CALL 410-313-1771 FOR INSPECTION OF SEPTIC SYSTEM

NOT TO SCALE

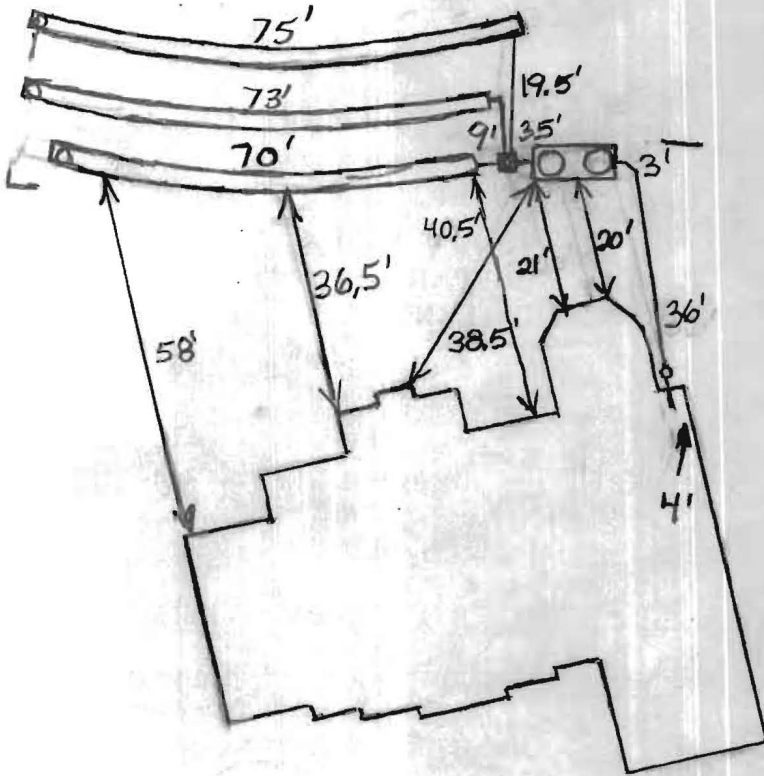

0 x 30070124

30

ROAD NAME

TRENCH/DRAINFIELD DATA

WIDTH 3' INLET 4'-4.5' BOTTOM 6'-6.5'
 NUMBER OF TRENCHES 3
 TOTAL LENGTH 218
 ABSORPTION AREA 654+Sidewall
 DISTRIBUTION BOX LEVEL Levelers
 DISTRIBUTION BOX BAFFLE Yes
 DISTRIBUTION BOX PORT Yes

SEPTIC TANK DATA

SEPTIC TANK 1 LEVEL Yes
 MANUFACTURER Babylon
 CAPACITY 2000 GAL
 SEAM LOC Top
 TANK LID DEPTH 0.5-1.5'
 BAFFLES Need Front Ext.
 BAFFLE FILTER No
 MANHOLE LOC Front + Rear
 6" PORT LOC None
 WATERTIGHT TEST No
 SLOTTED Yes
 DATE ON LID Dry
 PUMP/SEPTIC TANK LEVEL N/A
 MANUFACTURER _____
 CAPACITY _____ GAL
 SEAM LOC _____
 TANK LID DEPTH _____
 BAFFLES _____
 BAFFLE FILTER _____
 MANHOLE LOC _____
 6" PORT LOC _____
 WATERTIGHT TEST _____
 SLOTTED _____
 DATE ON LID _____

PRE-CONSTRUCTION:

6/2/2011 Connection coming out under footer on opposite side of house as per B.P. plan. Set the tank 20' from the rear of the house and install three 70' trenches on contour towards lot 54 (BB)

INSTALLATION: 6/3/2011 Tank set. House connection made. (BB)

6/6/2011 Working on first trench. (BB)

6/7/2011 System finished. O.K. to backfill. (BB)

FINAL INSPECTOR B. Baker

DATE OF APPROVAL 6/7/2011

