

LAYOUT 4/5/10 INSP 4 _____
INSP 2 4/22/10 INSP 5 _____
INSP 3 4/23/10 INSP 6 _____

ISSUE DATE: 2/22/10

PERMIT

P 532563

APPROVAL DATE: 5/4/10

A _____

Tax ID # 05443296

**ON-SITE SEWAGE DISPOSAL SYSTEM
HOWARD COUNTY HEALTH DEPARTMENT
BUREAU OF ENVIRONMENTAL HEALTH**

Fogles Septic Clean, Inc IS PERMITTED TO INSTALL ALTER
ADDRESS: 580 Obrecht Road, Sykesville 21784 PHONE NUMBER: 410-795-5670
SUBDIVISION: Homewood Crossing II LOT NUMBER: 65
ADDRESS: 11216 Independence Way PROPERTY OWNER: Toll MD III LP
SEPTIC TANK CAPACITY (GALLONS): 2000 OUTLET BAFFLE FILTER REQUIRED
PUMP CHAMBER CAPACITY (GALLONS): N/A COMPARTMENTED TANK REQUIRED
NUMBER OF BEDROOMS: 4 APPLICATION RATE: 1.2
SQUARE FOOTAGE OF HOUSE: _____
LINEAR FEET OF TRENCH REQUIRED: 145

TRENCHES:	Trenches to be 2.0 feet wide. Inlet 3.0 feet below original grade. Bottom maximum depth 8.0 feet below grade. Effective area begins at 6.0 feet below original grade. 5.0 feet of stone below distribution pipe.
LOCATION:	Set septic tank per layout inspection. Set distribution box about 5 feet into septic reserve, 40' from west septic reserve corner. Install 1 x 45' trench on contour toward west boundary, and 2 x 50' trenches from about south boundary to west boundary.
NOTES:	Stake septic easement corners. Call for layout inspection. Mark utilities. Gravel must meet Health Department standards; Subject to approval by Environmental Sanitarians.

PLANS APPROVED: Robert Bricker DATE: 10/27/09

- NOTE: PERMIT VOID AFTER 2 YEARS
- NOTE: CONTRACTOR RESPONSIBLE FOR SCHEDULING A PRE-CONSTRUCTION INSPECTION FOR ALL INSTALLATIONS
- NOTE: WATERTIGHT SEPTIC TANKS REQUIRED
- NOTE: ALL PARTS OF SEPTIC SYSTEM SHALL BE 100 FEET FROM ANY WATER WELL
- NOTE: MANHOLE RISERS REQUIRED ON ALL SEPTIC TANKS AND PUMP CHAMBERS

**NEITHER THE HOWARD COUNTY COUNCIL OR THE HEALTH DEPARTMENT IS
RESPONSIBLE FOR THE SUCCESSFUL OPERATION OF ANY SYSTEM
PERMITTEE RESPONSIBLE FOR OBTAINING FINAL APPROVAL ON THIS PERMIT
CALL 410-313-1771 FOR INSPECTION OF SEPTIC SYSTEM**

THIS WALLCHECK WAS PREPARED WITHOUT THE BENEFIT OF A CURRENT TITLE REPORT. THIS PROPERTY IS SUBJECT TO ANY AND ALL EASEMENTS, RIGHT-OF-WAYS, COVENANTS, AND RESTRICTIONS, ETC. OF RECORD, SOME OR ALL OF WHICH MAY OR MAY NOT BE SHOWN AND/OR REFERENCED HEREON. BEARINGS AND DISTANCES OF THE PROPERTY BOUNDARY LINES SHOWN HEREON ARE PER AVAILABLE RECORDS AND HAVE NOT BEEN FIELD VERIFIED.
 THIS IS NOT A "LOCATION DRAWING" AND IS NOT TO BE USED FOR SETTLEMENT PURPOSES.

LEGEND:

EXISTING WELL



PROPOSED WELL BOX (1,586 S.F.)

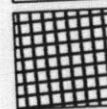

EXISTING SEPTIC AREA



*Wall Check
OK DB 3-23-10*

NON-BUILDABLE PRES. PARCEL K

PRIVATE S.W.M. DRAINAGE AND UTILITY ESM'T. FOR BMP NO. 9

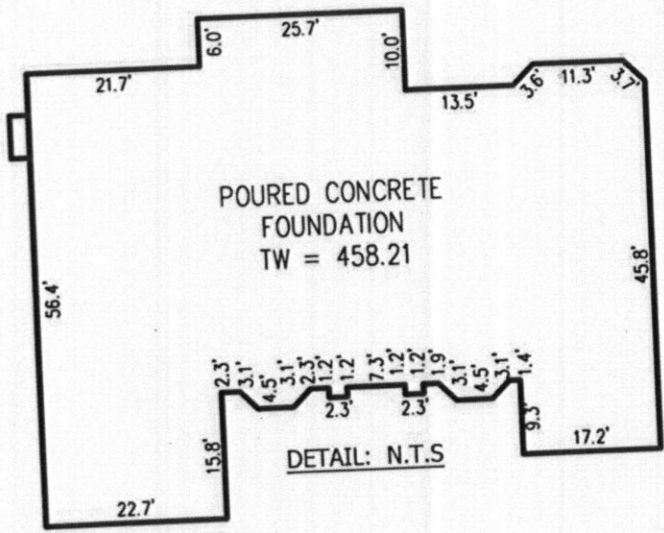

ADDRESS: 11216 INDEPENDENCE WA
ELLICOTT CITY, MD 2104

BUILDING SETBACKS (B.R.L.'s) SHOWN HEREON PER SITE DEVELOPEMENT PLAN SETBACK DISTANCES SHOWN HEREON AS "±" HAVE AN ACCURACY OF ±0.1' FOOT.



SURVEYOR'S CERTIFICATE
 I HEREBY CERTIFY THAT THE POSITION OF THE EXISTING IMPROVEMENTS SHOWN HEREON HAVE BEEN CAREFULLY ESTABLISHED BY ACCEPTED LAND SURVEYING PRACTICES AND THAT, UNLESS SHOWN, THERE ARE NO VISIBLE ENCROACHMENTS EITHER WAY ACROSS THE PROPERTY LINES. THE PLANS IS OF BENEFIT TO A CONSUMER ONLY INsofar AS IT IS REQUIRED BY A LENDER OR A TITLE INSURANCE COMPANY OR ITS AGENT IN CONNECTION WITH CONTEMPLATED TRANSFER, FINANCING, OR REFINANCING. THE PLAN IS NOT TO BE RELIED UPON FOR THE ESTABLISHMENT OR LOCATION OF FENCES, GARAGES, BUILDINGS, OR OTHER EXISTING OR FUTURE IMPROVEMENTS. THE PLAN DOES NOT PROVIDE FOR THE ACCURATE IDENTIFICATION OF PROPERTY BOUNDARY LINES, BUT SUCH IDENTIFICATION MAY NOT BE REQUIRED FOR THE TRANSFER OF TITLE OR SECURING FINANCING OR REFINANCING. THIS DRAWING WAS PREPARED W/O THE BENEFIT OF A TITLE REPORT.

SIGNATURE: MICHAEL JOE BOYCE
 21328 MD. LIC NO.
 DATE

WALLCHECK
 LOT #65
HOMWOOD CROSSING
 D.B. 9808, PG. 204
 PLAT No. 18245
 THIRD ELECTION DISTRICT
 HOWARD COUNTY

ESE Land Planning
 Engineering
 Land Surveying

ESE Consultants Inc.
 7164 Columbia Gateway Dr
 Suite 203
 Columbia, MD 21046
 TEL: 410-872-9105
 FAX: 410-872-4870

DATE: 11/17/09 SCALE: 1"=50' FILE: WC-65
 CHK'D: MJB JOB#: 1214 DRAWN: GTC