

No Records

PERMIT

P 514634-A

SEWAGE DISPOSAL SYSTEM
HOWARD COUNTY HEALTH DEPARTMENT
BUREAU OF ENVIRONMENTAL HEALTH
410-313-2640

REPAIR

ISSUE DATE 11/28/2000

APPROVAL DATE 12/4/00

RPS# ?

INDEXED

Hatfield's Equipment IS PERMITTED TO INSTALL ALTER X

ADDRESS 13785 Burnt woods Road, Glenelg, MD 21737 PHONE 301-854-6172

SUBDIVISION LOT NUMBER ADDRESS 4382 Linthicum Road

PROPERTY OWNER Herb Kirch PROPERTY OWNER'S ADDRESS Same

SEPTIC TANK CAPACITY ex 1000 GALLONS

PUMP CHAMBER CAPACITY N/A GALLONS

NUMBER OF BEDROOMS 2

SQUARE FEET PER BEDROOM 180

LINEAR FEET OF TRENCH REQUIRED 120

TRENCHES: Trenches to be 3 feet wide. Inlet 4 feet below original grade. Bottom maximum depth 6 feet below original grade. 2 feet of stone below distribution box.

LOCATION:

REPAIR - PURPOSE - Existing Septic system has failed.

Call for inspection when ground is opened so sanitarian can recommend repair. 11/28

Install D.Box off of ex. septic tank. Run 2-60' trenches off of D.Box but also have D.Box serve ex. drywell (allowing for drywell to take water but not as much as trenches) (Use levelers) Keep trenches 10' Center to Center to conserve future repairs, keep trench 100' away from ex. well.

PLANS APPROVED SRK DATE 12/4/00

PERMIT VOID AFTER 2 YEARS

NOTE: CONTRACTOR RESPONSIBLE FOR SCHEDULING A PRE-CONSTRUCTION INSPECTION FOR ALL INSTALLATIONS

NOTE: TOP OF SEPTIC TANKS ARE TO BE NO DEEPER THAN 3.0 FEET BELOW FINISH GRADE

NOTE: WATERTIGHT SEPTIC TANKS REQUIRED

NOTE: CLEANOUT REQUIRED EVERY 70 FEET OF SEWER LINE AND/OR AT 90° SWEEPS IN LINES FROM HOUSE TO DRAIN FIELDS, 90° ELBOWS ARE NOT ACCEPTABLE

NOTE: ALL PARTS OF SEPTIC SYSTEMS (I.E. TANK, DISTRIBUTION BOX, DRAINFIELDS) TO BE 100 FEET FROM ANY WATER WELL UNLESS OTHERWISE SPECIFICALLY AUTHORIZED

NOTE: NO ABSORPTION TRENCH TO EXCEED 100 FEET IN LENGTH UNLESS SPECIFICALLY AUTHORIZED

NOTE: ALL PIPE FROM HOUSE TO SEPTIC TANK MUST BE CAST IRON OR SCHEDULE 35/40 PVC OR ABS

NOTE: MANHOLE RISERS REQUIRED ON ALL SEPTIC TANKS AND PUMP CHAMBERS

NOTE: DISTRIBUTION BOXES MUST HAVE BAFFLES

NOTE: IF PUMPED SEPTIC SYSTEM REQUIRED, (1) SEPTIC PUMP DETAIL TO BE PROVIDED BY INSTALLER PRIOR TO ISSUANCE OF SEPTIC PERMIT (2) PUMP PERFORMANCE TEST IS NECESSARY PRIOR TO HEALTH DEPARTMENT APPROVAL OF SEPTIC PERMIT

NEITHER THE HOWARD COUNTY COUNCIL NOR THE HEALTH DEPARTMENT IS RESPONSIBLE FOR THE SUCCESSFUL OPERATION OF ANY SYSTEM
PERMITTEE RESPONSIBLE FOR OBTAINING FINAL APPROVAL ON THIS PERMIT
CALL 410-313-2640 FOR INSPECTION OF SEPTIC SYSTEM

514634

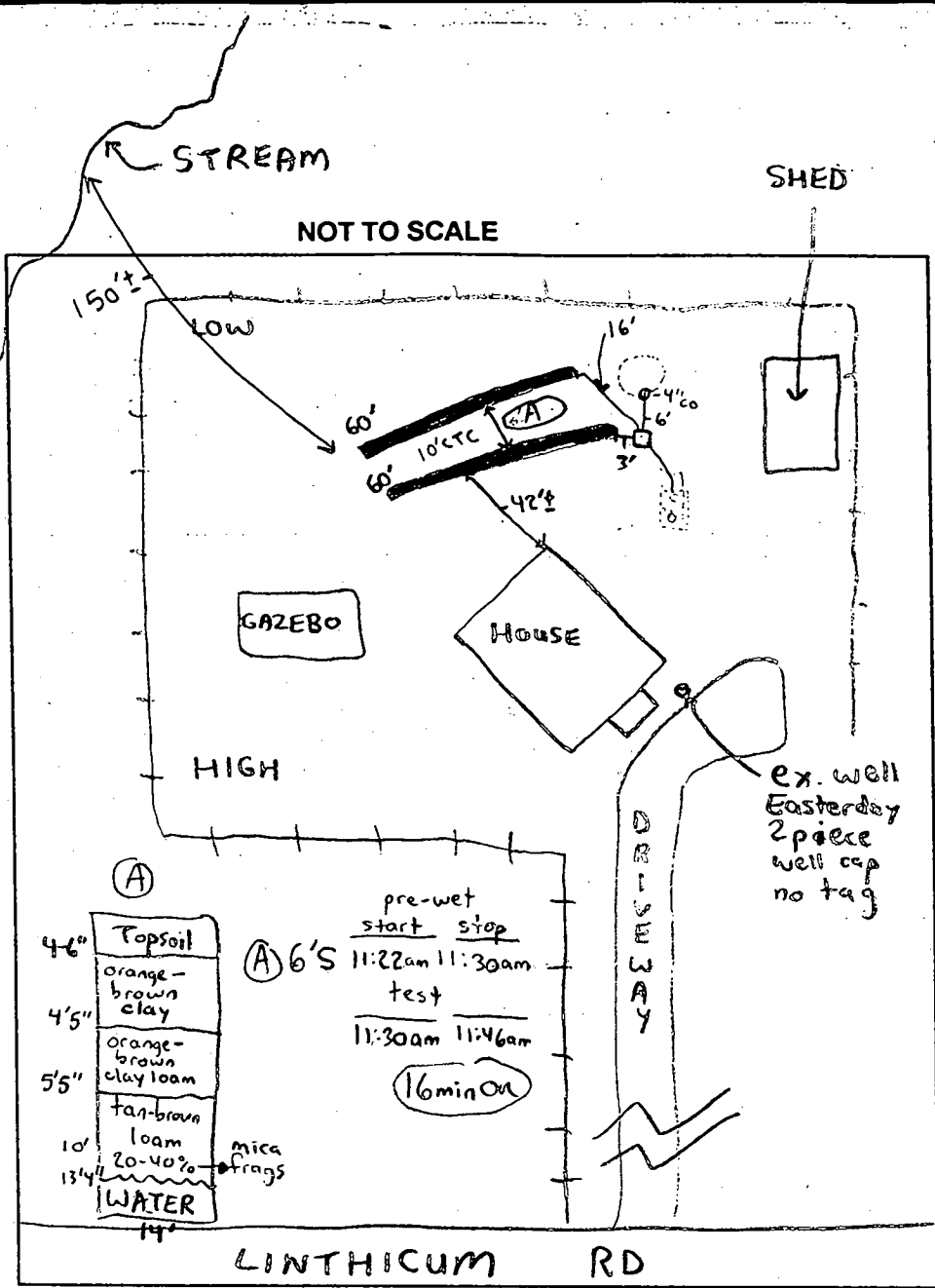

TRENCH DATA

TRENCH WIDTH	3'
TRENCH INLET DEPTH	4'
TRENCH BOTTOM DEPTH	6'
DEPTH OF STONE	2'
NUMBER OF TRENCHES	2
TOTAL TRENCH LENGTH	120'
ABSORBENT AREA	360 ft ²
DISTRIBUTION BOX LEVEL	✓
BAFFLE IN DISTRIBUTION BOX	✓

SEPTIC TANK DATA

SEPTIC TANK	ex: 1000 GALLONS
MANHOLE RISER	N/A
6 INCH INSPECTION PORT	ex: 1 on front, 1 on rear

PUMP CHAMBER DATA

PUMP CHAMBER GALLONS	N/A
MANHOLE RISER	N/A
ALARM	N/A
PUMP PERFORMANCE TEST	N/A

PRE-CONSTRUCTION INSPECTION: 12/4/00 - HOLE DUG IN LOCATION (A) SEE PROFILE & TEST
 INSTALL SYSTEM AS SPECIFIED ON FRONT OF PERMIT (SR#)

INSPECTION COMMENTS: OK TO COVER ALL WORK, LIMITED AREA EXISTS FOR
 FUTURE REPAIRS (SR#)

INSPECTOR Steven R. Krieg DATE SYSTEM APPROVED 12/4/00