

6/19/00 10AM  
7/11/00 PM

# PERMIT

## SEWAGE DISPOSAL SYSTEM

HOWARD COUNTY HEALTH DEPARTMENT  
BUREAU OF ENVIRONMENTAL HEALTH  
410-313-2640

P 513634

A REPAIR

ISSUE DATE 6/13/2000

APPROVAL DATE 7/11/00

INDEXED

03-297411

Freedom Sanitation IS PERMITTED TO INSTALL ALTER X

ADDRESS 239 West Old Liberty Road, Eldersburg, MD 21784 PHONE 410-795-2947

SUBDIVISION Indian Hill LOT NUMBER 3 ADDRESS 12575 Indian Hill Drive

PROPERTY OWNER Richard Thomas PROPERTY OWNER'S ADDRESS

SEPTIC TANK CAPACITY 150-1000 GALLONS Existing

PUMP CHAMBER CAPACITY GALLONS

NUMBER OF BEDROOMS 3

SQUARE FEET PER BEDROOM

LINEAR FEET OF TRENCH REQUIRED

TRENCHES: Trenches to be 3.0' feet wide. Inlet 4.0' feet below original grade. Bottom maximum depth 5.5' feet below original grade. 1.5' feet of stone below distribution box.

LOCATION:

REPAIR - PURPOSE - Existing septic system has failed.

Call for inspection when ground is opened so sanitarian can recommend repair. 6-19-2000

PLANS APPROVED Brian Baker DATE 6/19/00

PERMIT VOID AFTER 2 YEARS

NOTE: CONTRACTOR RESPONSIBLE FOR SCHEDULING A PRE-CONSTRUCTION INSPECTION FOR ALL INSTALLATIONS

NOTE: TOP OF SEPTIC TANKS ARE TO BE NO DEEPER THAN 3.0 FEET BELOW FINISH GRADE

NOTE: WATERTIGHT SEPTIC TANKS REQUIRED

NOTE: CLEANOUT REQUIRED EVERY 70 FEET OF SEWER LINE AND/OR AT 90° SWEEPS IN LINES FROM HOUSE TO DRAIN FIELDS, 90° ELBOWS ARE NOT ACCEPTABLE

NOTE: ALL PARTS OF SEPTIC SYSTEMS (I.E. TANK, DISTRIBUTION BOX, DRAINFIELDS) TO BE 100 FEET FROM ANY WATER WELL UNLESS OTHERWISE SPECIFICALLY AUTHORIZED

NOTE: NO ABSORPTION TRENCH TO EXCEED 100 FEET IN LENGTH UNLESS SPECIFICALLY AUTHORIZED

NOTE: ALL PIPE FROM HOUSE TO SEPTIC TANK MUST BE CAST IRON OR SCHEDULE 35/40 PVC OR ABS

NOTE: MANHOLE RISERS REQUIRED ON ALL SEPTIC TANKS AND PUMP CHAMBERS

NOTE: DISTRIBUTION BOXES MUST HAVE BAFFLES

NOTE: IF PUMPED SEPTIC SYSTEM REQUIRED, (1) SEPTIC PUMP DETAIL TO BE PROVIDED BY INSTALLER PRIOR TO ISSUANCE OF SEPTIC PERMIT (2) PUMP PERFORMANCE TEST IS NECESSARY PRIOR TO HEALTH DEPARTMENT APPROVAL OF SEPTIC PERMIT

NEITHER THE HOWARD COUNTY COUNCIL NOR THE HEALTH DEPARTMENT IS RESPONSIBLE FOR THE SUCCESSFUL OPERATION OF ANY SYSTEM  
PERMITTEE RESPONSIBLE FOR OBTAINING FINAL APPROVAL ON THIS PERMIT  
CALL 410-313-2640 FOR INSPECTION OF SEPTIC SYSTEM

513634

4.5'	Or Brown Clay Loam
	Red Brown Clay Loam
	25-30% Rock
12'	Wet
13'	Water
14'	

14' Visual  
4' - Pulled Slow  
5' - 18min  
7.5' - 8min

4.5'	Red Brown Clay Loam
	Or Brown Clay Loam
	25-30% Rock
9.5'	Caving, Wet
11.5'	Water
14'	

14' Visual  
4' - Pulled, Slow  
6.0' - 13min

NOT TO SCALE

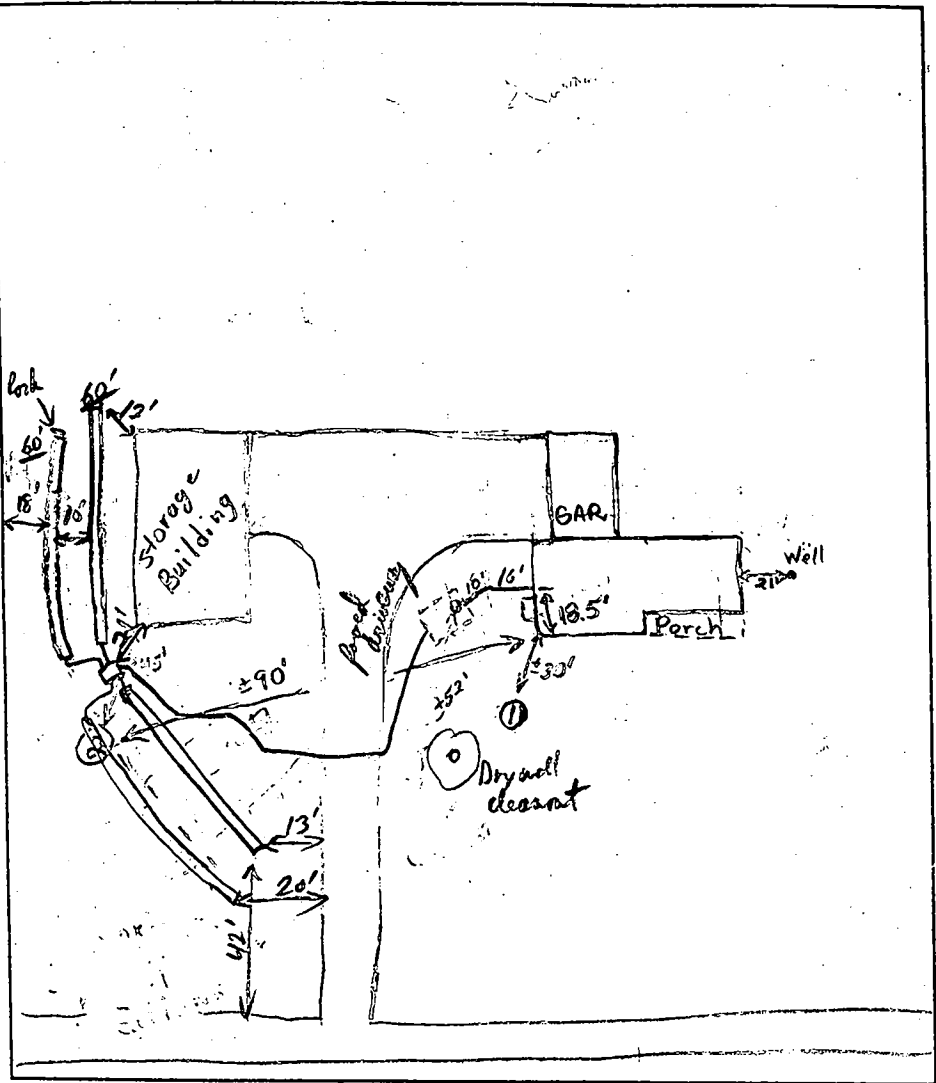

TRENCH DATA	
TRENCH WIDTH	3.0'
TRENCH INLET DEPTH	4.0'
TRENCH BOTTOM DEPTH	5.5'
DEPTH OF STONE	1.5'
NUMBER OF TRENCHES	4x60'
TOTAL TRENCH LENGTH	240'
ABSORBENT AREA	720 sq. ft.
DISTRIBUTION BOX LEVEL	(used auto levels) ✓
BAFFLE IN DISTRIBUTION BOX	✓

SEPTIC TANK DATA	
SEPTIC TANK	750-1000 GALLONS
MANHOLE RISER	No
6 INCH INSPECTION PORT	Yes
PUMP CHAMBER DATA	
PUMP CHAMBER GALLONS	N/A
MANHOLE RISER	—
ALARM	—
PUMP PERFORMANCE TEST	—

PRE-CONSTRUCTION INSPECTION: 6/19/00 Limited room in front yard. Will have to cross paved driveway. Old drywell to be pumped and abandoned. Baffles in existing INSPECTION COMMENTS: Tanks were recently repaired. (BB)

First two trenches OK to cover, 3rd trench OK to gravel fill OK to proceed. RPP 7/11/00  
 Last trench open OK to gravel fill - OK to cover when finished RPP 7/11/00  
 Call when abandoning & filling drywell. RPP 7/11/00 OK to collapse & fill old drywell for cover or call when complete RPP 7/11/00

INSPECTOR RPP DATE SYSTEM APPROVED 7/11/00

8/24/69  
Ready

# PERMIT

SEWAGE DISPOSAL SYSTEM

MARYLAND STATE DEPARTMENT OF HEALTH

HOWARD COUNTY

INDEXED

ELLICOTT CITY

DISTRICT

DATE 9/21/65

Charles Doyle IS PERMITTED TO INSTALL X ALTER

ADDRESS Box 274 - Randalltown, Md. PHONE 932-6329

A SEWAGE DISPOSAL SYSTEM LOCATED AT \_\_\_\_\_

SUBDIVISION Indian Hill ROAD 12375 Indian Hill Drive LOT 3

PROPERTY OWNER Country Home, Inc. Richard J. Thomas

ADDRESS \_\_\_\_\_

SPECIFICATIONS 3 or 4 bedrooms

DRAIN FIELD \_\_\_\_\_ DEPTH \_\_\_\_\_ FEET. BOTTOM AREA \_\_\_\_\_ SQ. FT.

SEEPAGE PITS \_\_\_\_\_ ABSORBENT SIDE-WALL AREA \_\_\_\_\_ SQ. FT.

SEPTIC TANK CAPACITY 750 GALLONS for 3 bedrooms

1,000 " for 4 bedrooms

FOR GARBAGE GRINDER, INCREASE DISPOSAL AREA 25% & TANK CAPACITY 50%.

OTHER dry well - 100 sq. ft. side-wall area below inlet pipe per bedroom

Inlet pipe no deeper than 1 ft. below grade.

Place dry well 30 ft. from front lot line and 40 ft. from left sidewalk as seen when facing from Indian Way.

MAXIMUM DEPTH PERMITTED 12' below original grade.

PERMIT VOID AFTER THREE YEARS.

PLANS APPROVED BY D. M. Moagher DATE 9/21/65

FILL SEPTIC TANK AND DISTRIBUTION BOX WITH WATER BEFORE CALLING FOR AN INSPECTION. COVER NO WORK UNTIL INSPECTED AND APPROVED.

NEITHER THE HOWARD COUNTY COMMISSIONERS NOR THE HEALTH DEPARTMENT IS RESPONSIBLE FOR THE SUCCESSFUL OPERATION OF ANY SYSTEM.

THIS PERMIT SKINNED  
AND RETURNED 10/1/69  
David #93123 M. B. B.

## NOTIFY THE HEALTH DEPARTMENT 48 HOURS BEFORE EXCAVATIONS ARE TO BE BACK FILLED.

*Handwritten signature/initials*

H 105 00

A 105 88  
7-28-65

total d. w. 2 mi at 4 1/2 ft. ; total 1 mi at 4 1/2 ft.

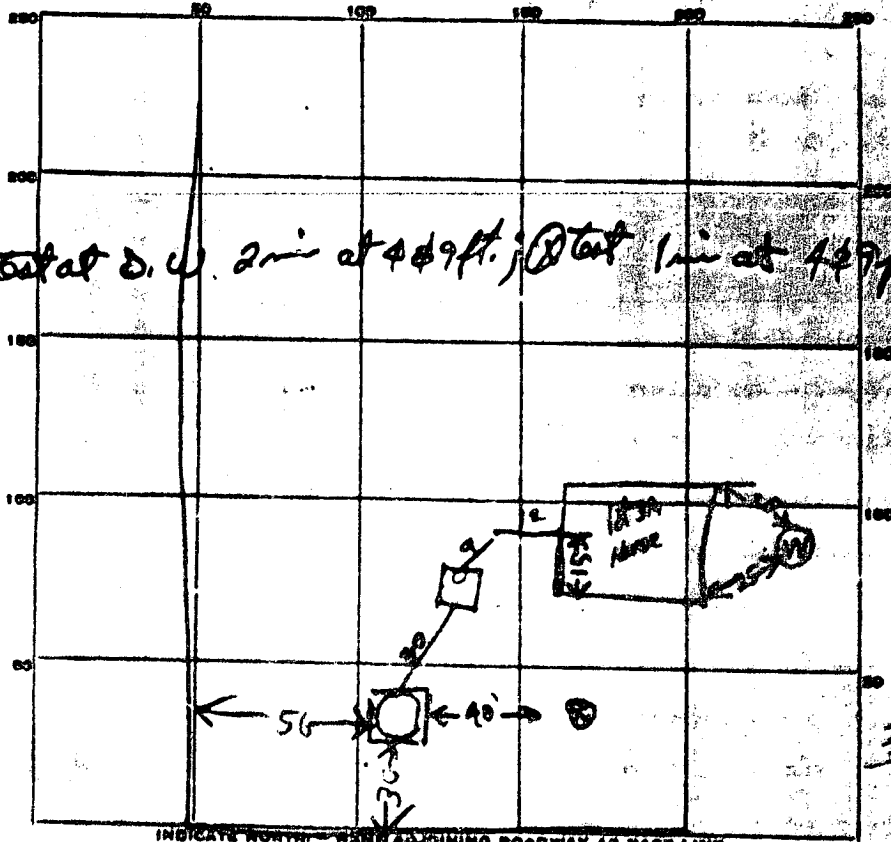

43  
95  
205  
307

INDICATE NORTH - WIND ADJOINING ROADWAY AS BASE LINE.

PERMIT CARD YES *in den way*

SEPTIC TANK, LEVEL OK concrete 100' CLEANOUTS OK  
*top 12 ft below grade*

DISTRIBUTION BOX, LEVEL \_\_\_\_\_

TILE FIELD, DEPTH \_\_\_\_\_ FT. TRENCH WIDTH \_\_\_\_\_ FT.

GRAVEL DEPTH \_\_\_\_\_ IN. TOTAL LENGTH \_\_\_\_\_ FT.

NUMBER OF TRENCHES \_\_\_\_\_ TOTAL BOTTOM AREA \_\_\_\_\_

SEEPAGE PITS, INSIDE DIAMETER 12 FT. DEPTH BELOW INLET 9 1/2 FT.

ABSORBENT AREA 250 SQ. FT. *counting stone* not counting stone

REMARKS I 67 Dry Well I. inlet is 2 1/2 ft below grade  
About 1 ft stone around dry well  
Therefore About 407 sqft sidewall  
are counting stone  
400 sqft sidewall rep. are