

10/14/98  
ASAP  
10/14/98  
1pm

# PERMIT

SEWAGE DISPOSAL SYSTEM

DEPARTMENT OF HEALTH AND MENTAL HYGIENE

04-321995

P 511038

A REPAIR

DISTRICT: \_\_\_\_\_

DATE 10/14/98

HOWARD COUNTY HEALTH DEPARTMENT

BUREAU OF ENVIRONMENTAL HEALTH  
~~XXXXXX~~ 410-313-2640

DATE SYSTEM APPROVED 10/14/98

INSPECTOR KM

INDEXED

Jack Fyock Septic Services IS PERMITTED TO INSTALL \_\_\_\_\_ ALTER X

ADDRESS P. O. Box 89, Triadelphia Road, Glenelg, Maryland 21737 PHONE 410-988-9270

SUBDIVISION \_\_\_\_\_ LOT \_\_\_\_\_ ROAD 3435 Jennings Chapel Road

PROPERTY OWNER Anthony

ADDRESS 3435 Jennings Chapel Road  
Woodbine, Maryland 21797

SEPTIC TANK CAPACITY 1000 GALLONS

NUMBER OF BEDROOMS 3

125 SQUARE FEET PER BEDROOM

LINEAR FEET OF TRENCH REQUIRED 75

REPAIR - PURPOSE - SEPTIC SYSTEM HAS FAILED.

Call for inspection when ground is opened so sanitarian can recommend repair. 10/08/98

Drywell to remain, Bottom of trench 9' below grade, Inlet 4' below grade,  
5' of stone in trench

PLANS APPROVED BY Kim Maiste DATE 10/14/98

COVER NO WORK UNTIL INSPECTED AND APPROVED

NEITHER THE HOWARD COUNTY COUNCIL NOR THE HEALTH DEPARTMENT IS RESPONSIBLE FOR THE SUCCESSFUL OPERATION OF ANY SYSTEM

NOTE: CLEANOUT REQUIRED EVERY 70 FEET OF SEWER LINE AND/OR AT 90° SWEEPS IN LINES FROM HOUSE TO DRAIN FIELDS. 90° ELBOWS NOT ACCEPTABLE.

NOTE: ALL PARTS OF SEPTIC SYSTEMS (I.E. TANK, DISTRIBUTION BOX, TRENCHES) TO BE 100 FEET FROM WELL (UNLESS OTHERWISE SPECIFICALLY AUTHORIZED)

NOTE: IF DEEP TRENCH(ES) ARE USED CALL FOR INSPECTION BEFORE AND AFTER PLACING GRAVEL IN TRENCH(ES)

NOTE: NO DRY WELL SHALL EXCEED 15 FOOT IN DIAMETER NO ABSORPTION TRENCH TO EXCEED 100 FEET IN LENGTH

NOTE: ALL PIPE FROM HOUSE TO SEPTIC TANK MUST BE CAST IRON OR SCHEDULE 35/40 PVC OR ABS

PERMIT VOID AFTER TWO YEARS

NOTE: INSTALL STAND PIPE ON SEPTIC TANK AND DRY WELL STAND PIPES MUST BE 6 INCHES IN DIAMETER CAST IRON, CONCRETE OR TERRA COTTA OR PVA OR ABS ACCEPTED. IF TOP OF SEPTIC TANK IS DEEPER THAN 3 FEET, MANHOLE TO GRADE REQUIRED.

NOTE: DISTRIBUTION BOXES MUST HAVE BAFFLES

\*INSTALLER IS RESPONSIBLE FOR OBTAINING FINAL APPROVAL ON THIS PERMIT

\*CALL 461-9933 FOR INSPECTION OF SEPTIC SYSTEM.

511038

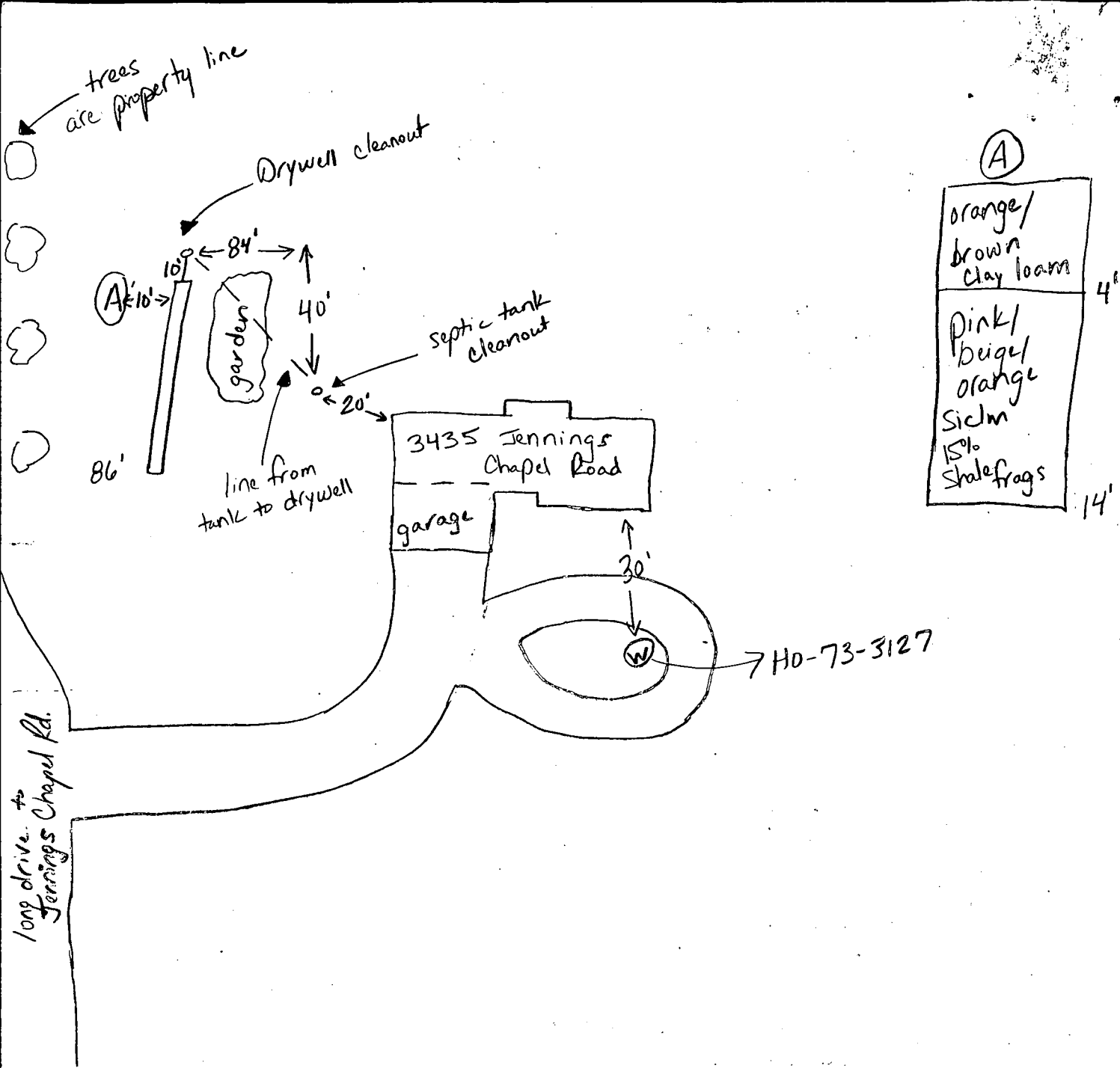

10/14/98 am

perc test hole looks good (see soil profile) ok to continue trench using design specs on permit front.

10/14/98 pm

ok to cover all work (KM)

Anthony

# PERMIT

30797

SEWAGE DISPOSAL SYSTEM

A 17201

MARYLAND STATE DEPARTMENT OF HEALTH

HOWARD COUNTY

ELLICOTT CITY  
DISTRICT 4th.

INDEXED

DATE 7/21/80

*Pat Vasso* was *Sant Plumbing & Heating, Inc.*

IS PERMITTED TO INSTALL X ALTER

ADDRESS Route 7, Box 48, Mt. Airy, Maryland 21771 PHONE 831-7232

SUBDIVISION \_\_\_\_\_ ROAD 3435 Jennings Chapel Rd LOT 27

PROPERTY OWNER Pat Vasso ANTHONEY

ADDRESS \_\_\_\_\_

SPECIFICATIONS 3 Bedrooms

SEPTIC TANK CAPACITY 1000 GALLONS

DRAIN FIELD \_\_\_\_\_ DEPTH \_\_\_\_\_ FEET. BOTTOM AREA \_\_\_\_\_ SQ. FT.

DEEP TRENCH \_\_\_\_\_ DEPTH \_\_\_\_\_ FEET. BOTTOM AREA \_\_\_\_\_ SQ. FT.

SEEPAGE PITS X ABSORBENT SIDE WALL AREA 150 SQ. FT. below inlet per bedroom

INLET PIPE 3 FT. BELOW ORIGINAL GRADE. MAXIMUM DEPTH 11 FT. BELOW ORIGINAL GRADE

EFFECTIVE DEPTH AT \_\_\_\_\_ FT. BELOW ORIGINAL GRADE.

LOCATE DISPOSAL AREA \_\_\_\_\_ FT. FROM \_\_\_\_\_ LOT LINE AND \_\_\_\_\_ FT. FROM \_\_\_\_\_ LOT LINE AS SEEN WHEN FACING LOT FROM

BLDG. PERMIT SIGNED AND RETURNED 7/25/80 Serial # 43853

Dry Well

Location of dry wells to be 124 feet up from left side and rear property line marker and 100 feet over from left property line. (See sketch if necessary) when facing lot from Jennings Chapel Road. Suggest leaving house with sewer a little deeper. NOTE: OKAY TO USE TRENCH OFF DRY WELL TO MAKE UP ABSORBENT SIDEWALL AREA IN SYSTEM. LEAVE 3 FT. BARELY BUFFER BETWEEN TRENCH AND DRY WELL. TRENCH TO FOLLOW CONTOUR OF THE LAND.

PLANS APPROVED BY C. B. Streaker DATE 7/30/73

COVER NO WORK UNTIL INSPECTED AND APPROVED.

NEITHER THE HOWARD COUNTY COUNCIL NOR THE HEALTH DEPARTMENT IS RESPONSIBLE FOR THE SUCCESSFUL OPERATION OF ANY SYSTEM.

NOTE IF TRENCH IS USED CALL FOR INSPECTION BEFORE PLACING GRAVEL IN TRENCH.

NOTE NO DRY WELL SHALL EXCEED 15 FOOT IN DIAMETER.

NOTE ALL PIPE FROM HOUSE TO DISPOSAL AREA MUST BE CAST IRON.

PERMIT VOID AFTER THREE YEARS.

NOTE INSTALL STAND PIPE ON SEPTIC TANK AND DRY WELL. STAND PIPES MUST BE 6 INCHES IN DIAMETER. CAST IRON, CONCRETE OR TERRA COTTA ACCEPTED.

\*INSTALLER IS RESPONSIBLE FOR OBTAINING FINAL APPROVAL ON THIS PERMIT.

17905

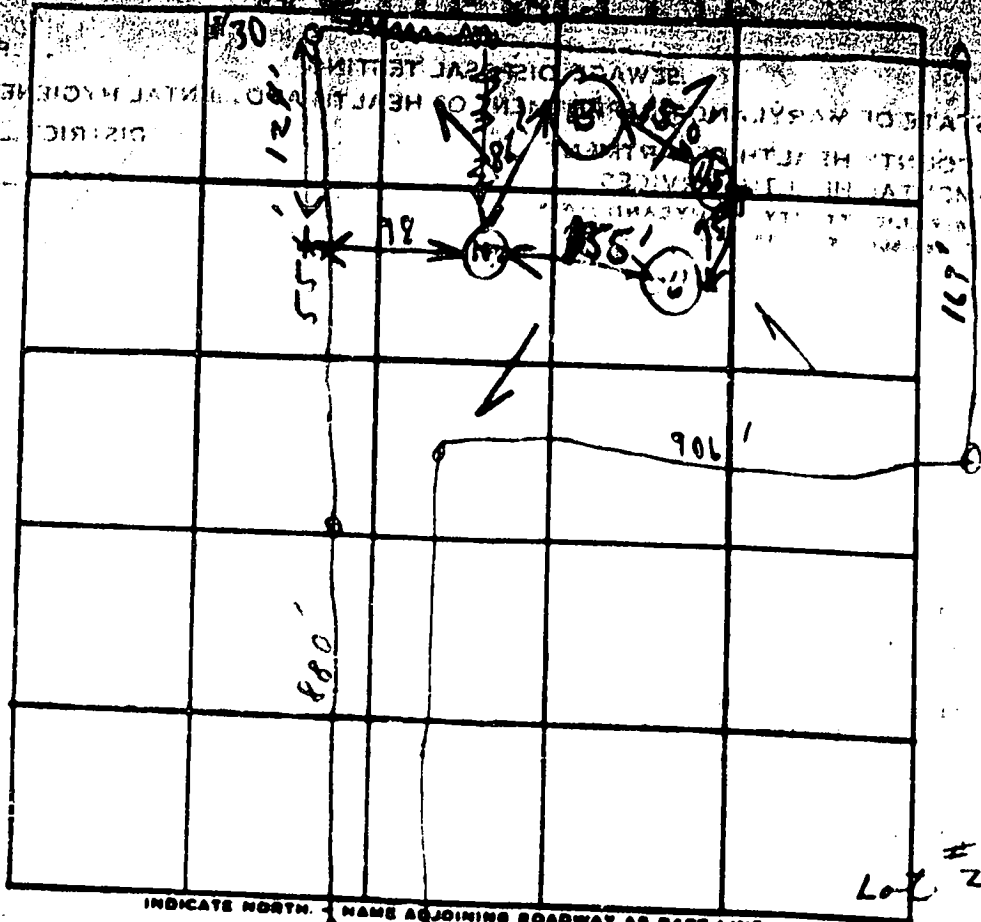

Lot # 27

INDICATE NORTH. NAME ADJOINING ROADWAY AS BASE LINE

Jeannette Chapel Rd

DATE	TEST NO.	DEPTH	PRE-WET		TEST - 1" DROP		TIME	
			START	STOP	START	STOP		
7/9/22	1	11'	10:12	10:16	10:16	10:27	11m	
	2	3'	10:11	10:15	10:15	10:21	6m	
	3	11'	Similar to 1+2					
	4	4'	10:30	10:32	10:32	10:49	12m	
	5	11'	10:30	10:32	10:32	10:34	2m	
	6	11'	Similar to 1+2					31

Set at 3'  
8min

REMARKS

(GCL)

TYPE OF SOIL

(Whaley)

TESTED BY

B. Stecker

ALSO PRESENT:

(New 1+2) Hager, D  
Curtis, B

(Tony & Eli, Frank)

# PERMIT

SEWAGE DISPOSAL SYSTEM  
MARYLAND STATE DEPARTMENT OF HEALTH

ELLICOTT CITY  
DISTRICT  
DATE

HOWARD COUNTY

13 1/2'  
D.W.  
14'  
13 1/2'

28'

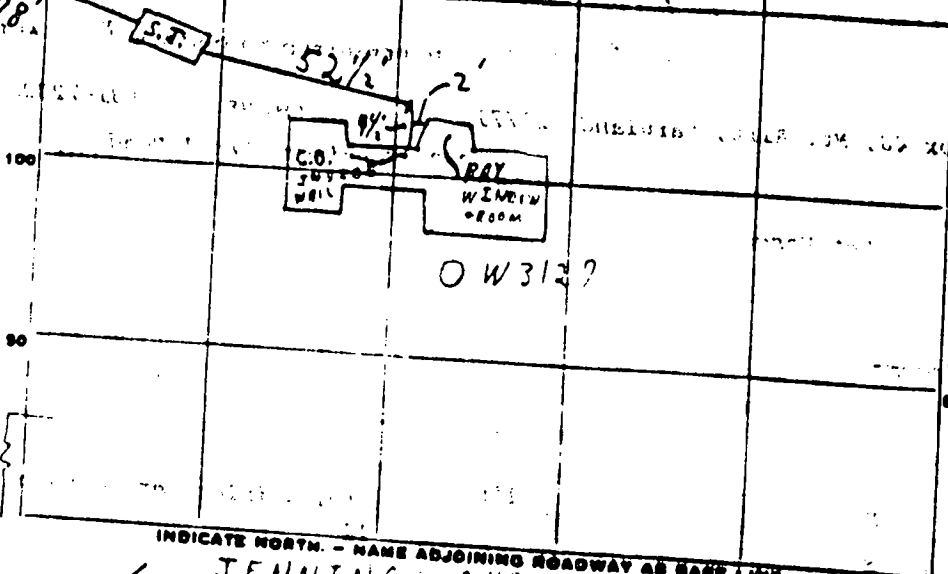

INDICATE NORTH - NAME ADJOINING ROADWAY AS BASE LINE.  
JENNINGS CHAPEL ROAD

PERMIT CARD

SEPTIC TANK, LEVEL  S.T. | D.W.

DISTRIBUTION BOX, LEVEL  CLEANOUTS

TILE FIELD, DEPTH \_\_\_\_\_ FT. TRENCH WIDTH \_\_\_\_\_ FT.

GRAVEL DEPTH \_\_\_\_\_ IN. TOTAL LENGTH \_\_\_\_\_ FT.

NUMBER OF TRENCHES \_\_\_\_\_ TOTAL BOTTOM AREA \_\_\_\_\_

SEEPAGE PITS, INSIDE DIAMETER 54 1/2 FT. DEPTH BELOW INLET 8.5 FT.

ABSORBENT AREA 463 SQ. FT.

REMARKS 12/9/20 SYSTEM COMPLETE.  
C.B.S.

DATE SYSTEM APPROVED 12/9/20

