

9/21/98
10:00
after 12pm

PERMIT

SEWAGE DISPOSAL SYSTEM

DEPARTMENT OF HEALTH AND MENTAL HYGIENE

03-279669

HOWARD COUNTY HEALTH DEPARTMENT

BUREAU OF ENVIRONMENTAL HEALTH

~~XXXXXX~~ 410-313-2640

P 510682-A

A REPAIR

DISTRICT _____

DATE 9/14/98

DATE SYSTEM APPROVED 9/21/98

INSPECTOR KM

INDEXED

Jack Fyock Septic Services IS PERMITTED TO INSTALL _____ ALTER

ADDRESS P. O. Box 89, Triadelphia Road, Glenelg, Maryland 21737 PHONE 410-988-9270

SUBDIVISION Benson LOT 8B ROAD 3530 Lakeway Drive

PROPERTY OWNER Barbara Coety

ADDRESS 3530 Lakeway Drive
Ellicott City, Maryland 21042

SEPTIC TANK CAPACITY 1000 GALLONS

NUMBER OF BEDROOMS 3

125 SQUARE FEET PER BEDROOM

LINEAR FEET OF TRENCH REQUIRED 54 ±'

REPAIR - PURPOSE - DRYWELL HAS FAILED.

Call for inspection when ground is opened so sanitarian can recommend repair.
09/16/98

Inlet at 4', Bottom at 10', 6' of stone, trench 2' wide

Drywell to remain, (pumped previously)

PLANS APPROVED BY Kimberly Maiste DATE 9.21.98

COVER NO WORK UNTIL INSPECTED AND APPROVED

NEITHER THE HOWARD COUNTY COUNCIL NOR THE HEALTH DEPARTMENT IS RESPONSIBLE FOR THE SUCCESSFUL OPERATION OF ANY SYSTEM

NOTE: CLEANOUT REQUIRED EVERY 70 FEET OF SEWER LINE AND/OR AT 90° SWEEPS IN LINES FROM HOUSE TO DRAIN FIELDS. 90° ELBOWS NOT ACCEPTABLE.

NOTE: ALL PARTS OF SEPTIC SYSTEMS (I.E. TANK, DISTRIBUTION BOX TRENCHES) TO BE 100 FEET FROM WELL (UNLESS OTHERWISE SPECIFICALLY AUTHORIZED)

NOTE: IF DEEP TRENCH(ES) ARE USED CALL FOR INSPECTION BEFORE AND AFTER PLACING GRAVEL IN TRENCH(ES)

NOTE: NO DRY WELL SHALL EXCEED 15 FOOT IN DIAMETER NO ABSORPTION TRENCH TO EXCEED 100 FEET IN LENGTH

NOTE: ALL PIPE FROM HOUSE TO SEPTIC TANK MUST BE CAST IRON OR SCHEDULE 35/40 PVC OR ABS

PERMIT VOID AFTER TWO YEARS

NOTE: INSTALL STAND PIPE ON SEPTIC TANK AND DRY WELL STAND PIPES MUST BE 6 INCHES IN DIAMETER CAST IRON, CONCRETE OR TERRA COTTA OR PVA OR ABS ACCEPTED. IF TOP OF SEPTIC TANK IS DEEPER THAN 3 FEET, MANHOLE TO GRADE REQUIRED.

NOTE: DISTRIBUTION BOXES MUST HAVE BAFFLES

*INSTALLER IS RESPONSIBLE FOR OBTAINING FINAL APPROVAL ON THIS PERMIT

510682

A
orange
cl lm
4'
brown/
beige
setm
mica loam
manganese
10% shale
14'.5'

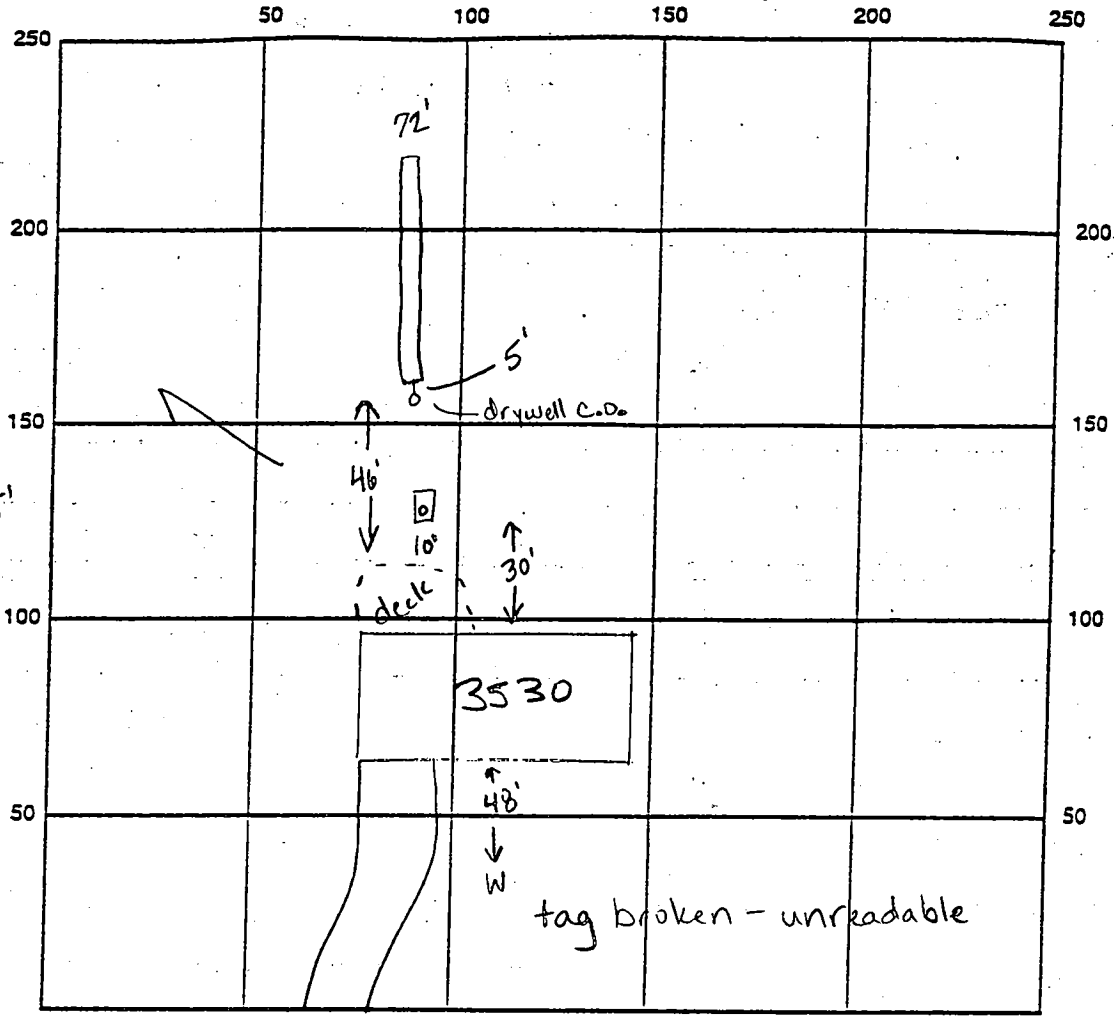

INDICATE NORTH - NAME ADJOINING ROADWAY AS BASE LINE Lakeway Drive

SEPTIC TANK LEVEL existing CLEANOUTS 1 on tank, 1 on drywell
 DISTRIBUTION BOX LEVEL N/A
 DRAIN FIELD/TITLE DEPTH 10.0 FT. TRENCH WIDTH 2.0 FT. INLET DEPTH 4.0 FT.
 EFFECTIVE GRAVEL DEPTH 6.0 FT. TOTAL LENGTH 72 FT.
 NUMBER OF TRENCHES 1 ONE SIDEWALL/BOTTOM AREA 432 SQ. FT.
 DRYWALL INSIDE DIAMETER — FT. EFFECTIVE DEPTH BELOW INLET — FT.
 ABSORBENT AREA — SQ. FT.

REMARKS: 9/21/98 ok to stone trench and continue, trench will be connected to existing drywell, pore hole visual only looks good (KM)
(pm) ok to cover all work (KM)

DATE SYSTEM APPROVED 9/21/98 INSPECTOR Kim Maisto

PERMIT

SEWAGE DISPOSAL SYSTEM

2-1484
A-1484

9/10/74

MARYLAND STATE DEPARTMENT OF HEALTH

HOWARD COUNTY

ELLICOTT CITY

DISTRICT 1

file approved
HJZ-OWN
9-10-74
INDEXED

DATE 8/20/74

Jack Fyock

IS PERMITTED TO INSTALL ALTER

ADDRESS Ten Oaks Road, Dayton, Md.

PHONE 286-2920

A SEWAGE DISPOSAL SYSTEM LOCATED AT

SUBDIVISION Ransom

ROAD Lakeview Drive

LOT 8 B

PROPERTY OWNER Michael C. Backert

ADDRESS

SPECIFICATIONS - 3 bedrooms

DRAIN FIELD _____ DEPTH _____ FEET, BOTTOM AREA _____ SQ. FT.

SEEPAGE PITS _____ ABSORBENT SIDE-WALL AREA _____ SQ. FT.

SEPTIC TANK CAPACITY 1,000 GALLONS

FOR GARBAGE GRINDER, INCREASE DISPOSAL AREA 25% & TANK CAPACITY 50%.

OTHER Dry well to be 100 sq. ft. of absorbent sidewall area per bedroom below the inlet.

Inlet to begin 4 ft. below original grade. Maximum depth of dry well 12 ft. below original grade. Locate dry well 50 ft. from right side line and 125 ft. from rear lot line as lot is seen when standing on new road facing lot.

NOTE: ALL PIPE FROM HOUSE TO DRY WELL MUST BE CAST IRON.

PERMIT VOID AFTER THREE YEARS.

NOTE: INSTALL STAND PIPE ON SEPTIC TANK AND DRY WELL.

PLANS APPROVED BY James T. Wright

DATE 9/22/70

FILL SEPTIC TANK AND DISTRIBUTION BOX WITH WATER BEFORE CALLING FOR AN INSPECTION. COVER NO WORK UNTIL INSPECTED AND APPROVED.

NEITHER THE HOWARD COUNTY COMMISSIONERS NOR THE HEALTH DEPARTMENT IS RESPONSIBLE FOR THE SUCCESSFUL OPERATION OF ANY SYSTEM.

A
1444
7777

$\frac{11}{11}$
 $\frac{3470}{P}$
 3625.0

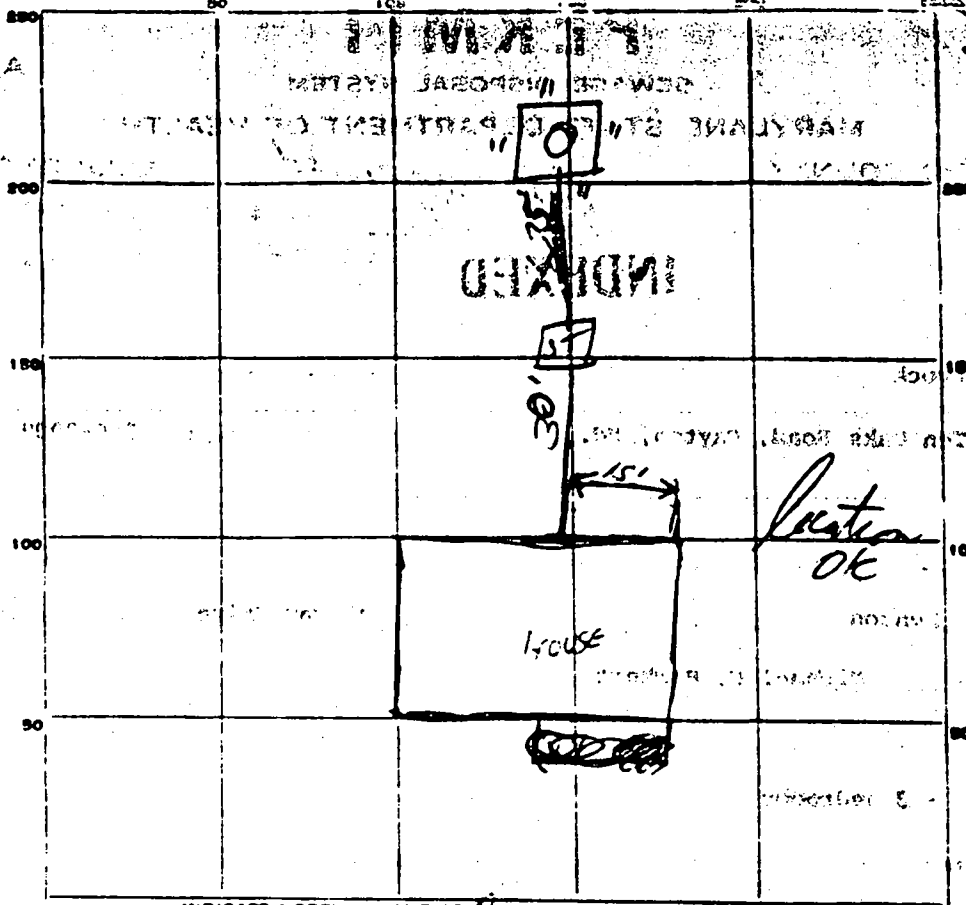

INDICATE NORTH - NAME ADJOINING ROADWAY AS BASE LINE.

Sakewy

PERMIT CARD 9-10-74
 SEPTIC TANK, LEVEL OK CLEANOUTS OK
 DISTRIBUTION BOX, LEVEL N/A
 TILE FIELD, DEPTH N/A FT. TRENCH WIDTH N/A FT.
 GRAVEL DEPTH N/A IN. TOTAL LENGTH N/A FT.
 NUMBER OF TRENCHES _____ TOTAL BOTTOM AREA N/A
 SEEPAGE PITS, ^{OUTSIDE DIAMETER} 44 FT. DEPTH BELOW INLET 8 FT.
 ABSORBENT AREA 362 SQ. FT.

REMARKS _____

DATE SYSTEM APPROVED 9-10-74 INSPECTOR HJ ZBAR

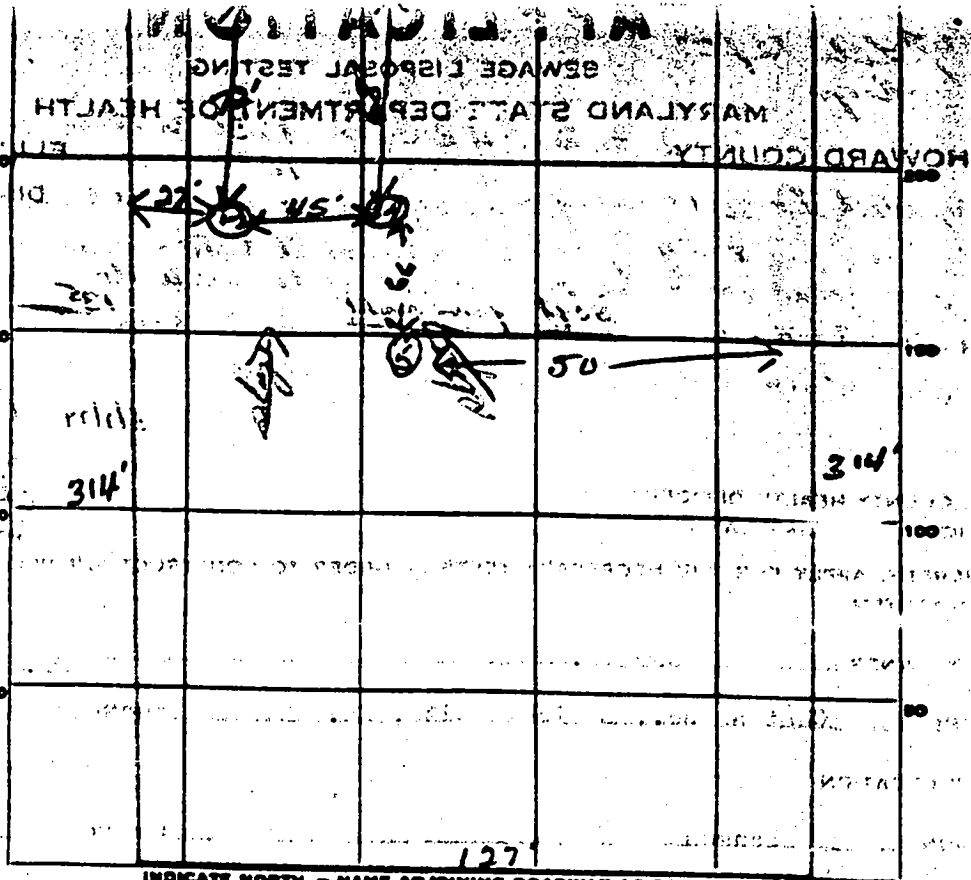

DATE	TEST NO.	DEPTH	PRE-WET		TEST - 1" DROP		TIME
			START	STOP	START	STOP	
4/23/69	1	7 1/2	144	153	153	210	17 min
	2	4'	145	148	148	152	4 min
	3	7 1/2	148	154	154	202	8 min
	4	4	147	148	148	154	6 min
5/13/74	12 1/2 ft	chile dry ground soil					

SOIL AUGER FINDING

TESTED BY

made up of new holes 10-12 ft

REMARKS

*Made open holes 30 from original holes
1-2 hole 104' to 110' at 110' level
3-4 hole 108' to 114' at 114' level*

*Org.
9 min.*

B-8

314'

314'

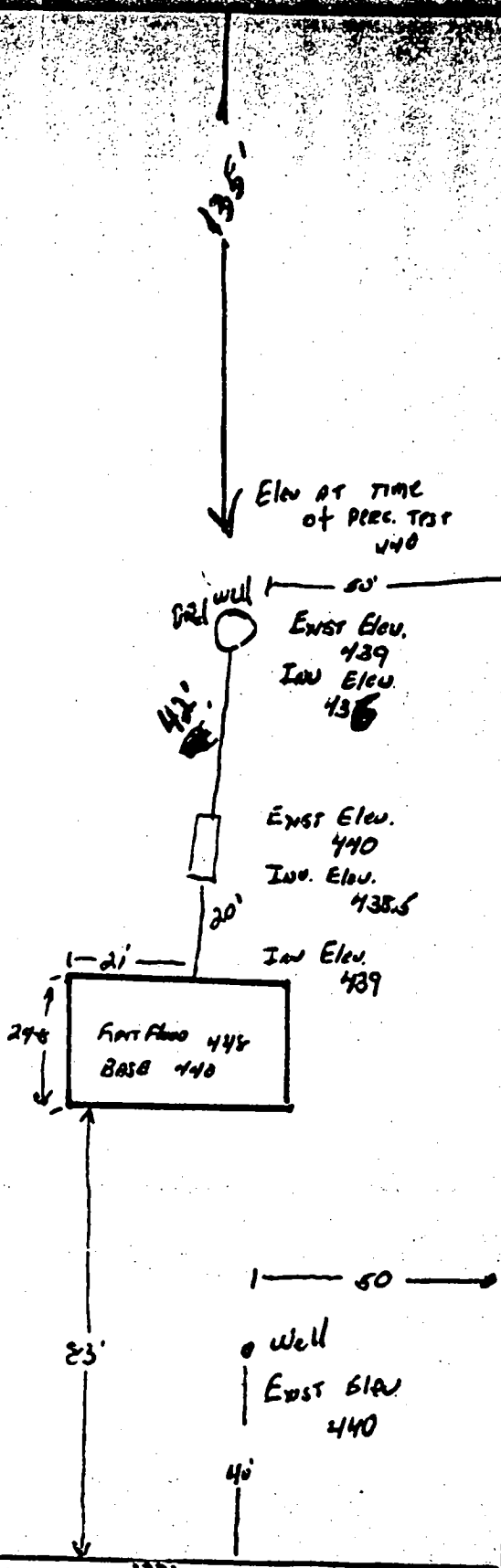

135'