

5/15/97
Approved
Water

PERMIT

SEWAGE DISPOSAL SYSTEM

DEPARTMENT OF HEALTH AND MENTAL HYGIENE

P 58467

A REPAIR

DISTRICT _____

DATE 5/16/97

03-297462

HOWARD COUNTY HEALTH DEPARTMENT

BUREAU OF ENVIRONMENTAL HEALTH

~~XXXXXXXX~~

313-2640

INDEXED -

DATE SYSTEM APPROVED 5/15/97

INSPECTOR DCS

Jenkins Brothers _____ IS PERMITTED TO INSTALL _____ ALTER X

ADDRESS 7670 Smith's Private Road, Sykesville, Maryland 21784 PHONE 461-9282

SUBDIVISION TAX MAP 16 PARCEL 236 LOT _____ ROAD 2940 Marriottsville Road

PROPERTY OWNER _____ Cathy Buck

ADDRESS _____ 2940 Marriottsville Road
Marriottsville, Maryland 21104

SEPTIC TANK CAPACITY EXISTING GALLONS

NUMBER OF BEDROOMS 3

180 SQUARE FEET PER BEDROOM

LINEAR FEET OF TRENCH REQUIRED 67' ±

MAPPED AS GLC SOILS

ADDRESS CHANGE?

REPAIR - PURPOSE - SEPTIC SYSTEM HAS FAILED.

Call for inspection when ground is opened so sanitarian can recommend repair.
05/13/97

install trench off existing septic tank, along contour.
trench to be 2' wide, inlet 3', bottom 11", stone 8'.

PLANS APPROVED BY DONALD K. SCOE DATE 5/15/97

COVER NO WORK UNTIL INSPECTED AND APPROVED

NEITHER THE HOWARD COUNTY COUNCIL NOR THE HEALTH DEPARTMENT IS RESPONSIBLE FOR THE SUCCESSFUL OPERATION OF ANY SYSTEM

NOTE: CLEANOUT REQUIRED EVERY 70 FEET OF SEWER LINE AND/OR AT 90° SWEEPS IN LINES FROM HOUSE TO DRAIN FIELDS, 90° ELBOWS NOT ACCEPTABLE.

NOTE: ALL PARTS OF SEPTIC SYSTEMS (I.E. TANK, DISTRIBUTION BOX TRENCHES) TO BE 100 FEET FROM WELL (UNLESS OTHERWISE SPECIFICALLY AUTHORIZED)

NOTE: IF DEEP TRENCH(ES) ARE USED CALL FOR INSPECTION BEFORE AND AFTER PLACING GRAVEL IN TRENCH(ES)

NOTE: NO DRY WELL SHALL EXCEED 15 FOOT IN DIAMETER NO ABSORPTION TRENCH TO EXCEED 100 FEET IN LENGTH

NOTE: ALL PIPE FROM HOUSE TO SEPTIC TANK MUST BE CAST IRON OR SCHEDULE 35/40 PVC OR ABS

PERMIT VOID AFTER TWO YEARS

NOTE: INSTALL STAND PIPE ON SEPTIC TANK AND DRY WELL STAND PIPES MUST BE 6 INCHES IN DIAMETER CAST IRON. CONCRETE OR TERRA COTTA OR PVA OR ABS ACCEPTED. IF TOP OF SEPTIC TANK IS DEEPER THAN 3 FEET. MANHOLE TO GRADE REQUIRED.

NOTE: DISTRIBUTION BOXES MUST HAVE BAFFLES

***INSTALLER IS RESPONSIBLE FOR OBTAINING FINAL APPROVAL ON THIS PERMIT**

P 58467

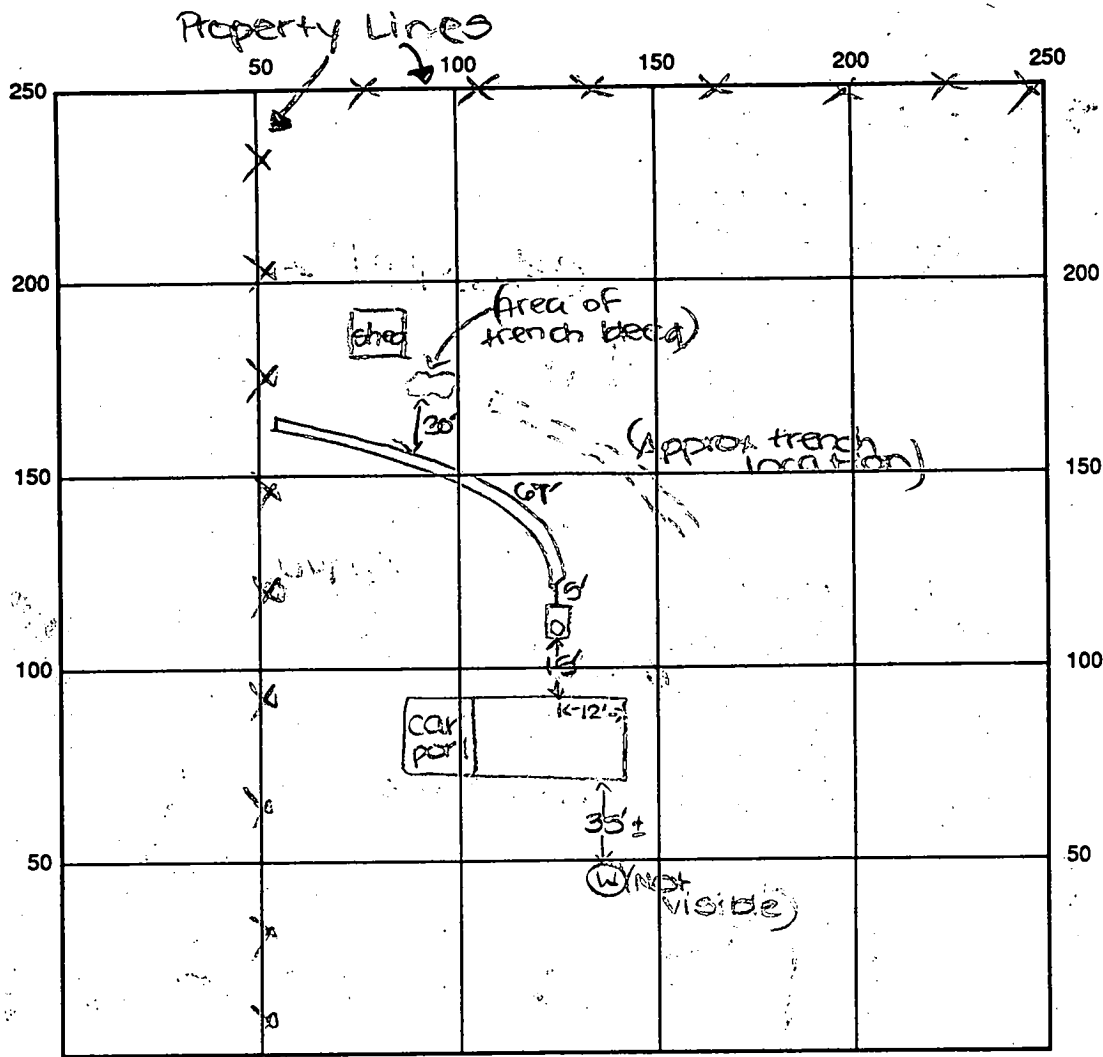

INDICATE NORTH - NAME ADJOINING ROADWAY AS BASE LINE

Marriottsville Road

SEPTIC TANK LEVEL EXISTING CLEANOUTS machine on sit.

DISTRIBUTION BOX LEVEL N/A

DRAIN FIELD/TITLE DEPTH 11 FT. TRENCH WIDTH 2 FT. INLET DEPTH 3 FT.

EFFECTIVE GRAVEL DEPTH 8 FT. TOTAL LENGTH 67 FT.

NUMBER OF TRENCHES 1 ONE SIDEWALL/BOTTOM AREA 536 SQ. FT.

DRYWALL INSIDE DIAMETER FT. EFFECTIVE DEPTH BELOW INLET FT.

ABSORBENT AREA SQ. FT.

REMARKS: 5/15/97 OK to begin trench as specified. DKS
5/15/97 FINAL INSD - OK to cover all work. DKS

DATE SYSTEM APPROVED 5/15/97 INSPECTOR [Signature]

70/8/63

PERMIT

12/31/63 P 07535
A 06630

SEWAGE DISPOSAL SYSTEM

MARYLAND STATE DEPARTMENT OF HEALTH

HOWARD COUNTY
INDEXED

INDEXED

ELLICOTT CITY

DISTRICT 2

DATE 10-4-63

Ernest Kays IS PERMITTED TO INSTALL ALTER

ADDRESS _____ PHONE _____

A SEWAGE DISPOSAL SYSTEM LOCATED AT Spencer Rd. 1/2 mile between
Rout 144 and 40 on left going north

SUBDIVISION _____ ROAD _____ LOT _____

PROPERTY OWNER Earl Thompson

ADDRESS _____

SPECIFICATIONS

DRAIN FIELD DEPTH _____ FEET. BOTTOM AREA 300 SQ. FT.

SEEPAGE PITS _____ ABSORBENT SIDE-WALL AREA _____ SQ. FT.

SEPTIC TANK CAPACITY 750 GALLONS

FOR GARBAGE GRINDER, INCREASE DISPOSAL AREA 25% & TANK CAPACITY 50%.

OTHER Place system 125 to 125 ft. from the wire

place on left of lot and 15 to 90 ft. from wire fence

on the left of lot as seen when facing lot from Harriottville Rd.

PLANS APPROVED BY Raymond Bridges DATE 4-23-63

FILL SEPTIC TANK AND DISTRIBUTION BOX WITH WATER BEFORE CALLING FOR AN INSPECTION. COVER NO WORK UNTIL INSPECTED AND APPROVED.

NEITHER THE HOWARD COUNTY COMMISSIONERS NOR THE HEALTH DEPARTMENT IS RESPONSIBLE FOR THE SUCCESSFUL OPERATION OF ANY SYSTEM.

A
06630

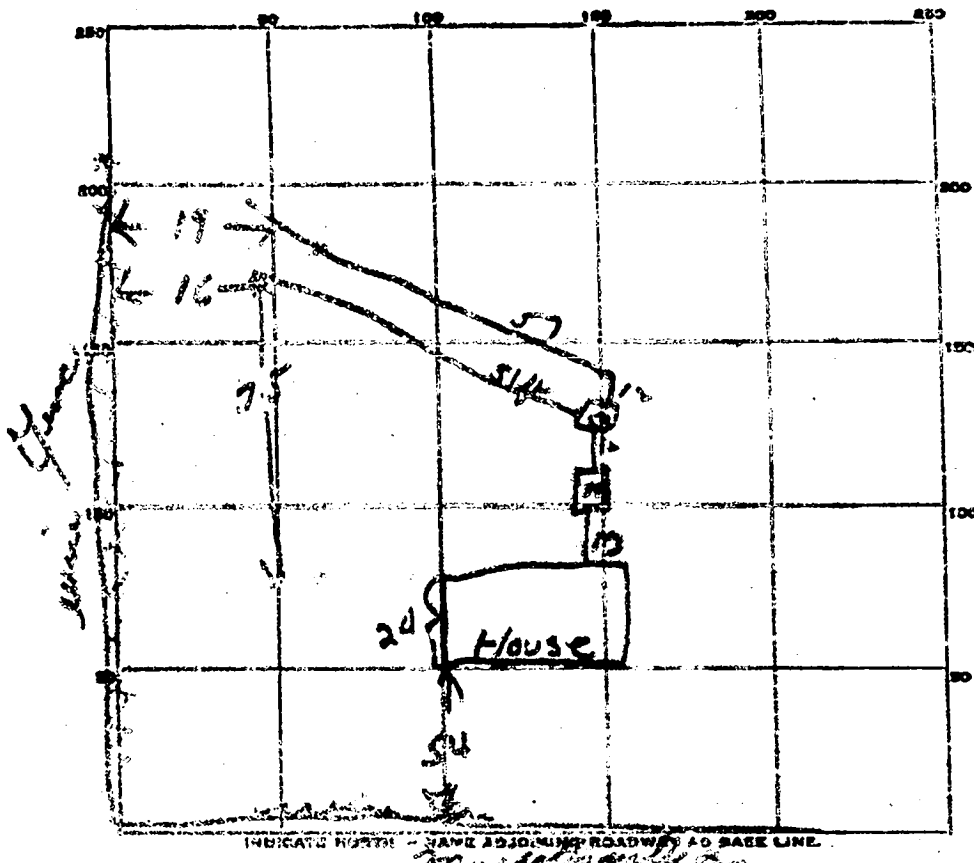

54
24
78
153

57
53
110

PERMIT CARD OK

SEPTIC TANK, LEVEL OK CLEANOUTS OK

DISTRIBUTION BOX, LEVEL OK

WILD FIELD, DEPTH 36 FT. TRENCH WIDTH 3 FT.

GRAVEL DEPTH 18 IN. TOTAL LENGTH 108 FT.

NUMBER OF TRENCHES 2 TOTAL BOTTOM AREA 324 sq. ft.

SEEPAGE PITS, INSIDE DIAMETER _____ FT. DEPTH BELOW INLET _____ FT.

ABSORBENT AREA _____ SQ. FT.

REMARKS _____

DATE SYSTEM APPROVED 10/15 INSPECTOR W. M. Mangan

APPLICATION

SEWAGE DISPOSAL TESTING

A

P

MARYLAND STATE DEPARTMENT OF HEALTH

HOWARD COUNTY

ELLICOTT CITY

DISTRICT 2
DATE 4-19-63

*Tract lot 3248
Marriottville
1/2 of the tract located on the west side of Rt. 144
and 1/2 of the tract located on the east side of Rt. 144
between Rt. 144 and Rt. 90 on left going south*

TO: THE COUNTY HEALTH OFFICER
ELLICOTT CITY, MARYLAND

I, HEREBY, APPLY FOR THE NECESSARY TESTS IN ORDER TO CONSTRUCT OR RECONSTRUCT A SEWAGE DISPOSAL SYSTEM.

PROPERTY OWNER Earl and Evelyn Thompson

ADDRESS Marriottville PHONE

PROPERTY LOCATION:

SUBDIVISION LOT NO

ROAD AND DESCRIPTION Marriottville Rd (approx 1/2 way between Rt 144 and Rt 90 on left going south)

OCCUPANT PHONE

PERSON TO CONSTRUCT SYSTEM

ADDRESS PHONE

SIZE OF LOT 1 acre TYPE BLDG 3 NUMBER OF BEDROOMS 11

IF NOT SINGLE RESIDENCE DESCRIBE

SIGNATURE OF APPLICANT [Signature]

APPROVED BY [Signature] FOR DATE 4-19-63

REJECTED BY FOR DATE

HOLD PENDING FURTHER TESTS DATE

REASONS FOR REJECTION OR HOLDING

THIS IS NOT A PERMIT