

352622

PERMIT

SEWAGE DISPOSAL SYSTEM

DEPARTMENT OF HEALTH AND MENTAL HYGIENE

P 58454A

A REPAIR

DISTRICT 5th

DATE 5/14/97

HOWARD COUNTY HEALTH DEPARTMENT
BUREAU OF ENVIRONMENTAL HEALTH

~~XXXXXXXX~~ 313-2640

DATE SYSTEM APPROVED 5/14/97

INSPECTOR DKS

INDEXED

Jack Fyock Septic Service IS PERMITTED TO INSTALL ALTER

ADDRESS 13775 Triadelphia Road, Glenelg, Maryland 21737 PHONE 988-9270

SUBDIVISION Braeburn LOT 44 ROAD 6412 Lockridge Road

PROPERTY OWNER Hartin

ADDRESS 6412 Lockridge Road
Columbia, Maryland 21044

SEPTIC TANK CAPACITY 1000 GALLONS

NUMBER OF BEDROOMS 3

125 SQUARE FEET PER BEDROOM

LINEAR FEET OF TRENCH REQUIRED 70'±

REPAIR - PURPOSE - SEPTIC SYSTEM HAS FAILED.

Call for inspection when ground is opened so sanitarian can recommend repair.
05/12/97

Install trenches off existing system

Trench to be 5.5' wide, inlet 2', bottom 5', slope 3'

PLANS APPROVED BY [Signature] DATE 5/14/97

COVER NO WORK UNTIL INSPECTED AND APPROVED

NEITHER THE HOWARD COUNTY COUNCIL NOR THE HEALTH DEPARTMENT IS RESPONSIBLE FOR THE SUCCESSFUL OPERATION OF ANY SYSTEM

NOTE: CLEANOUT REQUIRED EVERY 70 FEET OF SEWER LINE AND/OR AT 90° SWEEPS IN LINES FROM HOUSE TO DRAIN FIELDS, 90° ELBOWS NOT ACCEPTABLE.

NOTE: ALL PARTS OF SEPTIC SYSTEMS (I.E. TANK, DISTRIBUTION BOX TRENCHES) TO BE 100 FEET FROM WELL (UNLESS OTHERWISE SPECIFICALLY AUTHORIZED)

NOTE: IF DEEP TRENCH(ES) ARE USED CALL FOR INSPECTION BEFORE AND AFTER PLACING GRAVEL IN TRENCH(ES)

NOTE: NO DRY WELL SHALL EXCEED 15 FOOT IN DIAMETER NO ABSORPTION TRENCH TO EXCEED 100 FEET IN LENGTH

NOTE: ALL PIPE FROM HOUSE TO SEPTIC TANK MUST BE CAST IRON OR SCHEDULE 35/40 PVC OR ABS

PERMIT VOID AFTER TWO YEARS

NOTE: INSTALL STAND PIPE ON SEPTIC TANK AND DRY WELL STAND PIPES MUST BE 6 INCHES IN DIAMETER CAST IRON, CONCRETE OR TERRA COTTA OR PVA OR ABS ACCEPTED. IF TOP OF SEPTIC TANK IS DEEPER THAN 3 FEET. MANHOLE TO GRADE REQUIRED.

NOTE: DISTRIBUTION BOXES MUST HAVE BAFFLES

***INSTALLER IS RESPONSIBLE FOR OBTAINING FINAL APPROVAL ON THIS PERMIT**

A 58454A

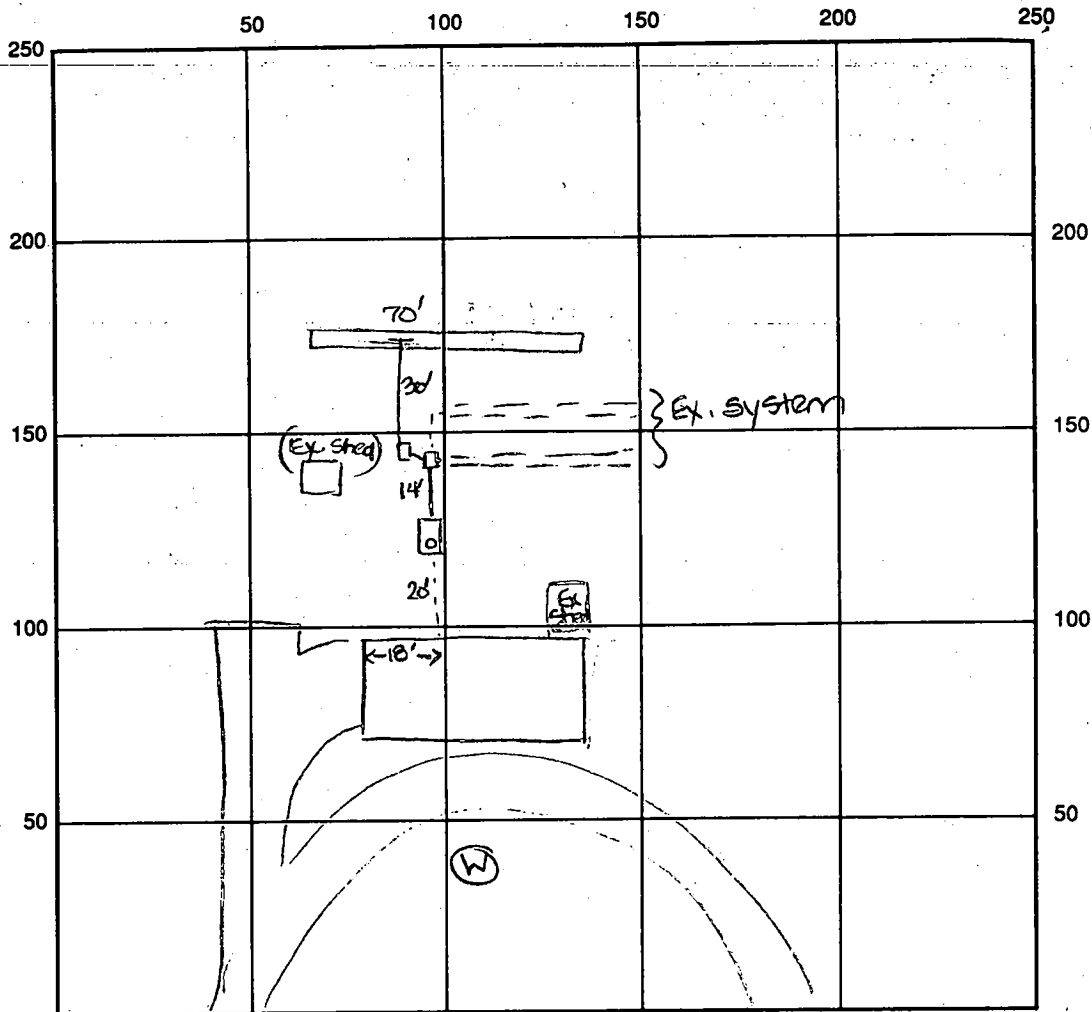

INDICATE NORTH - NAME ADJOINING ROADWAY AS BASE LINE

Lochridge Road

SEPTIC TANK LEVEL Existing CLEANOUTS existing - one on septic tank

DISTRIBUTION BOX LEVEL both OK

DRAIN FIELD/TITLE DEPTH 5 FT. TRENCH WIDTH 5.5 FT. INLET DEPTH 2 FT.

EFFECTIVE GRAVEL DEPTH 3 FT. TOTAL LENGTH 70 FT.

NUMBER OF TRENCHES 1 ONE SIDEWALL/BOTTOM AREA 385 SQ. FT.

DRYWALL INSIDE DIAMETER FT. EFFECTIVE DEPTH BELOW INLET FT.

ABSORBENT AREA 385 SQ. FT. + Existing

REMARKS: 5/14/97 FINAL INSP - OK TO COVER ALL WORK. JKS

DATE SYSTEM APPROVED 5/14/97 INSPECTOR [Signature]

1/23/67
Hedger

PERMIT

P 12405

A 12383

SEWAGE DISPOSAL SYSTEM

MARYLAND STATE DEPARTMENT OF HEALTH

HOWARD COUNTY

ELLICOTT CITY

DISTRICT 5

DATE 1/20/67

Elwood Seage IS PERMITTED TO INSTALL ALTER

ADDRESS Murphy Rd., Laurel, Md. PHONE 725-0329

A SEWAGE DISPOSAL SYSTEM LOCATED AT _____

SUBDIVISION Braeburn ROAD Lochridge LOT 44

PROPERTY OWNER A. H. Young, Jr., Inc.

ADDRESS _____

SPECIFICATIONS - 3 bedrooms

DRAIN FIELD _____ DEPTH _____ FEET. BOTTOM AREA _____ SQ. FT.

SEEPAGE PITS _____ ABSORBENT SIDE-WALL AREA _____ SQ. FT.

SEPTIC TANK CAPACITY 750 GALLONS

FOR GARBAGE GRINDER, INCREASE DISPOSAL AREA 25% & TANK CAPACITY 50%.

OTHER Tile field - 300 sq. ft. bottom area installed at a depth of 3 ft. to 4 ft. below grade. Place the tile field 45 ft. to 130 ft. from the left side of the lot as seen when facing the lot from Lochridge Road and 35 ft. to 55 ft. from the back of the house.

PERMIT VOID AFTER THREE YEARS.

PLANS APPROVED BY Raymond Hodges DATE 1/27/67

FILL SEPTIC TANK AND DISTRIBUTION BOX WITH WATER BEFORE CALLING FOR AN INSPECTION. COVER NO WORK UNTIL INSPECTED AND APPROVED.

NEITHER THE HOWARD COUNTY COMMISSIONERS NOR THE HEALTH DEPARTMENT IS RESPONSIBLE FOR THE SUCCESSFUL OPERATION OF ANY SYSTEM.

A 12383

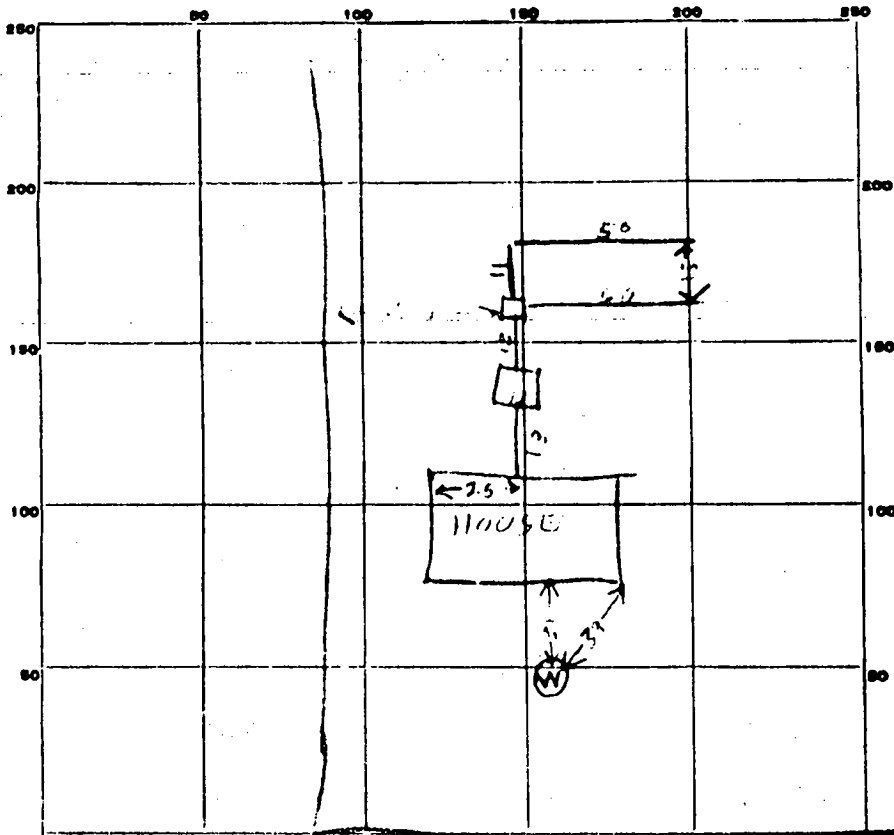

INDICATE NORTH - NAME ADJOINING ROADWAY AS BASE LINE.

PERMIT CARD

SEPTIC TANK, LEVEL 6' 13" concrete CLEANOUTS OK

DISTRIBUTION BOX, LEVEL top is 3' below grade

TILE FIELD, DEPTH 3-4 FT. TRENCH WIDTH 3 FT.

GRAVEL DEPTH 12 IN. TOTAL LENGTH 100 FT.

NUMBER OF TRENCHES 2 TOTAL BOTTOM AREA 300

SEEPAGE PITS, INSIDE DIAMETER _____ FT. DEPTH BELOW INLET _____ FT.

ABSORBENT AREA _____ SQ. FT.

REMARKS

DATE SYSTEM APPROVED 15 Jan 77 INSPECTOR Edward Hooley

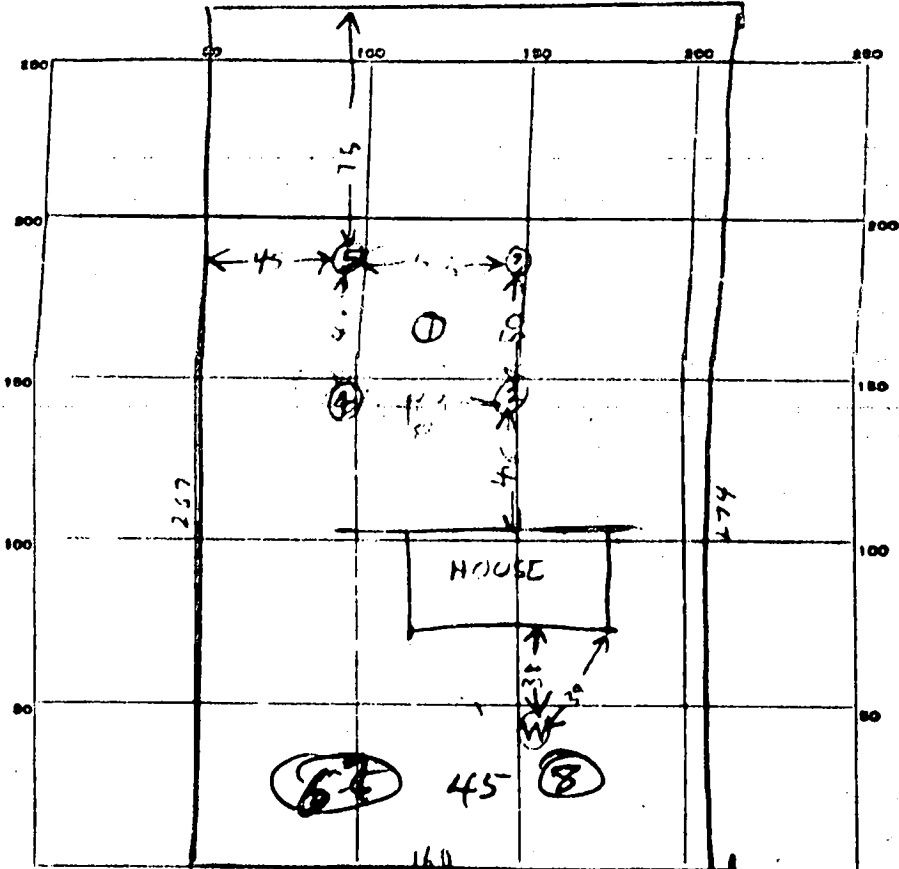

45
112
75
90-130
130
40
95

avg
1000m
12 Jan 67
A.H.

INDICATE NORTH - NAME ADJOINING ROADWAY AS BASE LINE.

LOCKRIDGE RD T.O. DEAN EXP

DATE	TEST NO.	DEPTH	PRE-WET		TEST - 1" DROP		TIME
			START	STOP	START	STOP	
2 Jan 67	1	2 1/2	2 08	2 10	2 10	2 15	5
17 Jan 67	2	3 1/2	2 16			2 27	6
17 Jan 67	3		2 22	2 27	CK FALL DOWN STOP		
17 Jan 67	3	3 1/2	2 42	3 24	S. W. S. pore		
17 Jan 67	4	3 1/2	2 44	2 52	2 52	3 00	8
17 Jan 67	5	3	2 44	2 53	2 53	3 04	11
12/24/64	6	9 1/2	6m				
	7	5	15m	Dur			
	8	8	5m				

5
6
9
11
13

had soil tests at 5/4

SOIL AUGER FINDING _____
 TESTED BY Raymond Hodges
 REMARKS _____

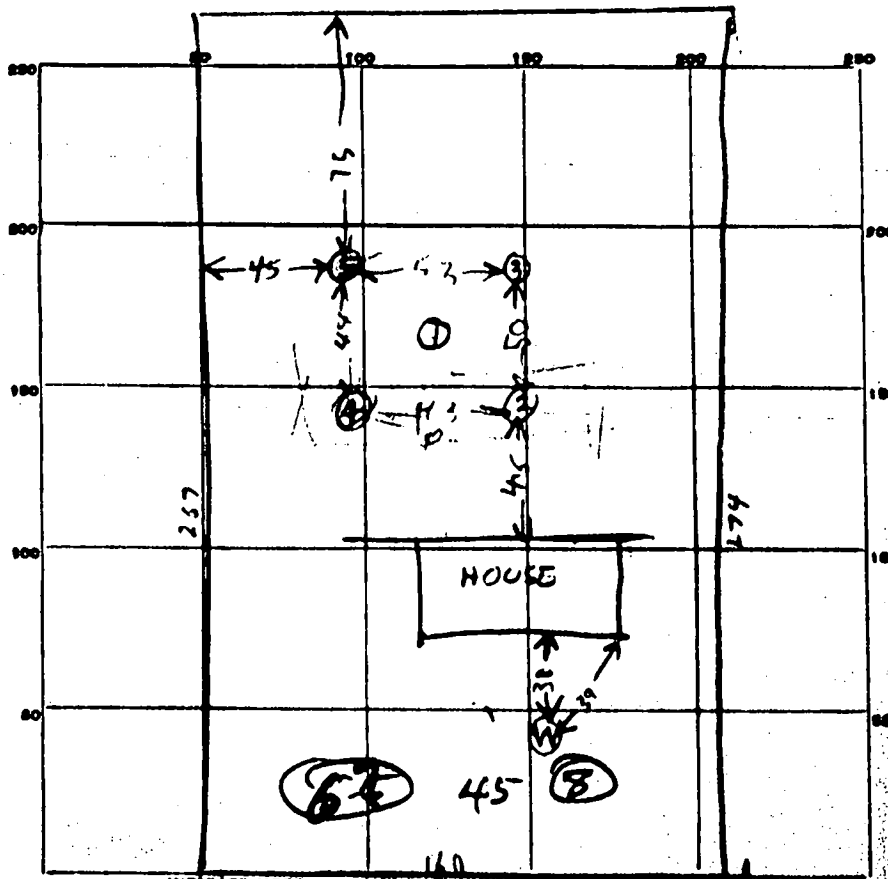

45
112
98
90-130
130
90
85

any
100 ft
17 Jan 67
A11

INDICATE NORTH. - NAME ADJOINING ROADWAY AS BASE LINE.

LOCKRIDGE RD TO TRAIL END

DATE	TEST NO.	DEPTH	PRE-WET		TEST - 1" DROP		TIME
			START	STOP	START	STOP	
17 Jan 67	1	2 1/2	208	210	210	215	5
17 Jan 67	2	3 1/2	216			227	6
17 Jan 67	3		225	240	STICK FELL DOWN START OVER		
17 Jan 67	3	3 1/2	242	304	little pipe		
17 Jan 67	4	3 1/2	244	252	252	300	8
17 Jan 67	5	3	249	253	253	304	11
12/24/64	6	9 1/2	6 in.				
	7	5	15 in. Dur				
	8	8	5 in.		Ind. pit status at 5/4		

5
6
9
11
1130
8

SOIL AUGER FINDING _____
 TESTED BY Raymond Hodges
 REMARKS _____